

LEGAL DESCRIPTION

COMMENCING AT THE SOUTHWEST CORNER OF THE NORTHWEST 1/4 OF THE SOUTHWEST 1/4 OF SECTION 3, TOWNSHIP 4 NORTH, RANGE 3 WEST OF THE 4TH P. M., IN GRANT COUNTY, WISCONSIN; THENCE NORTH, 110 FEET; THENCE EAST, 132 FEET; THENCE SOUTH, 110 FEET; THENCE WEST, 132 FEET TO THE PLACE OF BEGINNING. THE ABOVE DESCRIBED LAND ALSO BEING A PART OF LOT 1, IN BLOCK 39 OF THE SECOND ASSESSMENT PLAT OF THE CITY OF LANCASTER, GRANT COUNTY, WISCONSIN.

I, PAUL C. BRASHAW, A WISCONSIN REGISTERED LAND SURVEYOR, NO. S-1509, DO HEREBY CERTIFY THAT THE REQUEST OF MR. CLIFFORD CALEY, I HAVE MADE A SURVEY OF THE ABOVE DESCRIBED PROPERTY, AND THAT I HAVE FOUND AND/OR SET THE SURVEY MONUMENTS ALL AS SHOWN AND THAT THERE ARE NO APPARENT ENCROACHMENTS EXCEPT AS SHOWN ON THE ACCOMPANYING PLAT OF SURVEY.

Paul C. Brashaw
 PAUL C. BRASHAW
 WISCONSIN REGISTERED LAND SURVEYOR, NO. S-1509

West 1/4 Corner of Section 3
 T. 4 N., R. 3 W.

33.00'
 N. 89° 45' 00" E.

1324.12'
 1214.12'
 N. 01° 01' 04" W.

N. 01° 01' 04" W. 110.00'

33' Right-of-Way Line

N. 89° 45' 00" E. 132.00'

33.00'

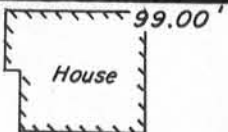

Second Assessment

Lot 1

Concrete Pad

33.00'

S. 89° 45' 00" W. 132.00'

Garage



Block 39

Plat to the City of Lancaster



Scale: 1" = 40'



S.W. Corner of the N.W. 1/4 of the S.W. 1/4 of Section 3, T. 4 N., R. 3 W.

1324.12'
 N. 01° 01' 04" W.

Surveyed for
 Mr. Clifford Caley



- Boundary of Property Surveyed
- 3/4" x 24" Iron Rebar Set
- Found Iron Rod
- *-* Existing Fence Line



Snyder Brashaw Engineering

1601 S. MARQUETTE RD.
 PRAIRIE DU CHIEN, WISCONSIN 53821
 TELEPHONE (608) 326-8448