

P. R. A. DIVISION	PROJECT	SHEET NO.	TOTAL SHEETS
WIS. 5N			

MAP FOR  
**SINCLAIR**  
 REFINING COMPANY  
 OF PROPERTY IN BOSCOBEL, GRANT COUNTY,  
 WISCONSIN.

DESCRIPTION:  
 Lot II in Block 34 of the Original Plat of the Village (now City) of  
 Boscobel, Grant County, Wisconsin, according to the recorded plat thereof.

- NOTES:
1. U.S.G.S. Bench Mark, Elev. 670 feet from which elevations shown on the map were run.
  2. Railroad map shows this bearing as S 46° 45' W. All other Lot corners and bearings are as shown and recorded.
  3. Commercial Row appears as an 18 foot strip of macadam lying 18 feet Northwesterly of and parallel to front of Lot II. The elevation of the crown here is 668.6 feet. This Street measures 40 feet in width rather than the recorded 66 feet.
  4. In the immediate vicinity of this map there are no storm, sanitary or combination sewers, gas mains, sidewalks or curbs.
  5. The entire frontage of said Lot II is used as unimproved entrance.
  6. Cement floor and foundation are generally flush with the ground & are the remains of a cement stove silo factory, now used as driving and loading ramp.
  7. An easement provides that the Madison Silo Company, or any subsequent owner of Lots 9 & 10 of said Block 34 may extend, improve & use the entire spur track.

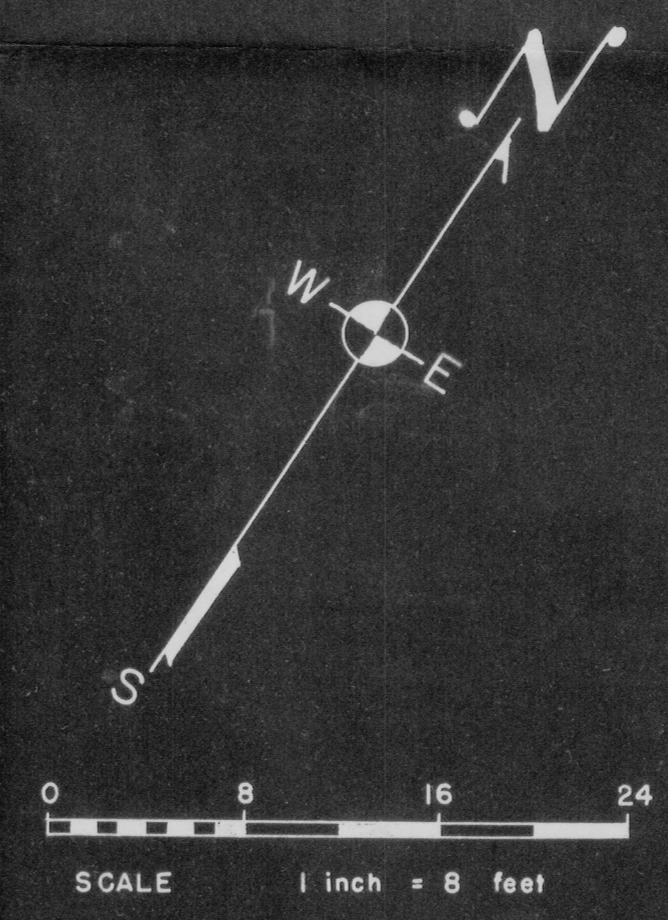
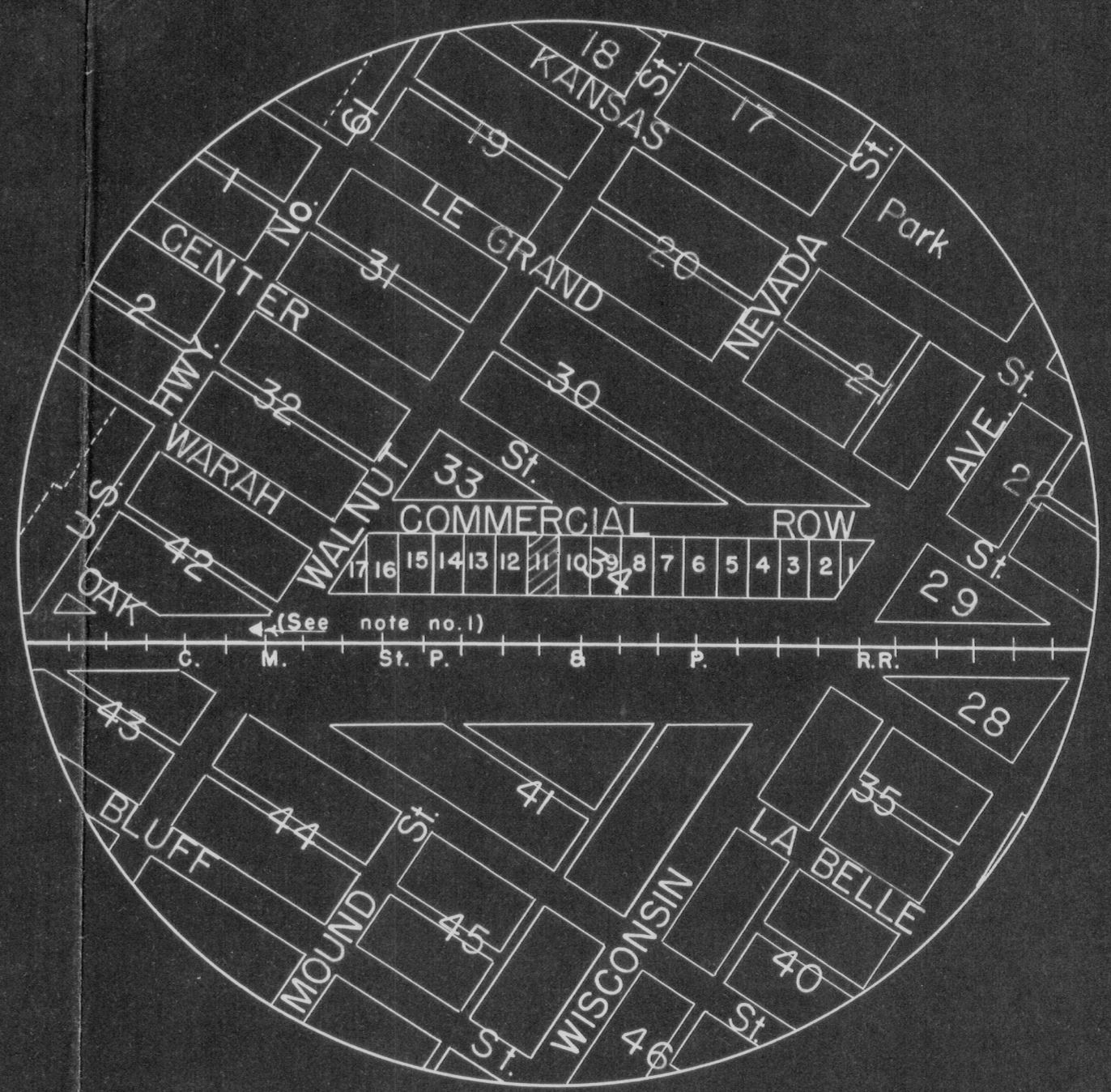

State of Wisconsin:  
 County of Grant:  
 I, H. D. Ralph, County Surveyor for Grant Co., Wis., Hereby Certify that I  
 Surveyed the above Site on Oct. 18 & 20, 1950, and that this plat is  
 a correct representation thereof.  
 H. D. Ralph  
 H. D. Ralph, Surveyor  
 for Grant Co., Wis.

