

Section 1 Township 4 North Range 2 West of 4th P. M.

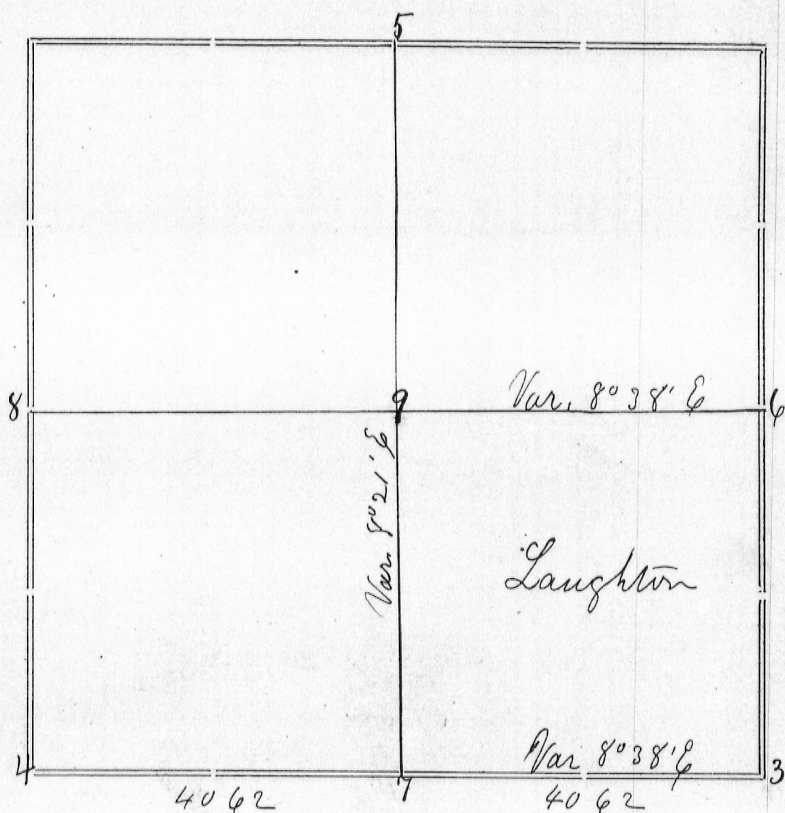

Corners	Bearing Trees	In. Dia.	Courses they Bear	Links Distant	REMARKS
3	White Oak	3	N 81 1/2 W	37 1/2	This corner is 148 North of No. 4 of Page 14
	"	3	S 77 1/2 W	23	
5					Corner temporarily placed 12 1/2 links West of 1/4 section corner South of Sec. 36 T 5 R 2 W of which the bearings are extant.
6					Corner found by one original bearing tree (NW)
7	White Oak Pin Oak	7 7	S 8 E N 78 W	7 7	Established by resurvey of whole section line. Placed equidistant between known section corners.
8	Br. Oak	7	N 71 1/4 W	56	Original bearing tree yet standing
4	Br. Oak "	3 3	N 31 1/2 W S 74 1/2 W	37 1/2 23	
<p>Surveyed November 29th 1876 For John Laughton</p>					

STATE OF WISCONSIN, } ss.
GRANT COUNTY,

CERTIFICATE OF SURVEY.

I, Joel Barber

County Surveyor in and for the County

and State aforesaid, do hereby certify that I have executed the Survey represented by the foregoing Plat and annexed Field Notes of Survey, in accordance with the State Laws and Instructions of the Commissioner of the General Land Office. Scale, 80 chains to 4 inches. The figures in red ink are the lengths of the lines as stated in the Field Notes of the Government Survey.

Declination of the Magnetic Meridian from the True Meridian East. The variation of needle adopted in establishing corners is 8° 30' East.

WITNESS my hand this 29th day of November A. D. 1877

CHAINMEN.

Joel Barber SURVEYOR.