

Survey of 6 1/2 sec 14 T 5 R 1 west made for Allen Gundlach Kemt and Muller Apr 5 + 6 1873 as shown in the following plat

Sec 14 T 5 of Range one west

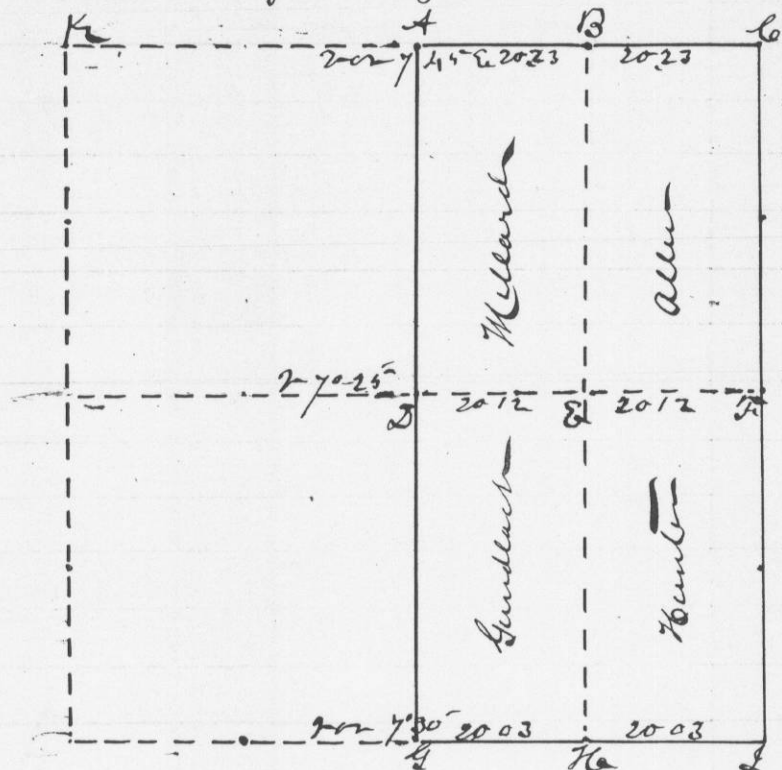

Reference

- at A the gr sec cor not being found - set equal distance from G & K
- at B set stone equal distance from A & G
- at G original mound - set stone
- at D center of sec established by survey No 230 -
- at E  
Bm 0 12 S 19 1/2 E 350 lks  
set station creek Lynn 12 S 62 1/2 W 70 lks
- at F original found
- at G original found
- at H stone in mound
- at I original stone in mound

Survey for Nelson others as shown in the following plat of Sec 11 Township 5 North Range 2 West March 1874 Stone is set as described below in Reference

Sec 11 T 5 R 2 W

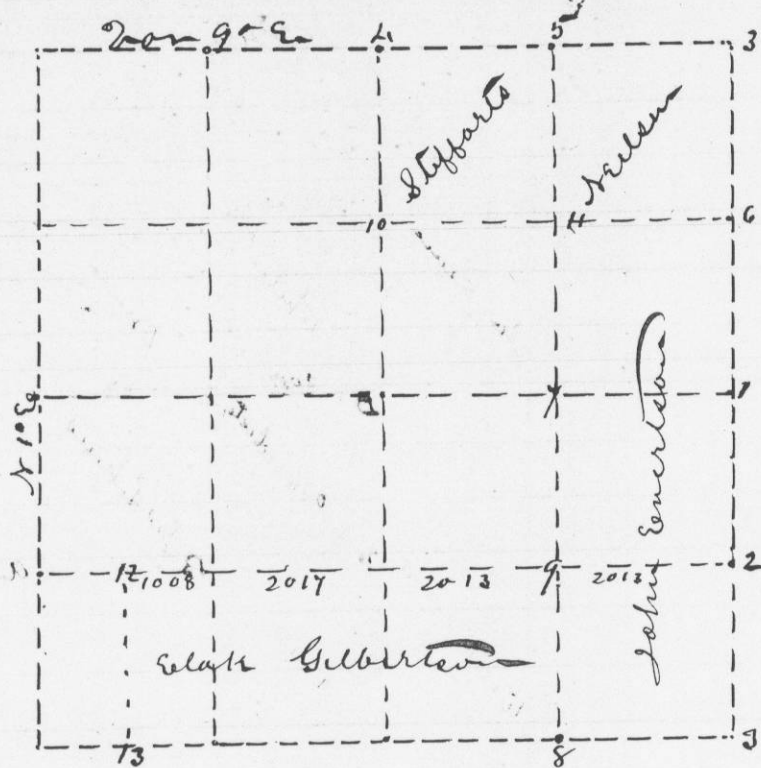

Reference

- at stone kind & size
  - 1 dim 5 x 10 x 26 inches
  - 2 sand 5 x 8 x 30
  - 3 Lime 4 x 12 x 20
  - 4 Granite 6 x 12 x 15
  - 5 Lime 4 x 5 x 14
  - 6 do 2 x 8 x 16
  - 7 Lime 3 x 5 x 14
  - 8 do 5 x 10 x 26
  - 9 do 5 x 10 x 27
  - 10 Lime 4 x 6 x 16
- attest