

Survey made for Me. S. Smith of a lot lying in the NW^{1/4} of Section 26 Township 3 North Range 5 West. M. S. Smith & myself chain July 27th 1854

Commencing at the N.E. corner of a lot belonging to Jacob Maulshagan Thence S 8° 20' E ran N 47° W 39 links - Thence S 53° 1/4 W 1.85 chains - Thence S 80° 1/4 E 1.98 chains to East line of said Maulshagan East line Thence N 8° W 120 chains to place of beginning containing 26 Acs.

I hereby certify that the above is a correct copy of the original notes of said survey as executed by Solomon Goodrich Deputy County Surveyor.

Attest

Recorded Sept 30th 1854.

John G. Selack
County Surveyor

Survey made on Section 16 Township 1 North of Range 5 West on the 25th & 26th of April 1854 by G. W. Hayden ^{Deputy} County Surveyor - of N^{1/2} of N E 1/4 & S E 1/4 of N E 1/4 - for John Duncan; of N E 1/4 of S E 1/4 - for James L. Taylor; of S W 1/4 of N E 1/4 & N W 1/4 of S E 1/4 for Alexander Taylor; George Duncan and James Duncan Chain Section 16 Township 1 North Range 5 West

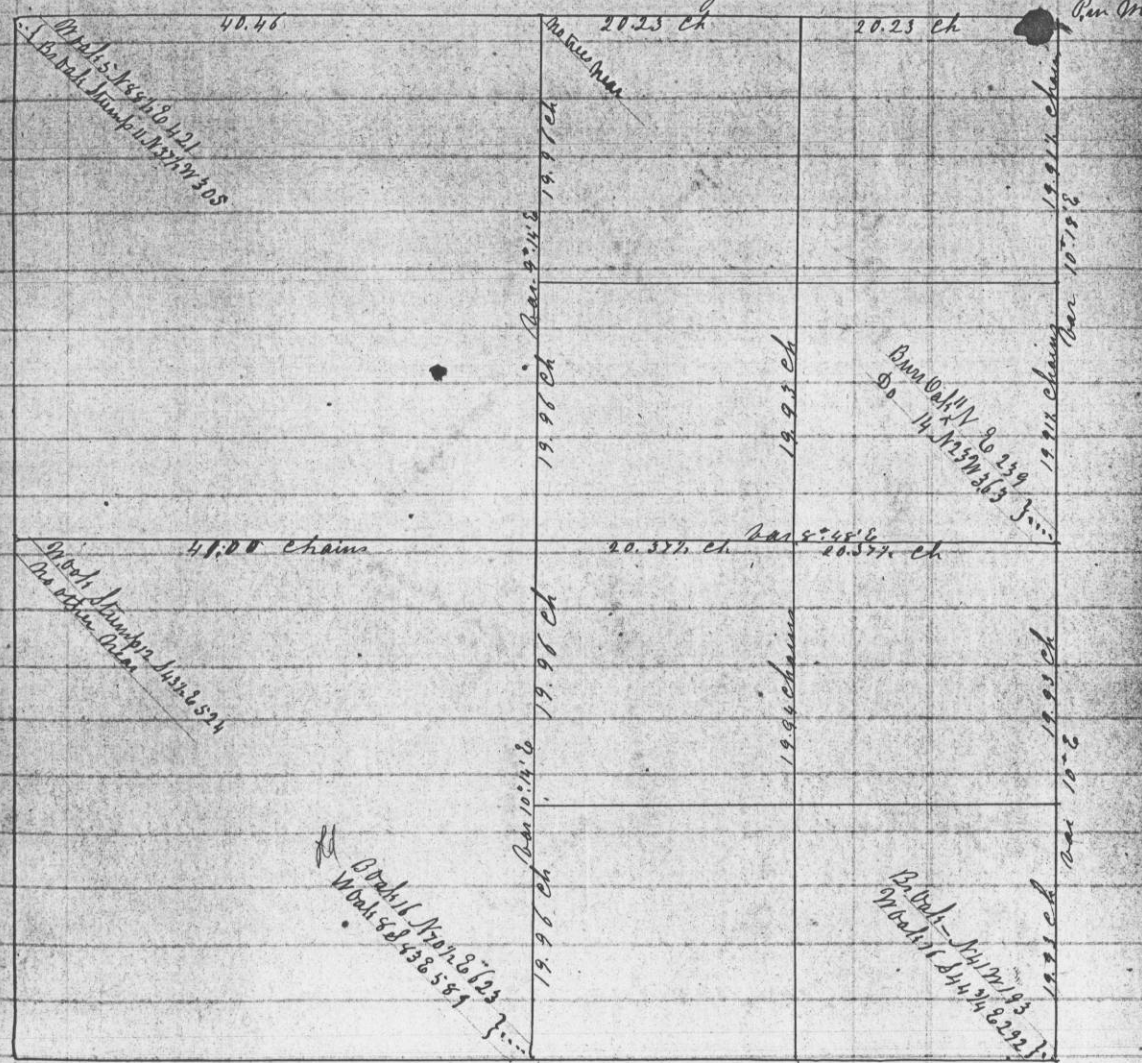

A true Record of notes of

Said Survey Attest
Recorded Sept 29th 1854. John G. Selack
County Surveyor