

Survey made Aug 11<sup>th</sup> 1854 by Solomon Goodrich Deputy County Surveyor for Henry Bradley and for Geog. W. Smith and Ephraim Smith (Benjamin Buzz & Sylvester Russell chainmen) on Section 4, Township 4 North of Range 5 West

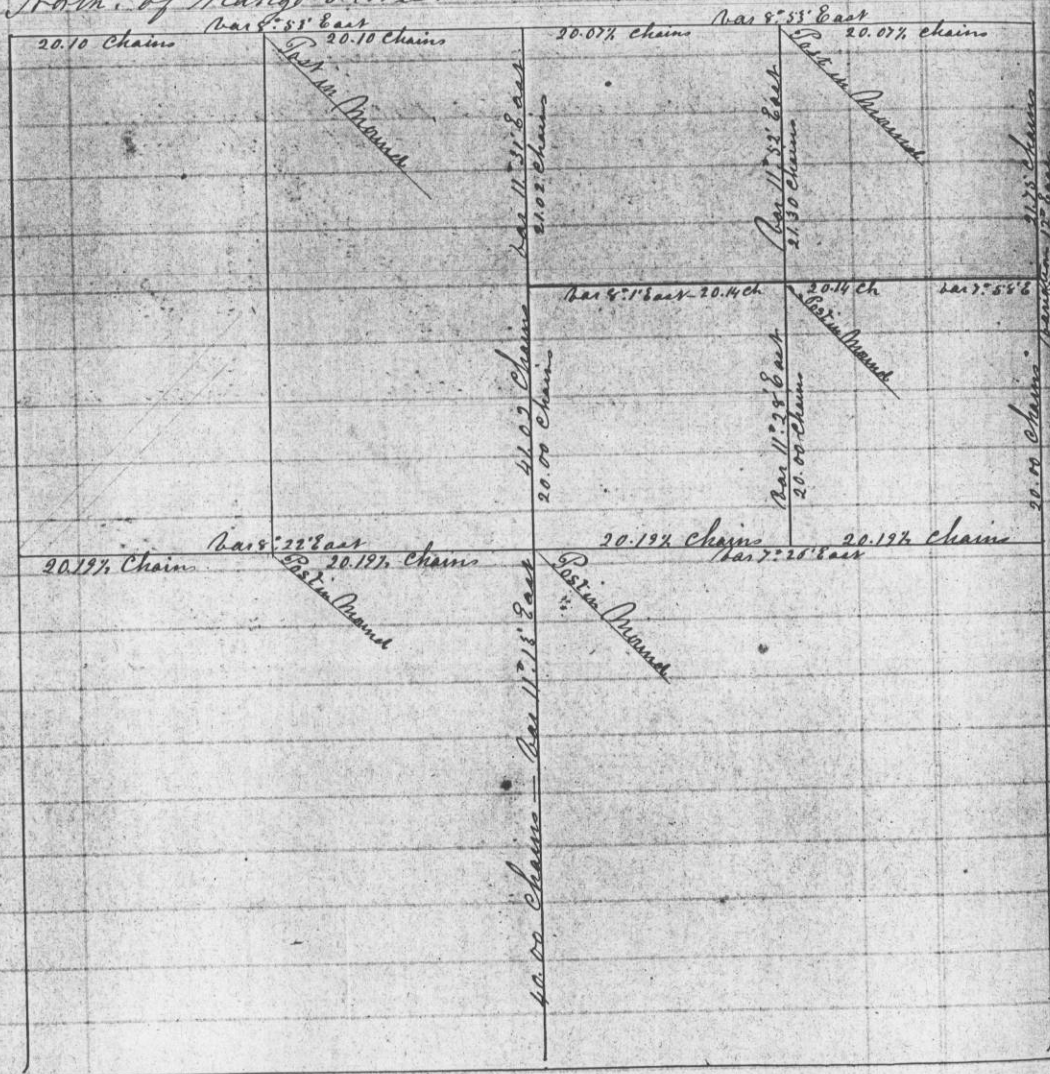

A True Record of said Survey

Recorded September 15<sup>th</sup> 1854

Attest

John G. Clark,  
County Surveyor

110 3 1/2

Survey made in Section 25, Township 3 North Range 4 West May 19<sup>th</sup> 1854 by Solomon Goodrich Deputy County Surveyor of the S.W. 1/4 of the N.E. 1/4 for J. Mearns, of the N.W. 1/4 of the N.E. 1/4 for Joseph Miner of the S.E. 1/4 for Richard E. Reynolds, of N.E. 1/4 of S.W. 1/4 of the N.W. 1/4 for M.C. Clement, Charles Clement & Thomas Fairall chainmen.

Section 25, Township 3 North of Range 5 West.

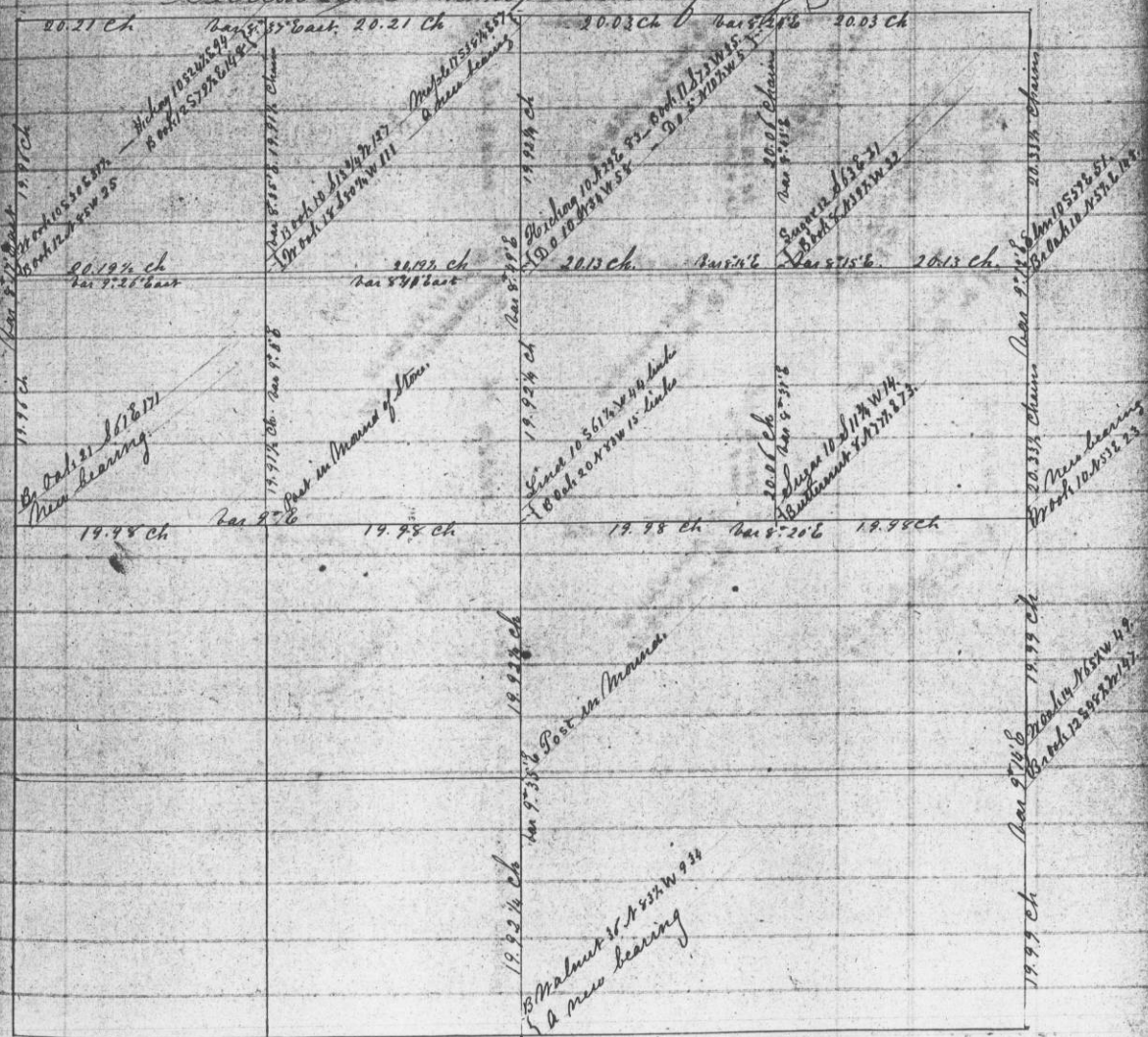

A true Record of said Survey.

Recorded Sep 21<sup>st</sup> 1854

Attest

John G. Clark,  
County Surveyor