

115 Survey of Road made for the Town of  
Caprille May 10<sup>th</sup> 1854 by Solomon Goodrich Deputy  
County Surveyor

Commencing at quarter Section corner  
on South Side of Section 23. Township 4 North. Range 6 West.  
Thence Variation 10° East ran.

- S 89° W 4.77 Br Oak 3 N 89° E 14 links
- N 44 1/2° W 25.88
- N 53° W 14.88 Br Oak 5 inches
- N 74° W 9.92
- S 74 1/2° W 13.00 W Oak 12 N 67° W 100
- S 71 1/4° W 7.50 Br Oak 12 S 67 1/2° E 60
- S 10° W 6.20 Elm 12
- S 38 1/4° W 11.50 Lime 12 N 28° W 42 or Br Oak 10 S 64 1/4° E 125
- S 31° E 10.00 Iron Wood 5 S 78 1/4° W 33 or Lime 12 N 14 1/4° W 12
- S 5 1/2° E 9.00
- S 4° E 9.50 Elm 6 East 36 or Thorn 5 N 26 1/2° W 19
- S 3 1/4° E 6.00 Br Oak 4 S 67° E 11
- S 34 1/2° W 11.50 Sugar 12 S 68 1/2° E 50
- S 5° W 25.87 Sugar 12 N 77 1/4° E 48 or Sugar 12 S 62° W 81
- S 28 1/4° E 13.34 Black Walnut 14
- S 74° E 13.67 Elm 10 S 81° W 40 or Br Oak 12 S 77 1/2° E 88
- S 21° E 13.31 Black Walnut 10 S 39 1/4° E 39 or Sugar 14 N 89 1/4° W 71
- S 9 1/4° W 7.40 Sugar 12 inches
- S 9 1/4° W 10.96 Hickory 10 S 57 1/2° W 139
- S 15 1/4° E 4.00 W Oak 12 S 19° E 114 or W Oak 8 N 39° E 70
- S 29° W 8.74 W Oak 5 N 63 1/2° W 74 W Oak 8 S 22 1/2° E 12
- S 63 1/4° W 778 Swamp Elm 30 inches
- S 68° W 20.08 to a yellow Birch 36 inches in Diameter on  
the River bank opposite Prairie La Porte and  
Southern terminus of said Road.

A true Record of notes of said Survey.

Recorded September 11<sup>th</sup> 1854. Attest John G. Clark

Survey made for Mr. J. Sargent by  
Solomon Goodrich Deputy County Surveyor May 13<sup>th</sup> 1854 of  
the S. E. 1/4 of Section 31. Township 5 North Range 5 West. John  
Barnett & Scott Barnett chainmen duly sworn.

Section 31. Township 5 North. Range 5 West.

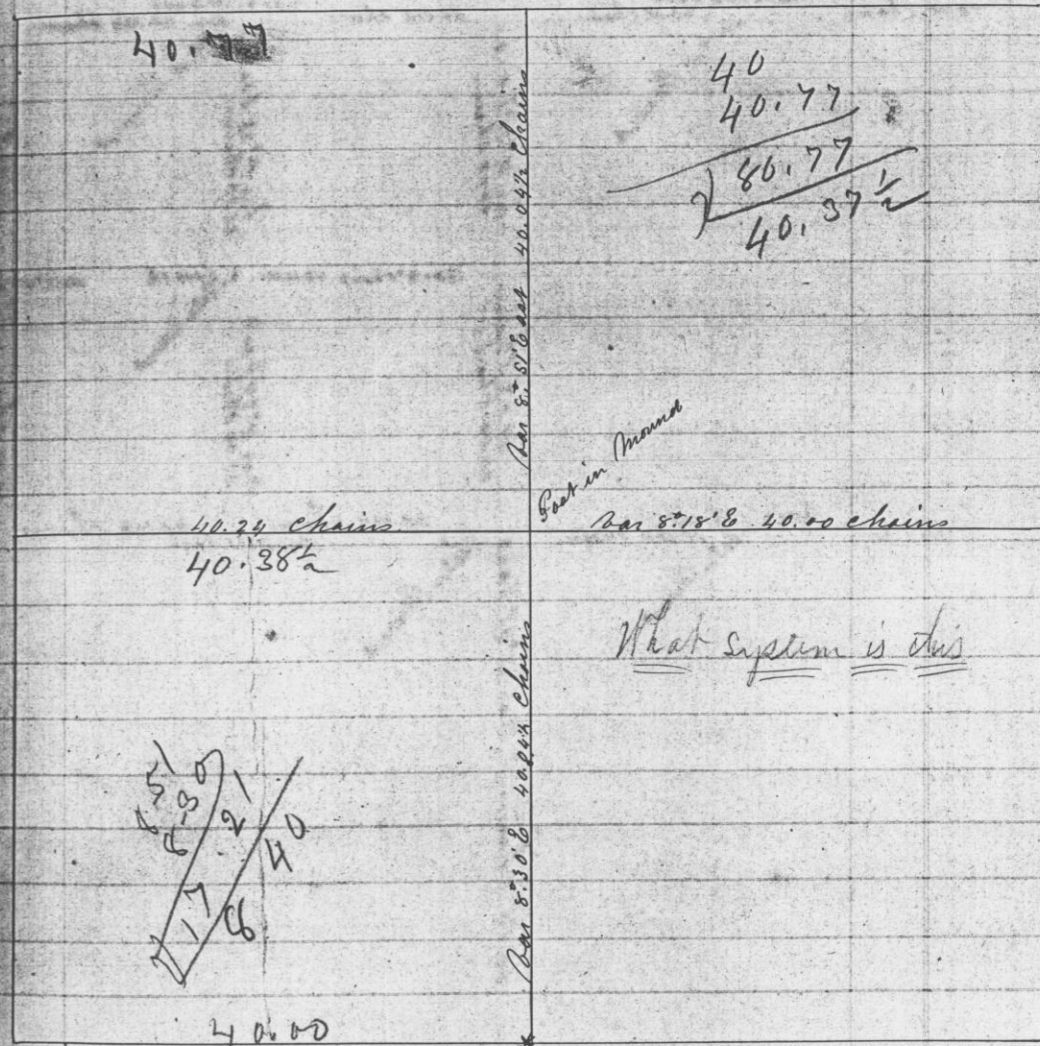

A true Record of the plot and notes  
of said Survey.

Attest  
Recorded Sep 11<sup>th</sup> 1854. John G. Clark.  
County Surveyor.