

having been partially destroyed took new Bearings
 Book 10 S 86° E 128 links. Book 8 S 87 1/2° W 72 links
 Then corrected South 40.34 1/2 chains & set post for 1/4 Sec
 tion corner between Sections 17 & 18. Thence ran random
 East at a variation of 8° 30' E. At 20 chains set tem-
 porary 1/8 post. at 40 chains set temporary 1/4 Sec-
 tion post. at 60 set temporary 1/8 post. at 79.92
 chains intersect 28 links ^{North} ~~South~~ of 1/4 Section post
 between Sections 16 & 17.

Then from 1/4 Section post between Sections 17 & 20
 run random North N 11° 15' E intersect North boundary
 of Section 17. 1 link West of 1/4 Section Corner.

Then from Corner of Sections 7, 8, 17 & 18 run random
 East along North boundary of Section 17 at a variation
 of 8° 30' East at 40.73 chains intersect 20 links North of
 1/4 Section corner. then continued East & at 87.50
 intersect Meridian Section line 40 links North
 of post corner to Sections 8, 9, 16 & 17. Thence corrected
 West 20.38 1/2 & set 1/8 post from which bears a ^{Section} Wood 5 S 60 1/2° W
 135 links. Then corrected West from 1/4 post set 8° 31' W
 20.36 1/2 chains & set 1/8 post. Then corrected & set post

Centre of 17
 4-4

for 1/4 Section Corner in Centre of said Section 17, from
 which bears (Wood 5) N 36° W 35 links. (Wood 6) S 14 1/2° W 29
 links. Making East 1/2 of said West line through the centre
 40.44 chains & West 1/2 of said line 39.48 chains. Then
 from centre post corrected West 19.74 chains and
 set 1/8 post. Then from centre post corrected East
 20.22 chains & set 1/8 post from which bears Book
 6 N 82° W 130 links.

A true Record of the notes of said
 Survey.

John G. Clark
 Deputy County Surveyor

NO. 10
 Survey made for Mass. Collaroy of Lot 14
 the S. E. 1/4 of Section 14 of Township 3 North of
 Range 3 West of the 4th Principal Meridian.
 July 15th 1853 (Per 8° 41' East)

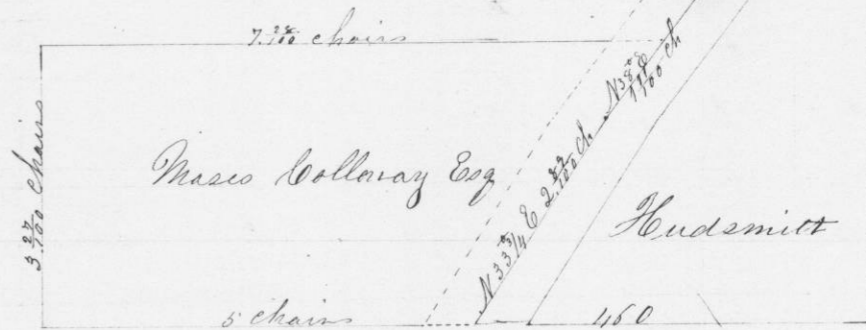

Commencing at S. E. Corner of said Section
 14 thence West 4 1/2 chains along South side of
 Hudsmitts Lot to Centre of Road & to S. E. corner
 of Lot referred to above. Thence West on Section
 Line 3 chains. Thence North 3 2/3 chains. Thence
 East 7 2/3 chains to Centre of Road. Thence S 38° W
 1 1/2 chains. Thence S 33 3/4 W 2.89 chains to place of
 beginning containing two acres

A true Record of the notes of said
 Survey
 John G. Clark
 Deputy County Surveyor

N 11
 Survey made by John G. Clark for J. C. Glin
 July 6th 1853 of the N W 1/4 of S. W 1/4 of Section 28.
 Township 4 North of Range 3 West. (W. B. Norman
 & Allen S. Heath Chairman duly sworn.

Beginning at 1/4 post on line bet Sections
 28 & 33 ran thence North Per 9° 30' East at 40
 chains set temporary 1/4 post. intersect 27 links
 East of 1/4 post on line bet Sections 28 & 21
 Then ran through centre of Section from East to West
 from intersection of true North & South line