

West of N & corner of said Section 22. Run south
 on 8.54' E through center of NW 1/4 of said section.
 Then crossed said 1/4 section from East to West as
 required by law and set post at the S & E corner
 of said North 1/2 of the NW 1/4 of NW 1/4 of said section 22.
 Variation of East & West line through ^{the center of} NW 1/4 8.38' E?
 Variation of North & South line through NW 1/4 8.54' E.

A true record and plat of said survey.
 John G. Clark
 Deputy County Surveyor

center post set by G. R. Stuntz from which lead
 a Book 5 N 30 W 220 links. Book 6 N 31 W 200 links
 the latter bearing taken by myself. Then from said
 center post run North on 9.40' E at 20 ^{chain} set tempo-
 rary stake at 40.08 ^{chains} intersect at 1/4 post bet Sec-
 tions 21 & 28. Hence corrected South 20.04 chains & set post
 & stone for 1/8 corner. Hence East on 8.57' E 40.54 chains
 to 1/8 post at N & E corner of said tract of land

A true record and plat of said survey
 John G. Clark
 Deputy County Surveyor

No 8
 Record of Survey made June 11th 1853 of
 the South 1/2 of the N. E. 1/4 of Section 28 Township
 4 North Range 5 West for M. A. Brenner and by
 John G. Clark.

N E 1/4 of Sec 28 Town 4 North Range 5 W

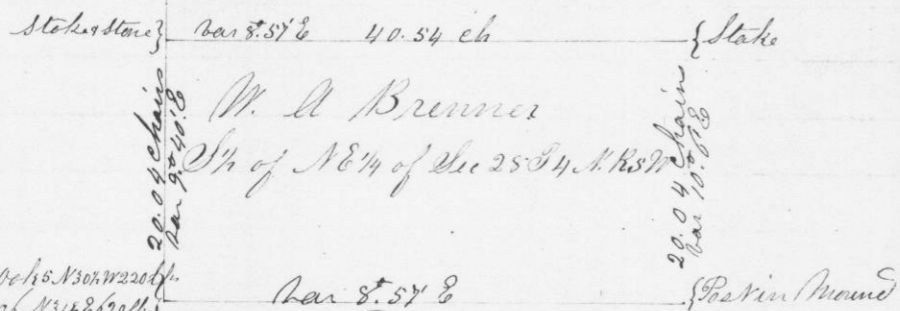

Books N 30 W 220 links
 Do. N 31 W 200 links
 Charles Williamson and William Johnson
 Chainmen were duly sworn. Beginning at N & E
 corner of said Section 28 ^{run} South on 10.36' E at
 40.08 intersect at 28 links East of 1/4 post bet Sec-
 tions 27 & 28. Corrected back north 20.04 chains & set
 1/8 post. Then from said 1/4 post between sections
 27 & 28 run West on 10.36' E ^{intersect} 10.9 chains South of

No 9
 Record of Survey made June 10th & 11th 1853 by John
 G. Clark of the NW 1/4 of NW 1/4 of Section 17 T. 4 N. R. 4 W. for
 James & Henry Wayne, and of the E 1/2 of the NW 1/4 of same
 section for Joseph McDonald and of the NW 1/4 of the
 N E 1/4 of same section for James Brown.
 Charles McDonald and James George duly sworn as chain-
 men.

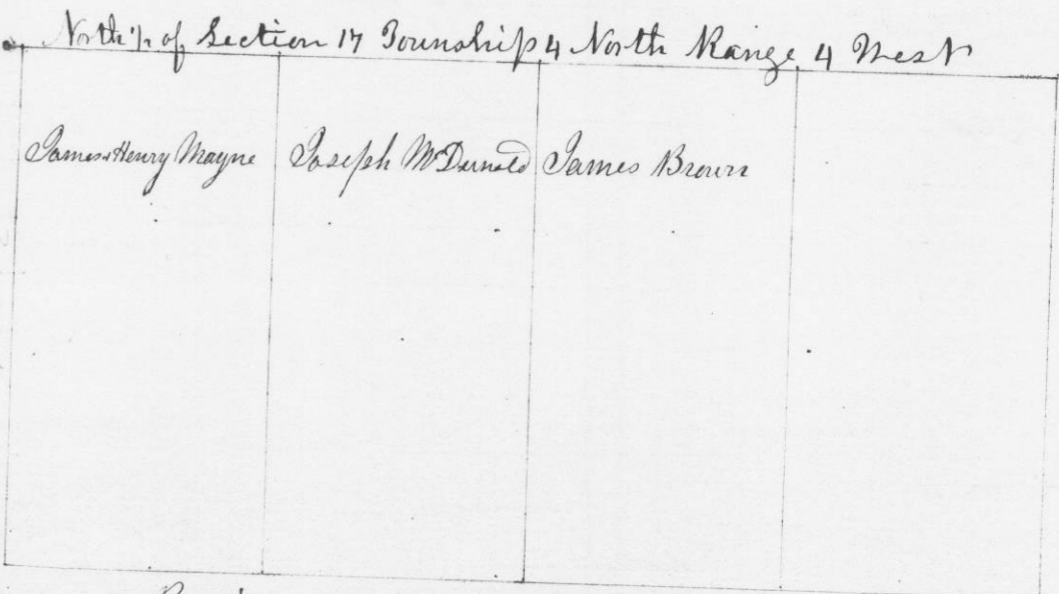

Beginning at corner of sections 17, 18, 19 & 20,
 run thence North at a variation 10' E. at 40 chains set
 temporary 1/4 section post at 80.69 chains intersect 146
 links East of corner to sections 7, 8, 17 & 18. Old bearings