

established the center point as required by law
 Beginning at center point of said section 21
 Marked by stake & stone thence East to $\frac{1}{4}$
 Past 40.33 chains ran $8^{\circ} 16'$ East. Thence curved
 West & at 20.16 $\frac{1}{2}$ chains set $\frac{1}{8}$ Past the SW corner
 of the $\frac{1}{4}$ of the $\frac{1}{4}$ of the N.E. $\frac{1}{4}$ Sec. 21. Then from
 the $\frac{1}{4}$ Past on line Bet Sec. 21 & 22 marked by stake
 North ran $8^{\circ} 56'$ & 20.16 $\frac{1}{2}$ chains to $\frac{1}{8}$ past thence
 continued North & at 40.32 $\frac{1}{2}$ intersect at spot
 corner to sections 15.16. 21 & 22. marked by stake
 Thence West 20.11 $\frac{1}{2}$ chains to $\frac{1}{8}$ past ran $8^{\circ} 10'$
 marked by a stake.

Then Beginning at $\frac{1}{4}$ Past on West side of Section
 22 ran East to center point previously established as
 required by law. Then curved West 20.30 chains
 & set $\frac{1}{8}$ past the S.E. corner of the $\frac{1}{4}$ of the $\frac{1}{4}$ of
 of the NW $\frac{1}{4}$ of Section 22. Then North from
 center point ran $8^{\circ} 45'$ & at 40.00 chains inter-
 sect at $\frac{1}{4}$ Past. Curved South 20.10 chains and set
 at run there West across North West $\frac{1}{4}$ of Sec. 22
 Thence from corner of sections 15.16. 21 & 22 ran East
 ran $9^{\circ} 5'$ & at 40.57 chains intersect at $\frac{1}{4}$ Past
 then back West 20.28 $\frac{1}{2}$ chains thence South
 through the center of NW $\frac{1}{4}$ ran $8^{\circ} 54'$ & at crossing
 of two lines set past center of NW $\frac{1}{4}$ of Section 22

A true Record of the notes of said
 Survey
 John G. Clark
 Deputy County Surveyor

Record of Survey made June 9th 1853 by John
 G. Clark for Henry S. Young of the NW of the NW of the
 NW $\frac{1}{4}$ & the E $\frac{1}{2}$ of the NW $\frac{1}{4}$ & the NW of the N.E. $\frac{1}{4}$ of
 Section 22 of Township 5 North of Range 5 West
 North $\frac{1}{2}$ of Section 22 of Township 5 North Range 5 West
 NW of NW of NW $\frac{1}{4}$ 40.55 chains
 NW of NW of NW $\frac{1}{4}$ 99 chains
 Sec. 22 S. 5. N. R. 5 W.

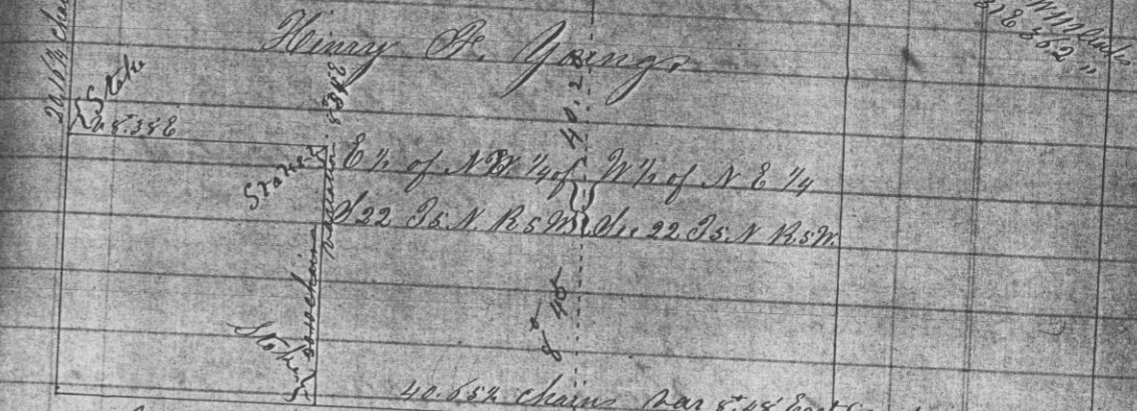

Chainsmen Henry S. Young & J. M. Boyer were duly sworn
 First run across the section twice as required by law
 & found the center.
 Corrected bar of East & West line through the center
 $8^{\circ} 48'$. Corrected bar of North & South line through
 the center of section $8^{\circ} 45'$ Length of East $\frac{1}{2}$ of East
 & West line through the center 40.21 chains of West $\frac{1}{2}$
 Length of NW of North & South line through the center of section 40.21 chains
 40.00 chains. Then from center point East 20.55 $\frac{1}{2}$ chains
 and set $\frac{1}{8}$ past from which see Book 10 N. 15 W. 50 links
 Book 10 N. 33 E. 11 links. Then West from center point
 20.30 chains & set $\frac{1}{8}$ past. Then from $\frac{1}{4}$ past on West
 side of Section 22 North ran $8^{\circ} 56'$ & at 40.32 $\frac{1}{2}$ intersect
 at corner to sections 15.16. 21 & 22. then curved South
 20.10 $\frac{1}{2}$ chains & set $\frac{1}{8}$ past. Then from corner of
 sections 15.16. 21 & 22 East ran 9° East at 40.57 intersect
 NW South of $\frac{1}{4}$ Past Bet 15 & 22 at 81.14 intersect 22
 links South of corner to sections 14.15. 22 & 25. Then
 corrected West & at 20.28 $\frac{1}{2}$ chains set $\frac{1}{8}$ Past from
 which see Book 8 N. 8 W. 11 links. Book 10 S. 51 E.
 362 links. Thence continued West & from a point 67.85 chains