

line North ran 8° East & intersect 17 links West of 1/4 Corner. Then corrected South side center past as required by Law at the crossing of the true lines. A true record of said survey.

John G. Clark  
Deputy County Surveyor

No. 3.

Record of Survey made for Isaac McWilliams of the S. E. 1/4 of Section 21 Township 5 North Range 5 West June the 8<sup>th</sup> & 9<sup>th</sup> 1853 By John G. Clark the Chairman Isaac McWilliams & Frederick M. Boyer having been duly sworn. Beginning at 1/4 corner on line between sections 21 & 28 thence ran East at bar of 8° 25' at 40.55 chains intersect at corner to sections 21 & 22 & 28. Thence North 40.32 1/2 to 1/4 section past bar 8° 52' East. Thence West to center past bar 8° 16' East established by running twice through the section as required by law. Center marked by stake and stone. Thence South ran 8° 53' to place of beginning.

A true Record of said Survey  
John G. Clark  
Deputy County Surveyor

5A

No. 4.

Record of Survey of the S. 1/4 of N. W. 1/4 of Section 21 Township 5 North Range 5 West for Daniel Kingley June 9<sup>th</sup> 1853 by John G. Clark. Beginning at section corner the corner to sections 16, 17, 20 & 21 thence South ran 8° 53' at 40.42 chains intersect at 1/4 past. The North West cor. of said tract of land thence corrected back at 20.21 chains set 1/8 past at N West corner of

said tract. Thence from the S.W. corner of said tract East with the claim to center of section previously established by me as required by law marked by stake & stone ran 8° 16' East. Thence North ran 8° 53' East at 40.42 chains intersect at 1/4 past. Thence corrected South & at 20.21 set 1/8 East  
N. W. 1/4 S. 21 T. 5. N. R. 5. W.

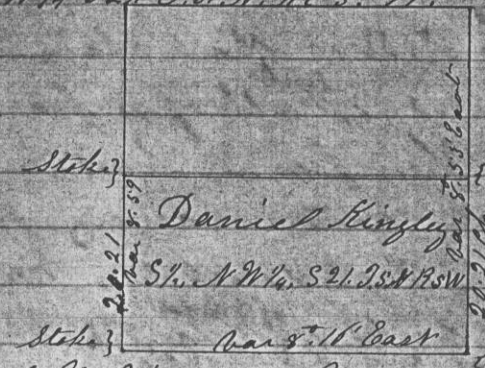

Isaac McWilliams & F. M. Boyer Chairman having been duly sworn  
A true Record & Diagram of said Survey  
John G. Clark  
Deputy County Surveyor

No. 5.

Record of Survey made for Jeremiah Gaudin the North half of the North West Quarter & the West half of the North East Quarter of Section 21 and the East half of the North East Quarter of Section 22 Township 5 North Range 5 West. F. M. Boyer & Isaac

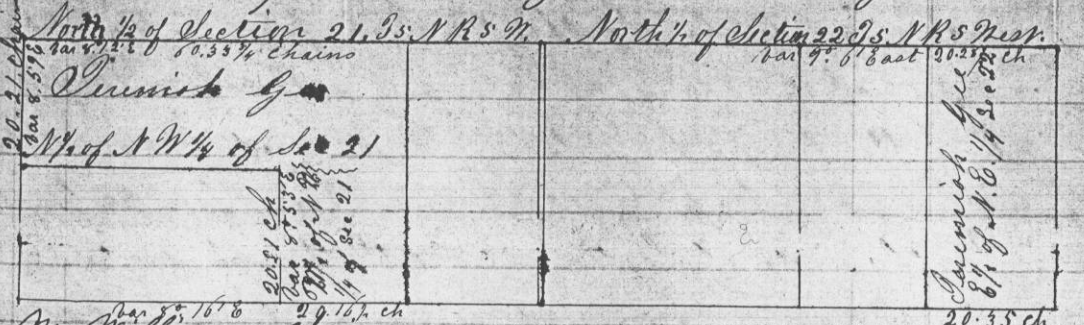

McWilliams Chairman duly sworn  
Beginning at corner of sections 15, 16, 21 & 22 thence ran a random West ran 8° 45' E at 80.45 chains intersect 1/8 links South of corner to sections 16, 17, 20 & 21. Thence