

No. 1.

Survey made ^{by John G. Clark} for John A. Eagles & Mrs Eddy of line between the East & West halves of the S. W. 1/4 of Section 7 Township 3 North Range 2 West. Beginning at 1/4 Past at South end of said line thence ^{ran} north ^{ran} 10° 30' without chaining, at North end intersect East & West line 35 links East of Post. One of old bearings having been entirely destroyed & nothing but the stump of the other left from which true course was found. Took new Bearings { White Elm 16 S 74 E 133

{ White Elm 16 S 39 W 78.

Then corrected South to place of beginning

A true record of the Notes of said Survey
John G. Clark.

Deputy County Surveyor

No. 2.

Survey made for James Murphy of S. W. 1/4 of Section 21 Township 5 North Range 5 West. by John G. Clark June 8th 1853.

S. W. 1/4 Sec. 21 T. 5 R. 5

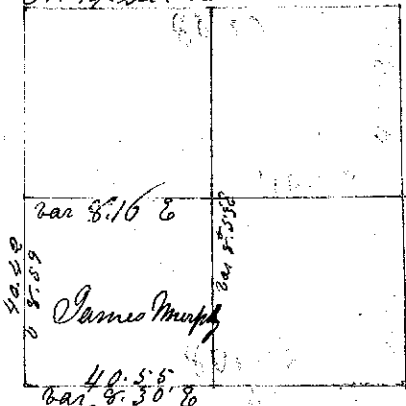

Beginning at Corner of Sections 20. 21. 28 & 29
ran thence East ^{ran} 8° 30' East at 40.55 chains intersect
at 1/4 Past. Thence continued East at 81.10 chains set tem

at 80.34 chains found remnant of old stake remaining.

Thence North ^{ran} 9° East ^{ran} 40.55 chains set temporary 1/4
Past at 80. ^{chain} set temporary section corner. Then continued
North 40.89 chains intersect 8 links West of 1/4 corner
at 80.14 1/2 intersect 1 link West of corner to sections
9 & 10. 15 & 16. then corrected South & set temporary
past at 80.51 chains. ^{a point 15 links north of} Thence East from corner of sections
15. 16. 21 & 22 ^{ran} 9° East at 40.57 chains intersect 3 links
North of 1/4 Past at 81.24 intersect 8 links South of
corner to sections 14 & 15. 22 & 23. Thence corrected West and
at 81.14 chains set temporary section corner. Then
finding no marks of old stake or mound set corner
to sections 21. 22. 15 & 16. set these two temporary stakes
the one obtained by running the line between sections
15 & 16 & the other by running the line Bet sec 15 & 22.
which were 6 links apart. Thence corrected South
& set 1/4 Past at 40.32 1/2 chains.

Then ^{from} from corner of sections 15. 16. 21 & 22. ^{ran} 8° 45' 6"
at 40.00 chains ^{1/4 Past land} set temporary past
corner to sections 16. 17. 20 &
Then from corner of sections. 20. 21. 28 & 29 North ^{ran} 9° East
at 40.00 chains set temporary 1/4 Past no vestige of old
one remaining. at 80.00 set temporary corner to sections
16. 17. 20 & 21. at 120. set temporary 1/4 Past set sections 16 & 17
at 160.68 chains intersect 5 links West of corner to
sections 8. 9. 16 & 17. Thence corrected South 80.84 chains
& set corner to sections 20. 21 & 16 & 17. Thence corrected
South 40.42 chains & set 1/4 Past. Then continued
line Bet sections 16 & 21 West and at 80.45 chains
intersect 78 links South of corner to sections 16. 17. 20 & 22.

Thence corrected East 40.42 1/2 & set 1/4 Past.

