

No. 797

April 26<sup>th</sup> 1855

Survey for Benjamin Bradford - the North west quarter of Section 33 & S.W. fractional quarter of Sec 32 Township 3 N. Range 4 West - as shown in the following plat viz: T. 3 N. R. 4 W.



- Bearings  
 1 N. 89° 55' W. 40.26 chs  
 2 S. 77 1/2° W. 64 1/2  
 3 N. 89° 50' W. 2

Overtour & Underway

No. 798

April 26<sup>th</sup> 1855

Survey for Joel Spess the South half of the South East quarter of Section 29 Township 3 North Range 4 West as shown in the following Plat to wit: Sec. 29 T. 3 N. R. 4 W.

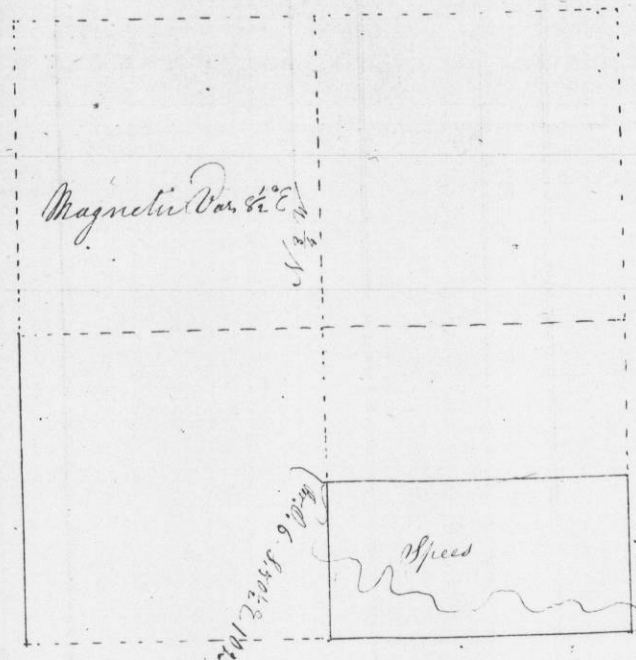

Arlio