

Survey made for Jarrett Spencer of the West half of the S.E. 1/4 of the N.E. 1/4 of the S.W. 1/4 of Sec - N^o 32-35-R-3 west of the 4th Principal Meridian
S 1/2 of Sec 32-35-R-3 -
D 20.09chs 20.09chs - 6

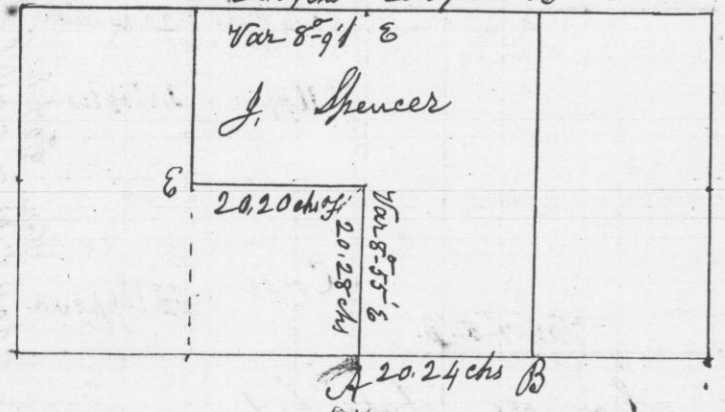

Commencing at 1/4 Post on west side of Section - Thence East through section to 1/4 Post on east side, 80.36 chains true Var, 8° 09' E - Thence from 1/4 Post on South side to 1/4 Post on north side of section. Variation 8° 55' E - 40.56 chains to Centre - intersected at 1/4 post on North side of section corrected & set 1/4 post in Centre of section at 1 - Bearings B. O. 5 N 3 1/2 W 57 links = R. O. 8 S 23 1/3 E 97 links - Thence East 20.09 links South 20.28 links to 1/16 post in cornfield, set post F, without bearings - Thence from 1/4 post A (original) East to Section corner 40.48 links, corrected, & set 1/8 post B Br. O. 9 S 34 1/2 E 147 links = B. O. 5 N 74 W 110 links - North without chaining, corrected & set 1/8 post C = R. O. 15 S 89 W 47 links R. O. 18 S 31 E 1.35 links - Thence west from Centre 20.09 links corrected & set 1/8 post D in prairie bottom on north side of Grant River - no bearings - Thence South without chaining to 1/8 post, Thence North from Section corner to 1/4 post on west side of section - Thence East to 1/16 post E, corrected back and set 1/16 post E - Br. O. 12 S 25 1/3 W 190 links -

I hereby certify that the above is a true representation of said Survey made August 24th 1849

Geo. R. Stunby -
District Surveyor
G. C. Wis -
for Stephen Mahood Deputy

Survey made for Morris Murphy of the W 1/2 of the N.W. 1/4 of Section 11-34-R-3 west of the 4th Principal Meridian - Sept 7th 1849
N 1/2 of Sec - 11-34-R-3 -
20.06chs

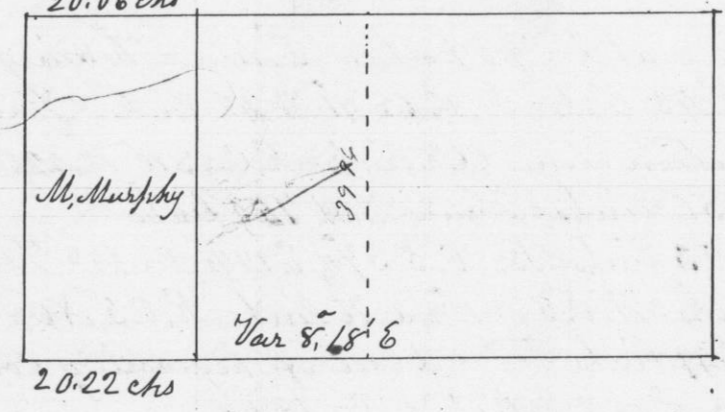

Commencing at 1/4 post on west side - Thence East 80.32 links to 1/4 post on East side of section. Var 9° E, intersected 102 links North of 1/4 post - Thence North from 1/4 post on South side, to 1/4 post on north side of section - Var 10° E intersected 88 links west of 1/4 post 39.96 links from Centre Thence West to 1/8 post - (see N^o 564) bearings
W. O. 18 N 36 W 98 links = R. O. 6 S 74 1/2 E 120 links - Thence South without chaining. Corrected & set 1/8 post -
W. O. 11 S 22 1/4 W 64 1/2 links = Br. O. 16 N 86 1/2 E 58 1/2 links -

I hereby certify that the above is a true plot & correct minutes of Survey

Geo. R. Stunby -
District Surveyor
G. C. Wis -
for Stephen Mahood
Deputy