

No 599

Survey made for Miles Hollingsworth of the Sp & Samuel Alex of the N 1/2 of the S 1/4 of the S 1/4 of Section No 20 - T4 - R4 of the 4th Principal Meridian July 28th 1849

1/2 of Section 20 - T4 - R4

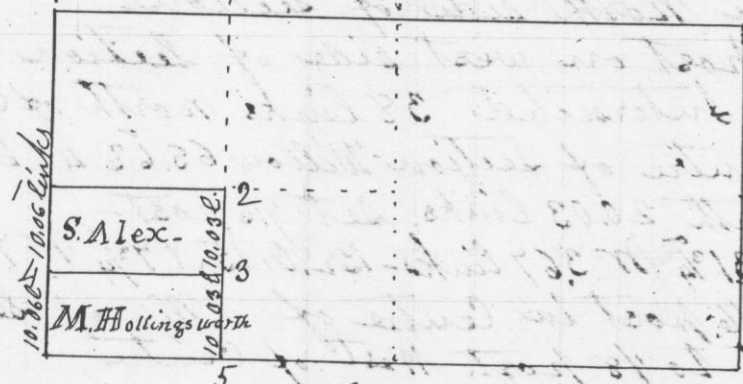

Scale 20 chains to the inch

Corners Established

- 1 W. O. 20 N 15 W 53 links } 4 W. O. 4 S. 20 E 61 links }  
no other } Y. O. 63 74 E 88 " }
- 2 Post - - - - - }
- 3 R. O. 8 N 72 W 1.3 1/2 links } 5 W. O. 22 S 66 W 58 " }
- W. O. 4 N 10 W 92 " }

I hereby certify that the above is a true plot & correct record of survey

Geo. R. Stuntz  
District Surveyor G. C. M.  
Dr Stephen Mahood  
Deputy

No 600

Survey made for James Coyle & Henry Uppena in the N 1/4 of Section 23, T3 - R3 west of the 4th Principal Meridian August 17th 1849  
N 1/2 of Sec - 23 - T3 - R3 -

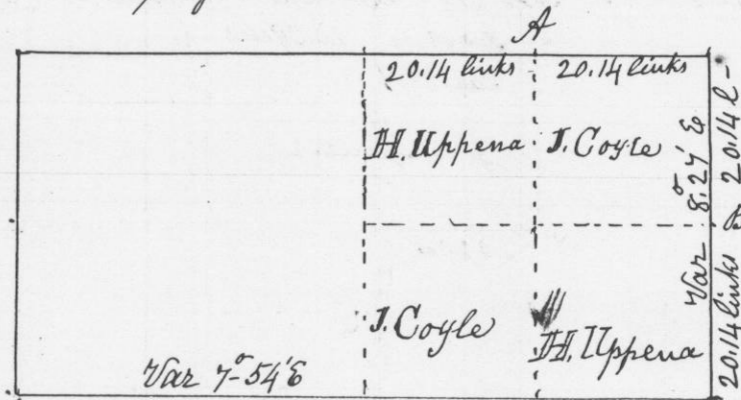

Corners Established

- A. W. O. 32 S 2 1/4 E 77 1/2 links = W. O. 18 S 72 1/2 W 76 links }
  - B. R. O. 4 N 80 W 22 1/2 links = R. O. 4 S 35 1/3 W 29 links - }
- Commenced at 1/4 post on East side of Section thence West to 1/4 Post on west side of Section Var 8 E intersected 14 links South of 1/4 post - corrected line back to East side of Section

I hereby certify that the above is a true record of survey so far as completed

Geo. R. Stuntz  
District Surveyor  
G. C. M.  
Dr Stephen Mahood  
Deputy