

Survey made for Charles H. Hinman and Charles P. Wilson to divide the North West quarter of the South East quarter and the South West quarter of the North East quarter into two Equal parts by running through the center of those tracts of land a North and South line as shown by the following diagram

Plot of Sec No. 3 T 3 Range 2 West

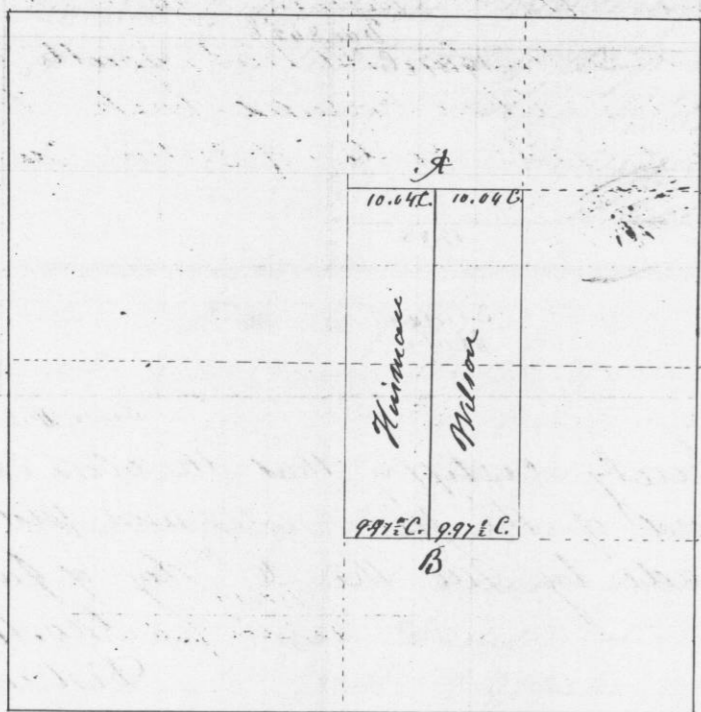

- Corners established
- at A { Black Oak 12 S 27 W 36 links
 - { Black Oak 15 S 18 E 71 links
 - at B { Marked a White Oak 18 inches in diameter for corner

A true record of the field notes of said Survey made by me Jan 6th 1849

Geo. R. Stuntz
District Surveyor
of Grant Co. Wis.

Survey made for John F. Miles in Section one Township No. 3 North of Range No. 2 West commencing at the quarter Section post on the East side of said Section found the original corner by measuring the required course and distance from the Stumps of the original bearing tree and marked new trees for bearings
 White Oak 10 S 71 W 279 links
 Black Oak 6 S 28 E 2 - links
 These run West Variation 830' E at 80.20 chains Intersected Section line 141 links south of quarter Section corner These corrected back true bearing 730' E 40.10 and set center of Section See bearings above *

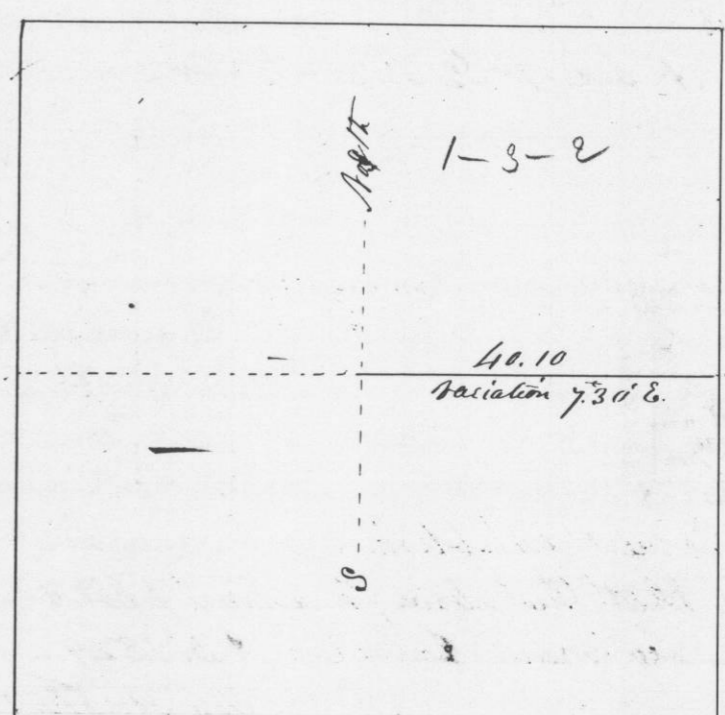

I hereby certify that the above is a true record of the field notes and plot of Survey made by me the 7th day of June A.D. 1849.
 Geo. R. Stuntz, Dist. Surveyor of G. Co. Wis.