

Survey made for William S. Blendiner of a piece of land off of the south side of the N.W. 1/4 of section N^o 5 in Township N^o 3 north of Range 3 west of the 4th Principal Meridian, and the N.W. 1/4 of the S.W. 1/4 of same section

1/2 of Sec - 5 - T³ - R³ -

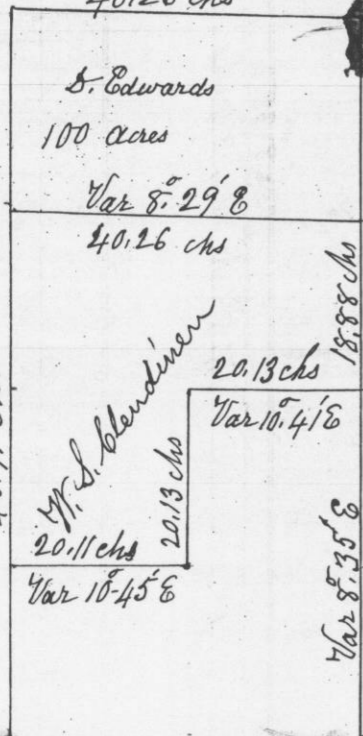

Scale 20 chains to 1 inch

Commencing at the Centre of section; Synn 10 N 19 W 26 1/2 links
W. O. 145 66 E 36 "

Thence west on corrected line 20.13 chains; set 1/8 post; Bearing Br. 0.105 89 W 44 links
W. Elm 105.75 E 33 1/2 "

Thence south on corrected line 20.13 chains to 1/16 post; Bearing W. O. 22 N 78 W 36 links
" " 26 5 36 E 45 "

Thence west 20.11 chains; corrected and set 1/16 post. Bearings 2

W. O. 15 5 38 E 50 links - Hickory 8 N 81 E 15 1/2 links; Thence north 40.71 chains to the S.W. corner of Sarius Edwards' Land; Bearings Sugar 18 N 11 E 52 links - Double Elm 12 5 79 E 44 links; Thence east on Edwards' line 40.26 chains. Bearings Synn 14 5 42 W 25 links W. Elm 8 N 56 W 5 1/2 links; Thence south 18.88 chains to the place of beginning - In making this survey the centre of the section was found by running through the same from 1/4 post. to 1/4 post each way as the Law requires

I hereby Certify that the above is a true plot & correct minutes of Survey made March 8th 1849

Geo. R. Sturty -
District Surveyor
G. C. Wis
Mr Stephen Mahood
Deputy

Survey made for Douglas Oliver of the S.W. 1/4 of the S.W. 1/4 of section N^o 5 in T³ north of Range 3 west of the 4th Principal Meridian March the 8th 1849

1/2 of Sec 5 - T³ - R³ -

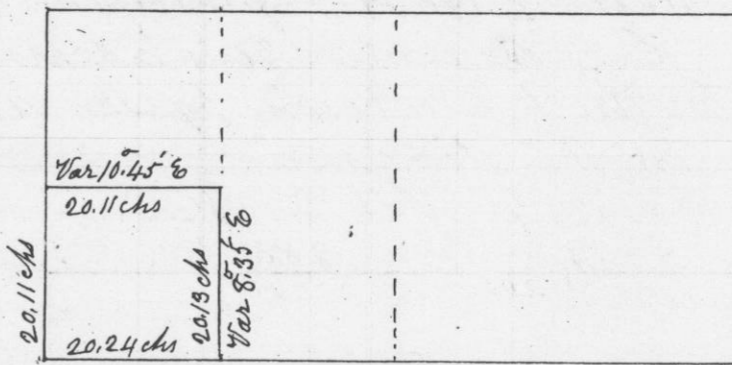

Having run through the section from the 1/4 post on the South side to the 1/4 post on the North side, and in like manner from the 1/4 post on the East side of said section to the 1/4 post on the West side, as the Law directs; and Established the Centre of section; and having run thro' the S.W. 1/4 in like manner, and Established the 1/16 post in the Centre of the same, from which the bearings are a W. O. 22 N 78 W 36 links W. O. 26 5 36 E 45 links - Thence west 20.11 chains to 1/16 post, Bearings W. O. 15 5 38 E 50 links - Hickory 8 N 81 E 15 1/2 links - Thence south 20.11 chs to section corner, Original - Thence East 20.24 chains to 1/8 post, Bearing W. O. 22 N 68 W 84 links - W. O. 16 5 78 E 49 links - Thence north 20.13 chs to the place of beginning

I hereby Certify that the above is a true plot and correct representation of Survey

Geo. R. Sturty
District Surveyor
G. C. Wis
Mr Stephen Mahood
Deputy