

kat

No 543

Survey made for Sydney ^{Smith} of the S. 1/4 of the N. 1/4 of the E. 1/2 of the N. 1/4 and the N. 1/4 of the N. E. 1/4 of Section No 35 in Township No 4 North and Range No 4 west of the 4th Principal Meridian June 16th 1848

Sec. 35-14-R4 W.

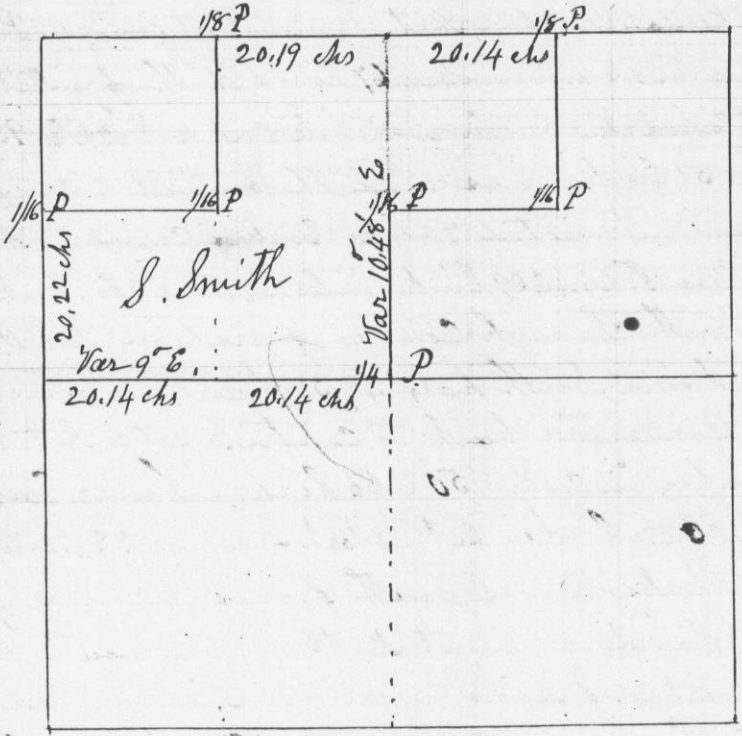

Commencing at 1/4 Post on west side of Section - Thence North Var 9° E: 40.44 chains, intersected 89 links East of Corner - Thence East Var 9° E: 40.38 chains, intersected 16 links North of 1/4 Post - Thence East Var 8.55° E: 40.28 chains, intersected 59 links North of Section Corner - Corrected back & set 1/8 Post. W. 0.9 S 56 1/2° W 91 links
 10 W. 0.7 S 61° E 89 links - Thence South from 1/4 Post on North side Var 10.15° E: 40.67 links Corrected back & set Centre 1/4 Post B. 0.10 S 25° E 10 links B. 0.13 N 16 1/2° E 34 links Thence West 20.14 links; set 1/8 Post W. 0.7 N 64° E 13 links - B. 0.8 S 54° E 49 links
 11 From 1/4 Post on west side of Section - North 20.22 links set 1/16 Post B. 0.8 N 17° W 20 links B. 0.10 S 39° E 37 links
 12 East to centre of N. 1/4 B. Ash 9 inches - diameter, Corner
 13 Thence East to East side of N. 1/4; set 1/16 Post, B. 0.7 N 30° W 22 links
 14 B. 0.9 S 48° E 33 links = East to S.E. corner of N. 1/4 of N. E. 1/4 set 1/16 Post
 15 B. 0.9 S 20 1/2° E 30 links; Ironwood 65 56° E 25 links

I hereby Certify that the above is a true Plot & record of Survey

No 544

Survey made for Charles, O. Harra & others in Section No 2 in Township No 2 North & Range No 3 west of the 4th Principal Meridian - June 20th 1848 -

Commencing at the 1/4 Post on North side of Section Thence South Var 8° E: 39.90 chains; intersected 28 links west of Centre - Thence East Var 8° E: 40.42 chains; intersected 17 links South of 1/4 Post - Corrected back to 1/8 Post - set Post B. 0.10 S 83° W 48 links - B. 0.8 S 68° E 49 links - 1/4 Centre post
 9 Established by Freeman ^{double} W. 0.18 S 61 1/2° W 31 links - W. 0.12 N 9° W 31 links from 1/8 Post East of Centre, North - Established Corners -
 (No 1) W. 0.18 N 18° E 8 links - (No 2) ~~W. 0.20 S 66° E 89 links~~ (No 2) W. 0.18 N 35° E 22 links - W. 0.10 S 40° E 37 links - (No 3) W. 0.20 S 66° E 89 links
 W. 0.20 N 47° W 69 links - (No 4) Post in Mound -
 Heirs of John N. Charles and others, on the West half of N. E. 1/4 of Sec 2 - T2 - R3 west -
 E. 1/2 of Sec - 2 - T2 - R3 W -

Chas. O. Harra	Wm Young

I hereby certify that the above is a true and correct record of Survey

Geo. R. Stuntz
District Surveyor
G. C. Wis -