

Survey made for Samuel Crocker of the
 S.W. 1/4 of the S.W. 1/4 of Section No 28 - T. N. 3. N. of R. No 2 west
 of the 4th Principal Meridian - March 3rd 1848
 S.W. 1/4 of Sec No 28 - T. 3. N. R. 2. W.

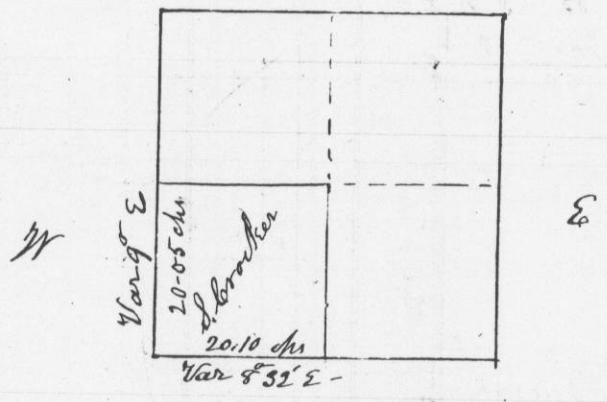

Commencing at S.E. corner Var 8° 32' E - 20.10 chains - intersected at
 section corner thence North Var 9° E 40.10 chs intersected
 at 1/4 Post - corrected back 20.05 chains set 1/16 Post
 Bearings - W. O. 20 S 42 1/2 W 40 links - W. O. 20 S 83 1/2 E links
 Thence East Var 8° 30' E set 1/16 Post
 Bearings W. O. 12 S 45 E 21 links - W. O. 12 S 19 W 16 links
 Thence south to 1/8 Post sugar 15 S 60 E 27 links - sugar 15 S 66 1/2 W 62
 Thence west to S.W. corner of section.

I hereby certify that the above is a true plot
 and minutes of said survey

Geo. R. Stuntz
 District Surveyor
 G. C. Wis. T. 4

Survey made for John Hinman & James Canby
 of the N. 1/2 of the N.E. 1/4 & the S.W. 1/4 of N.E. 1/4 of Section No 3
 Town No 2 R. No 2 west of the 4th Principal Meridian
 N. 1/2 of Sec 3 - T. 2. R. 2 W

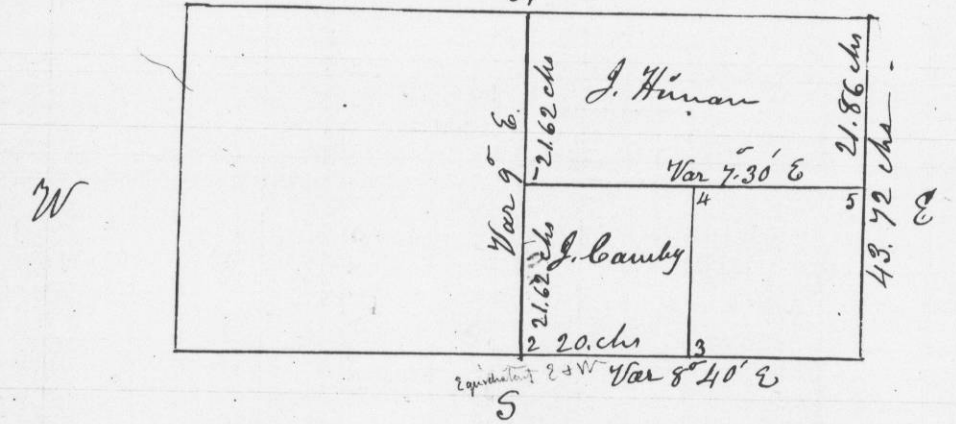

Commencing at 1/4 Post on East side, thence North Var 9° E
 intersected ^{21 links West of} corner - - - thence West from 1/4 Post on East
 Side of Section 80 chs - Var 8° E intersected 80 links North
 Corrected back and thence from South side through centre of
 Section intersected 50 links East of corner corrected back to
 1-1/16 Post - Bearings Sugar 10 S 8 W 45 links - Sugar 9 N 57 W 16 links thence
 South to 2 centre of section Sugar 14 N 46 W 38 links - Sugar 8 East 26 links
 Thence East 20 chs to 3. 1/8 Post. B. O. 12 S 27 1/2 W 25 links - B. O. 10 N 73 1/2 E 25 links - thence
 North to 4-1/16 Post - B. O. 20 S 30 W 54 links - B. O. 24 N 42 E 39 links - thence East
 to 5-1/16 Post - Sugar 9 N 48 E 10 links - W. Ash 7 S 70 W 100 links - -

I hereby certify that the above is a true plot and record
 of the minutes of survey March 8th 1848

Geo. R. Stuntz
 District Surveyor
 G. C. Wis. T. 4