

No 513

Survey made for Peter Fecht of the North West quarter of Section No 6 in Township No 2 North of Range No 2 West of the 4<sup>th</sup> principal Meridian

Corners established by running as the Law directs

N.W. quarter of Sec. No 6 T. 2 R. 2

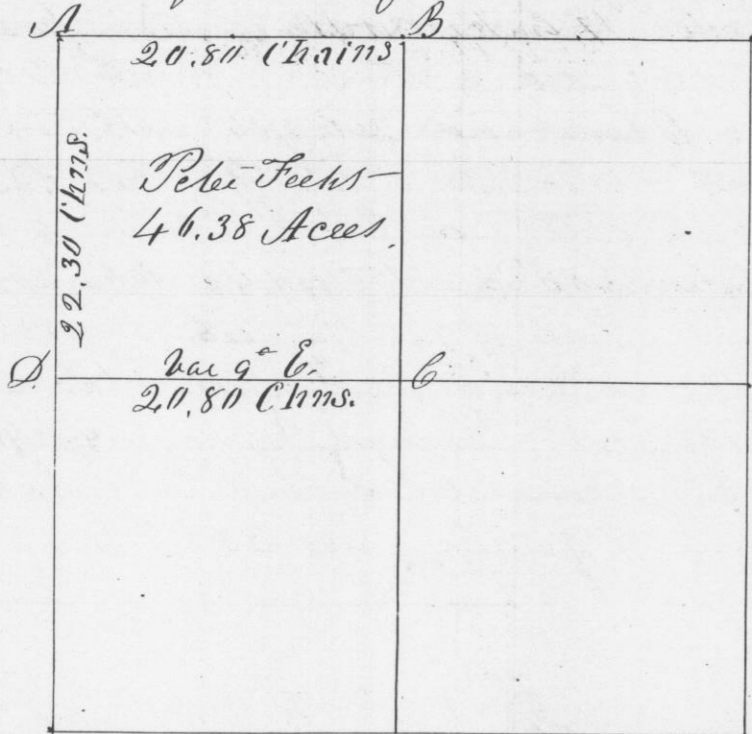

Scale 10 Chains to the inch

at A Original bearings { Bce 614 S 2 E 90 links  
Bce 20 N 23 W 160 links

at B - - - - - 10 { Black Oak 10 S 15 W 22 links  
White Oak 20 N 48 W 47 links

at C - - - - - 14 { White Oak 15 N 79 W 22 links  
Sugar 8 S 56 E 8 links

at D - - - - - 3 { Black Oak 18 S 72 E 80 links  
Black Oak 8 S 7 W 60 links

I hereby certify that the above is a true record of the plot and minutes of said Survey made by me the 12<sup>th</sup> day of November 1847  
Geo. N. Stuntz

No 514

Survey made for John Holl of the N.W. quarter of the N.E. quarter of Section No 1 in Township No 2 North of Range No 3 West of the 4<sup>th</sup> principal Meridian

Corners all established by running as the Law directs

N.E. quarter of Section No. 1 T. 2 R. 3

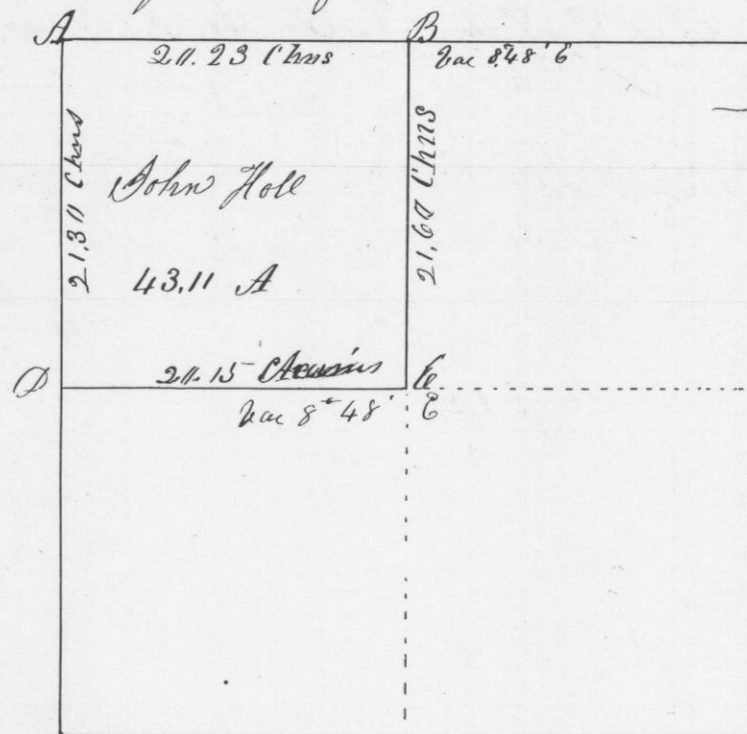

Scale 10 Chains to the inch

Corners Established

at A - Original { White Oak 20 N 13 W 49 links  
White Oak 14 N 48 E 100 links

" B - - - - - 15 { Black Oak 14 S 24 W 27 links  
White Oak 6 S 83 W 55 links

" C - - - - - 15 { White Oak 20 S 36 W 90 links

" D - - - - - 13 { White Oak 15 N 22 E 192 links  
White Oak 16 North 148 links

I hereby certify that the above is a correct record of the plot and minutes of said Survey made by me the 26<sup>th</sup> day of Nov A.D. 1847  
Geo. N. Stuntz