

Survey made for Myron Tuttle of the South West quarter of the South West quarter of Section No. 12 in Town No. 4 North of Range 3 West of the 4<sup>th</sup> Meridian in Grant County W. Va. April 6<sup>th</sup> 1847.

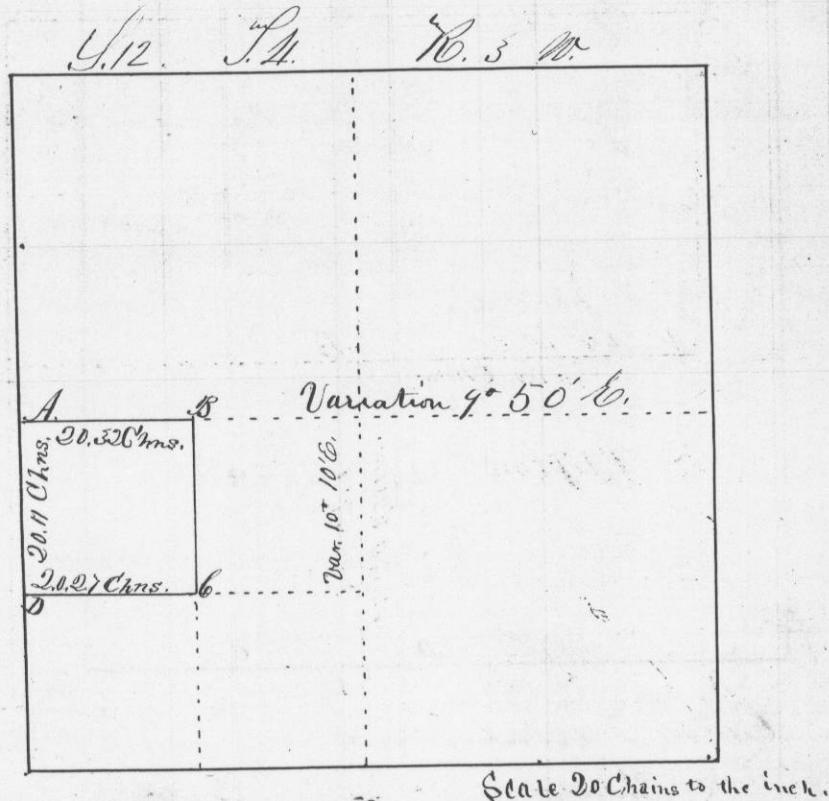

Scale 20 Chains to the inch.

Bearings taken at the corners.

- At A. { Black Oak 85° 48' E 16 links New gone
- Black Oak 9 N 46° E 271 links
- Black Oak 7 S 66° W 36 links
- At B. { Black Oak 6 N 89° W 26 links
- Black Oak 5 N 5° W 23 links
- At C. { Blue Oak 5 S 59° W 139 links
- Black Oak 6 S 10 E 113 links
- At D. { Black Oak 4 S 27° W 124 links

I hereby certify that the above is a true plot and correct copy of the minutes of said Survey made by me the sixth day of April 1847.

Geo. H. Stuntz  
Dist. Surveyor G. C. M. S.

Survey made for William Clifton of the South West quarter of Section No. 35 in Town No. 5 North of Range No. 1 West of the principal Meridian in Grant County W. Va. April 9<sup>th</sup> 1847.

S. No. 35 T. 5. R. 1.

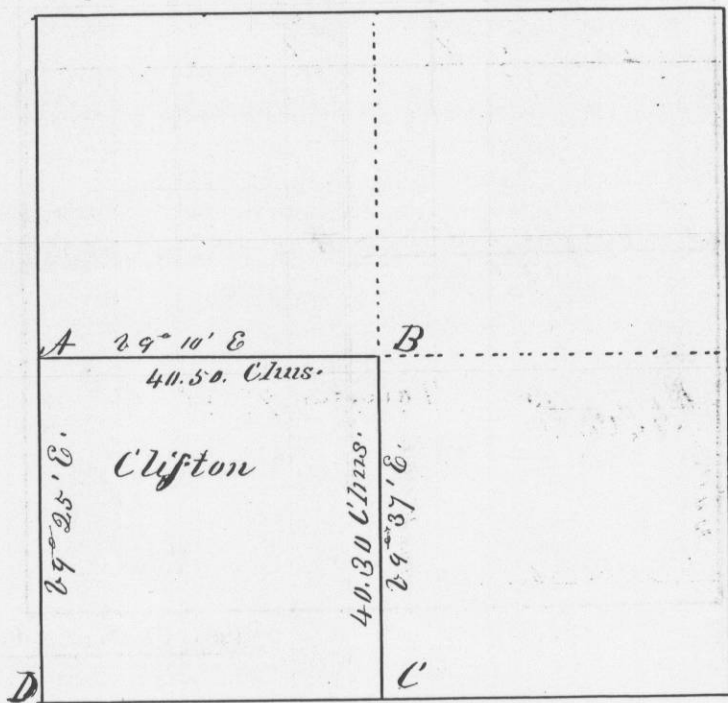

Corners

- At A. Hickory post
- At B. { Bearings { Aspew 9 N 48° W 194 links
- Black Oak 8 S 76° W 232 links
- At C. { Blue Oak 8 N 57° W 89 links New
- Blue Oak 7 S 58° E 9 links
- At D. Original Cor. Black Oak 9 inches (Full outside)

I hereby certify that the above is a true record of the plot and minutes of said Survey made by me April 9<sup>th</sup> 1847.

Geo. H. Stuntz  
District Surveyor of G. C. W. Va.