

No. 451

Survey made for Lewis Swapp & John Martin
of the E 1/2 of the N 1/4 of Sect. 13 in Town
2 N of Range 3 W of the 4th Prime Merid.

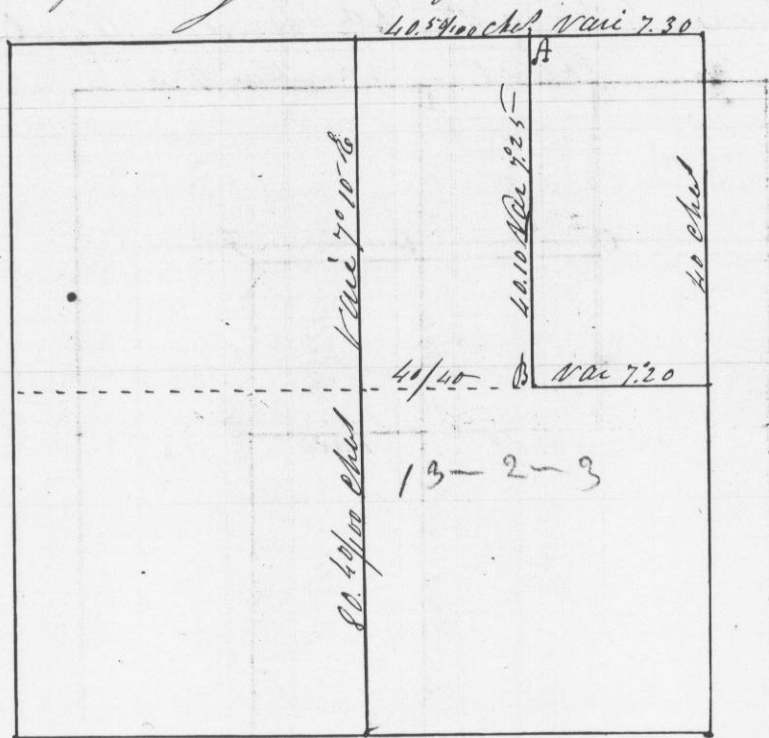

Scale 20 chas to the inch

At A Post co. White Oak 14 S 79 W 12 Lk 15
 At B E " Elm 10 S 24 W 75 " 17
 I hereby certify that the above is a
 true plat & copy of the minutes of
 said Survey made by me the 10 of
 April 1846
 Saml C. Wilton
 Dist Surveyor of
 Jt. Co. W. Va.

No. 452

Survey made for Abagail Curtis of the S 1/2
1/4 & the W 1/2 of the S 1/4 of Sect. 13 in Town
One North of Range One W of the 4th Prime
Merid
13-1-1

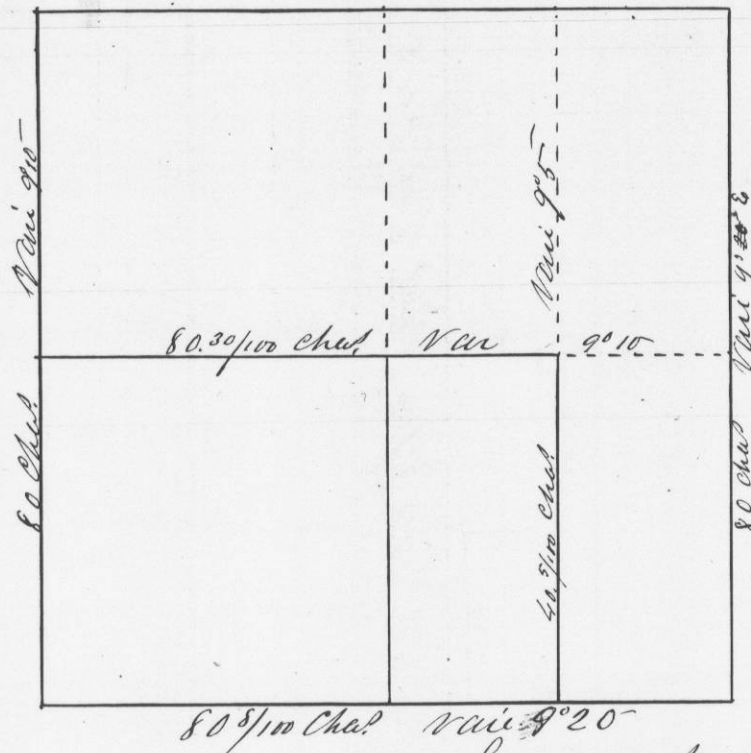

Scale 20 chas to the inch

Corners all marked by Posts set in
No owners.

I hereby certify that the above is
 a true plat & copy of the minutes of said
 Survey made by me the 10 of May 1846
 Saml C. Wilton
 Dist Surveyor of
 Jt. Co. W. Va.