

Survey made for John Heathcock of the West half of the South West quarter of Section No. 28 in Town No. 6 North of Range No. 1 West of the 4th principal Meridian in Grant County W. Va. February 5th A.D. 1846

Section No. 28 Town No. 6 North of Range No. 1 West

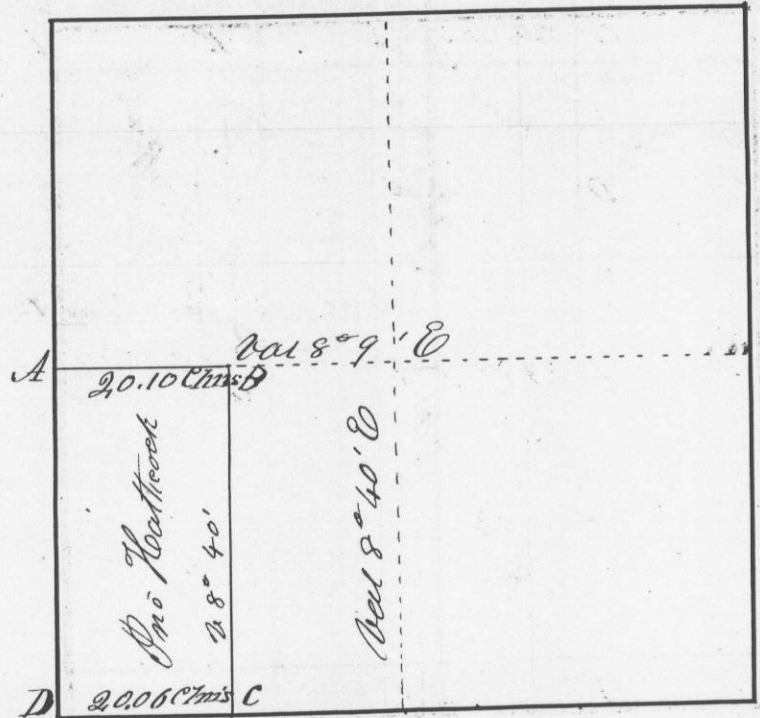

Corners

- at A { B. Oak 85 42 1/2 E 1099 links } Original
 { B. Oak 95 15 1/2 W 1363 links }
- at B Set post marked 185
- at C { B. Oak 9 N 45 E 47 links } 23
 { B. Oak 85 50 E 42 links }
- at D { B. Oak 75 56 W 127 links } Original
 { W. Oak 8 N 19 E 80 links }

I hereby certify that the above is a true plot and correct minutes of said survey made by me this fifth day of February A.D. 1846
 Geo. W. Huntz

Survey made for John Heathcock of the E 1/2 of the N.E. 1/4 - E 1/2 of the S.W. 1/4 & N.E. 1/4 of N.W. 1/4 of Section No. 31 in Town No. 6 North of Range No. 1 West of the 4th principal Meridian in Grant County W. Va. February Sixth A.D. 1846

Section No. 31 Town No. 6 North of Range No. 1 West

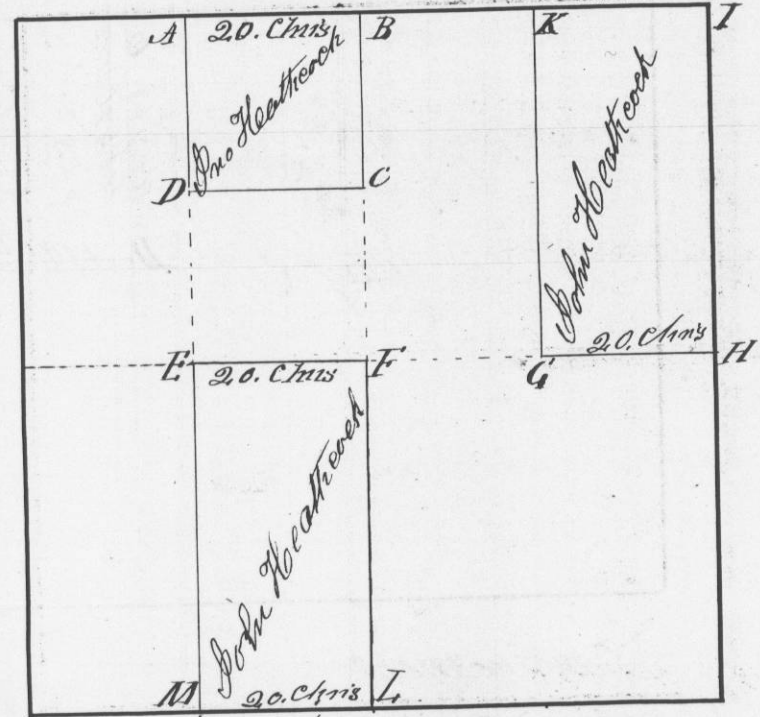

Corners

- at A Set post marked 185 at G. Set post W. Oak 12 N 38 1/2 E 93 L
- at B " " " 145 at H. B. Oak 15 S 77 1/2 W 56 L
- at C " " " 1165 at I Original { B. Oak 12 S 13 W 204 L
 { C. Oak 7 N 11 W 505 }
- at D " { B. Oak 14 N 77 1/2 W 165 } 4 { B. Oak 12 N 7 1/2 E 125 L
 at E Set post marked 185 Original { B. Oak 14 N 41 E 38 links }
- at F " " " 1145 at K Set post marked 185
- at G " { B. Oak 6 N 51 W 265 } 23 at L Original { B. Oak 6 N 6 1/2 E 90 L
 { W. Oak 18 N 58 W 102 }

I hereby certify that the above is a true plot and correct minutes of said survey made by me this sixth day of Feb. A.D. 1846
 Geo. W. Huntz