

Survey made for Mr A Fry of the North West quarter of Section N^o 12 in Town N^o 5 North of Range N^o 1 West of the 4th principal Meridian in Grand County W. Va January 30th 1846
 Section N^o 12 Town 5 North of R. 1 W.

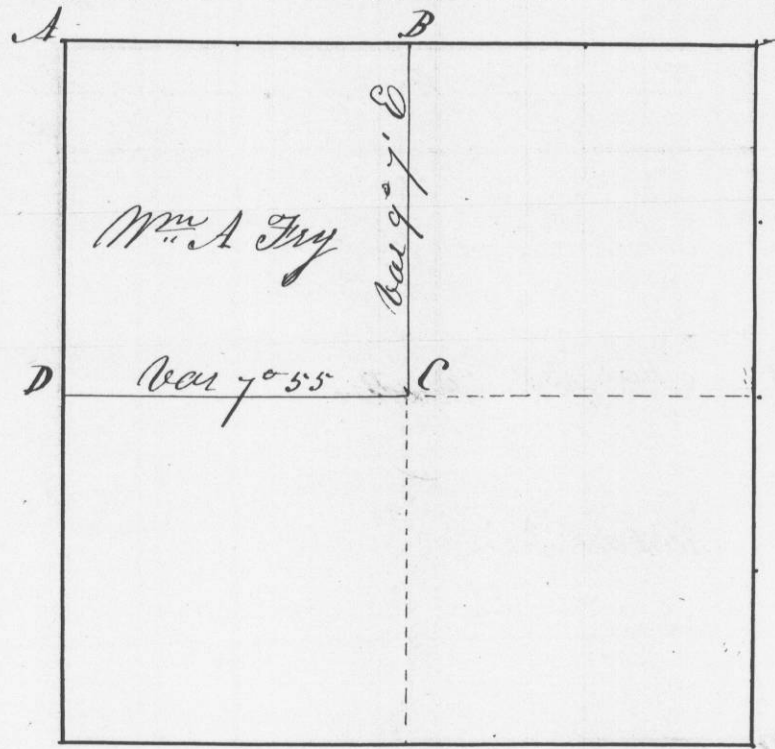

Corners
 at A set post in the original mound marked (12.11.812)
 at B set post marked 1/4 S (12.11.812)
 at C set post 1/4 S.
 at D set post in the original mound marked 1/4 S
 I hereby certify that the above is a true plot and correct minutes of said survey made by me this 30th day of January A.D. 1846

Geo. R. Sturtevant
 District Surveyor
 G.C.W.V.

Survey made for Thomas Sandymann, William Thompson and Isaac Burton of the N.E. 1/4 and E 1/2 of the S.E. 1/4 of Section N^o 24 in Town N^o 5 North of Range N^o 1 West of the 4th principal meridian in Grand County W. Va January 31st A.D. 1846

Section N^o 24 Town N^o 5 North of R. 1 West

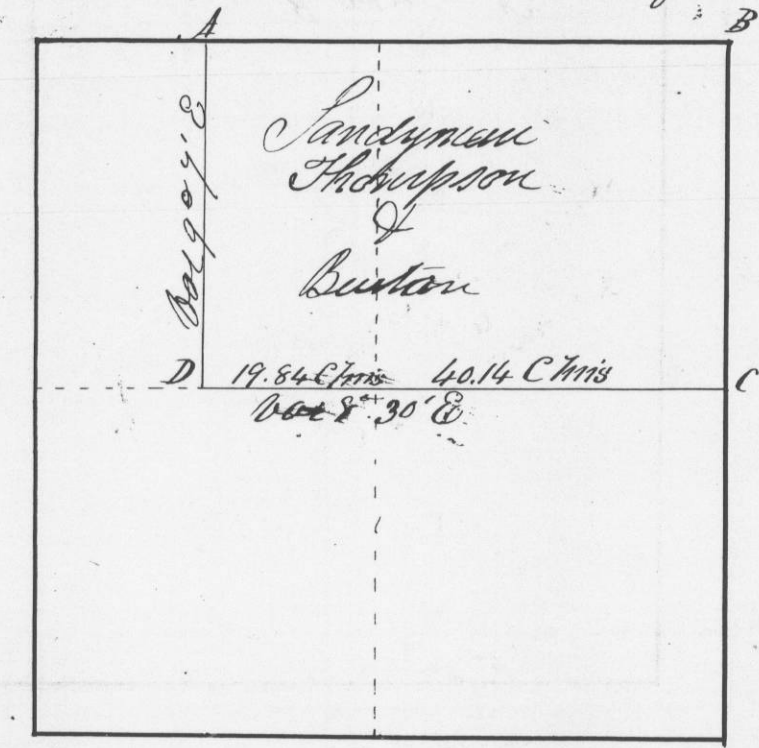

Corners
 at A. placed a small stone in the ground
 at B Original post in mound
 at C
 at D set post marked 1/8 S
 I hereby certify that the above is a true plot and correct minutes of said survey made by me this thirty first day of January A.D. 1846

Geo. R. Sturtevant
 District Surveyor