

Survey made for G. J. L. Clifton of the
 South East quarter of Section N^o 10 in Town
 N^o 5 North of Range N^o 1 West of the 4th
 principal meridian in Grant County W. T.
 January twenty ninth 1846
 Section N^o 10 Town N^o 5 North of R. 1 W.

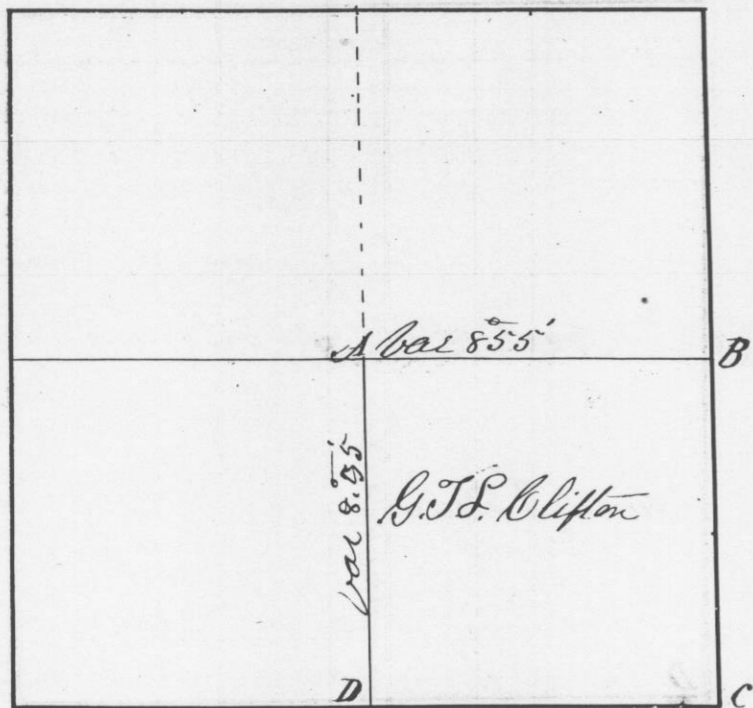

Beasings at the corners
 at A { W. Oak 14 N 72 1/2 E 95 1/2 links }
 { W Oak 14 S 27 1/2 E 161 links }
 at B { B. Oak 9 S 23 1/2 E 114 links } Original
 { B. Oak 11 S 12 W 65 links }
 at C { B. Oak 9 S 45 W 42 1/2 links } Original
 { B. Oak 10 N 4 1/2 W 287 links }
 at D { B. Oak 8 S 23 E 58 links } Original
 { W. Oak 9 N 48 1/2 W 59 links }

I hereby certify that the above is a true
 plot and correct minutes of said Survey
 made by me this twenty ninth day of January A. D. 1846
 A true record Met Geo. R. Stuntz

Survey made for Michael Freese of the
 S. M. 1/4 of Section N^o 12 in Town N^o 5 North
 of Range 1 West of the 4th Principal Meridian
 in Grant County W. T. January 30th A. D. 1846
 Section N^o 12. Town N^o 5 North of Range 1 W.

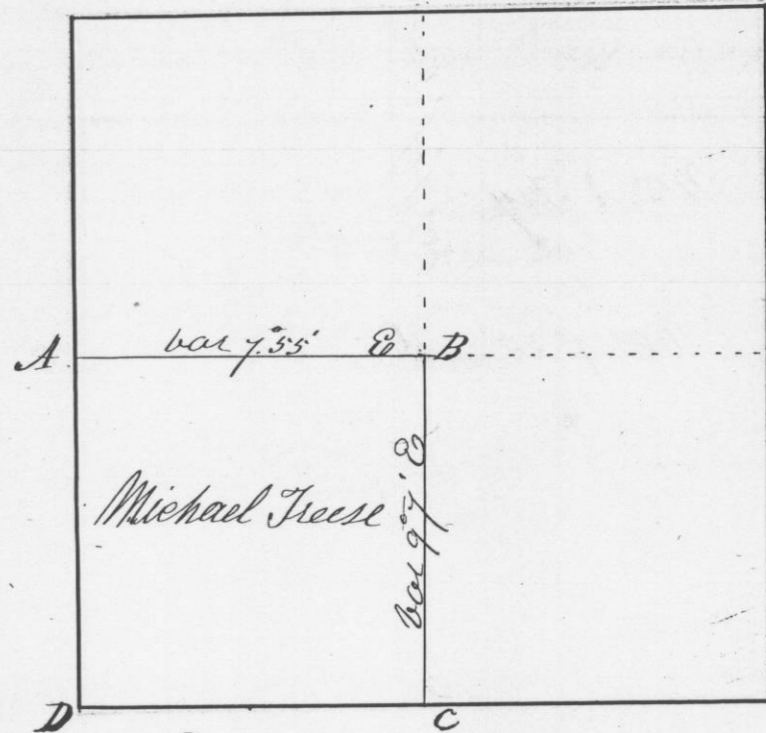

Corners
 at A. Set post in the Original Meridian
 at B. Set post marked 1/4 S
 at C. Set post in the Original Meridian
 at D. Set post in the Original Meridian
 marked it 11, 12, 13, & 14 R 1 W. T. S. N
 I hereby certify that the above is a true
 plot and correct minutes of said
 Survey made by me this 30th day
 of January A. D. 1846

A true record A Met
 Geo. R. Stuntz
 District Surveyor
 G. R. M.