

Survey made for Rosman Clifton of
 the West half of the North West quarter
 of Section No. 14 in Town No. 5 North of Range
 No. 1 West of the 4th principal Meridian
 in Grant County W. T.; January 28th 1846

Section No. 14 Town No. 5 N. Range 1 W.

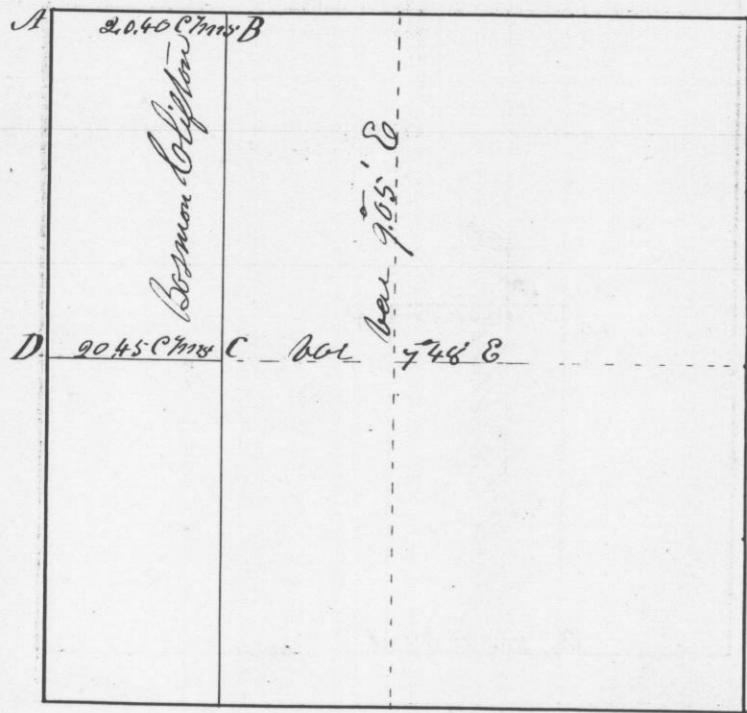

Corners at A. { Br. Oak 95° 45' N 421 links } Original
 { B Oak 10 N 42° W 287 links }
 " B Stone placed in the earth
 " D. { W. Oak 18 N 78° W 164 links } Original
 { Br Oak 95° 46' E 163 links }
 B post marked 1/8 S

I hereby certify that the above is a true plot
 and correct minutes of said Survey made
 by me this 28th day of January A.D. 1846

Geo. M. Stutz
 District Surveyor

Survey made for Rosman Clifton of the North
 East quarter and East half of the South
 East quarter of Section No. 15 Town No. 5 North
 of Range No. 1 West of the 4th principal
 Meridian in Grant County W. T.; January 28th 1846

Section No. 15 Town No. 5 North, Range No. 1 W.

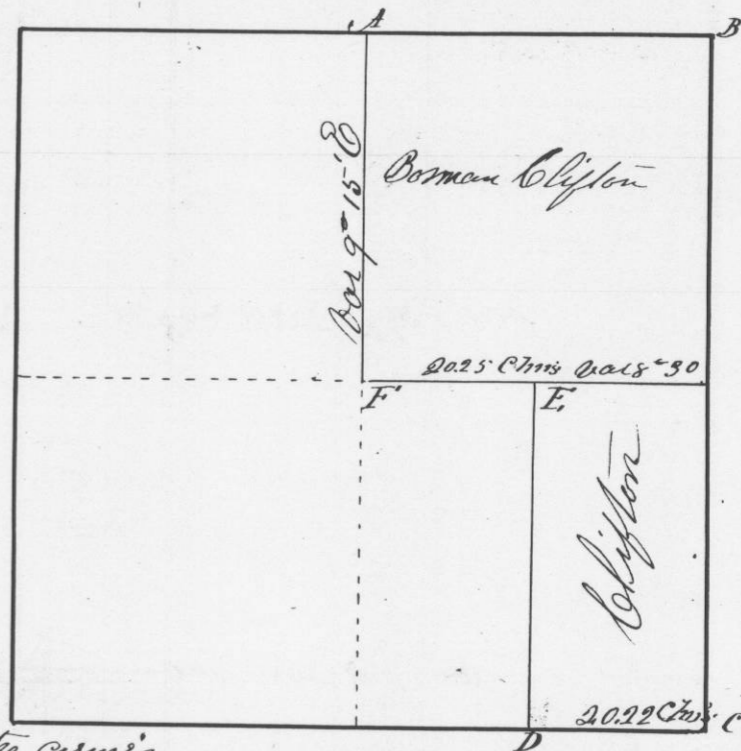

Bearings at the corners
 at A. { Br Oak 88 23 1/2 E 58 links } original
 { W Oak 9 N 48 1/2 W 53 links }
 at B. { Br Oak 95 45 N 421 links } original
 { B Oak 10 N 42 W 287 links }
 at C. post in mound. Original
 at D. { Br Oak 85 19 W 30 links } original
 { B Oak 8 N 92 E 27 }
 at E. { B Oak 9 N 68 W 7 links }
 { Br Oak 6 S 58 E 10 links }

I hereby certify that the above is a true plot
 and correct minutes of said Survey made by me
 this 28th day of January A.D. 1846

Geo. M. Stutz
 District Surveyor
 G. C. W. T.