

Survey made for Didric Harms
 in the N.W. 1/4 of Fractional Section
 No 7 in Town No 2 North of Range No 1
 West of the 4th Principal Meridian
 Grant County W.T.
 Length and variation of the lines
 marked on the diagram

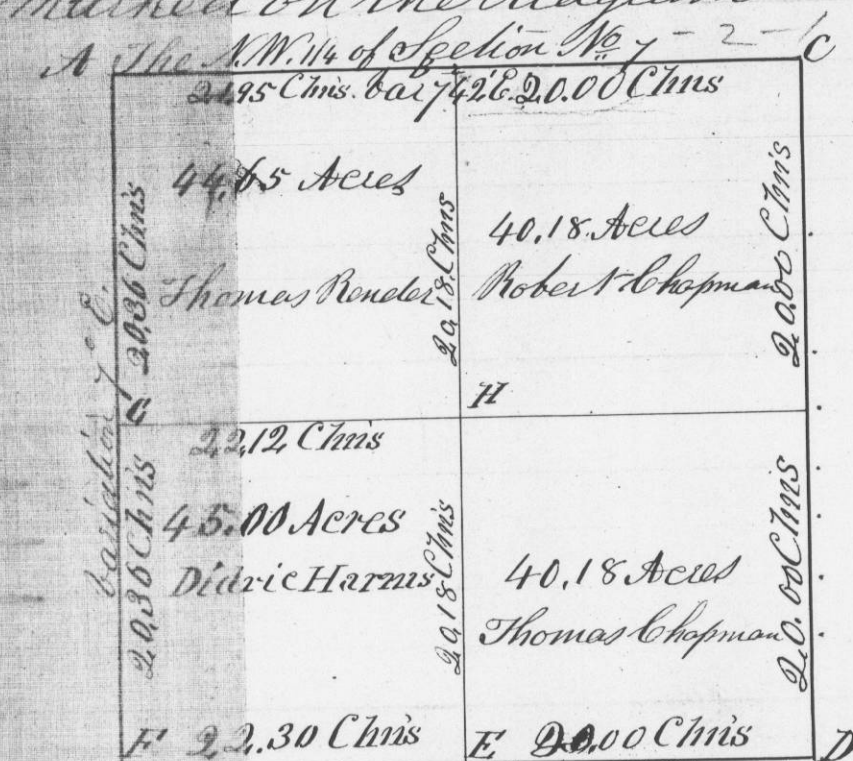

Bearings at the corners
 Int. C. H. F. Original at F W. Oak 8 inches in diameter
 E. W. Oak 30 S 40° W 22 links at H W. Oak 15 N 83 1/2 W
 12 W. Oak 30 N 71 W 75 links 14 W. Oak 13 N 78 3/4 W
 B W. Oak 30 S W 71 links
 16 W. Oak 13 S 6 W 60 links
 G W. Oak 11 N 33 E 12 "
 15 W. Oak 14 S 75 E 42 "
 I hereby certify that the above is
 a true record of the plot and minutes
 of said survey made by me Geo. R. Hunt
 Dec 13 1845

Survey made for Griffith Griffith of
 the N.W. 1/2 of the S.W. 1/4 of Section nine and
 the E. 1/2 of the S.E. 1/4 of Section 8 both
 in Town No 3 North of Range No 1 West of the
 4th Principal meridian Grant County W.T.
 Length and variation of the lines marked on
 the diagram

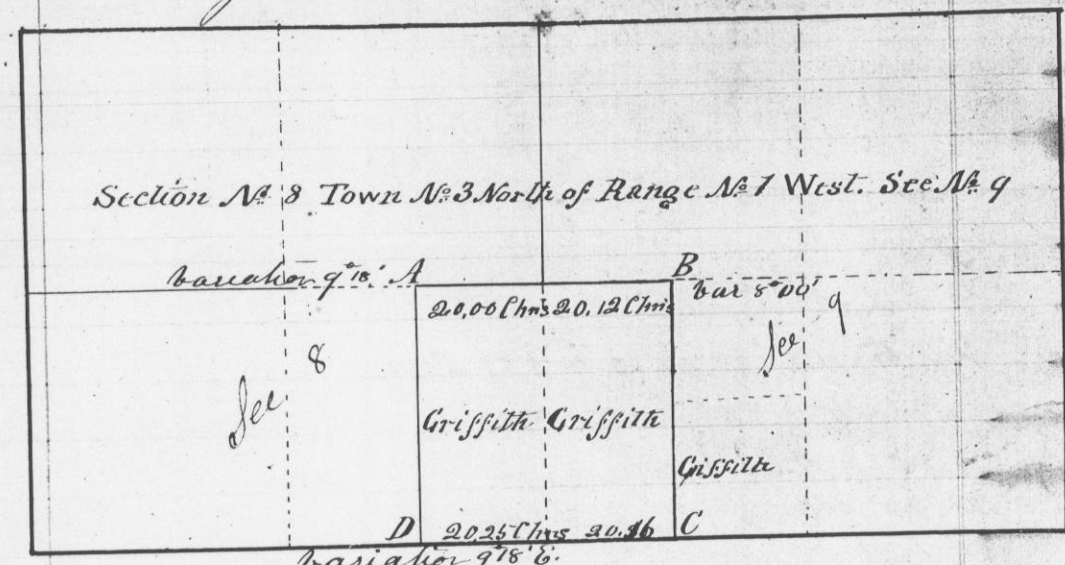

Witness trees at the corners
 At A (Br Oak 16 N. 24 W. 24 links
 Br Oak 12 S 35° E 12 links 17 sec 8
 " B (Br Oak 9 S 89 1/2 E 185 " 17 sec 9
 Br Oak 6 S 45 E. 128 "
 " C Pine 3 inches in diameter 23 sec 9
 " D W. Oak 12 S 81° E. 28 links 20 - 8
 W. Oak 18 S 28° W 23 "

I hereby certify that the above
 is a true record of said survey
 made and recorded by me this
 thirteenth day of Dec. A.D. 1845
 Geo. R. Hunt
 Dist. Surveyor