

Survey made for Dr. R. Cowles of the

North East 1/4 of the N.W. 1/4 & the N.W. 1/4 of the N.E. 1/4 of Section 7 Town 3 N. Range 3 West of the 4th Mer G.C.M.S.

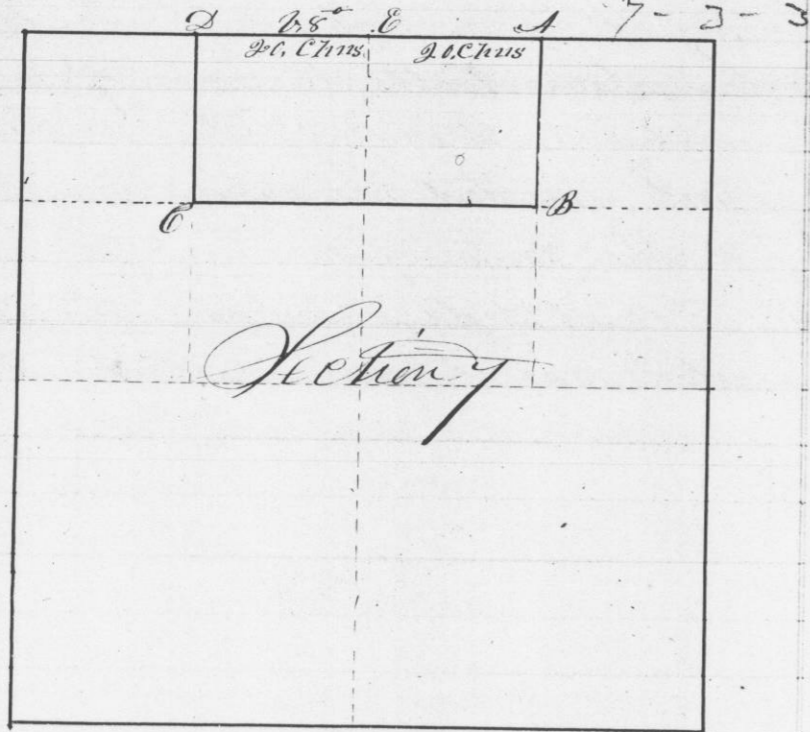

- Cor at A { Lind 12 N 60 W 20 links 15
- { Iron 6 N 84 E 11 " 15
- " " B { Lind 12 S 70 E 20 " 15
- { W. Oak 24 N 76 E 48 " 15
- " " C { B. Oak 30 S 71 W 18 " 14
- { Iron 6 S 37 E 28 " 14
- " " D { B. Oak 20 S 26 E 38 " 10
- { W. Oak 20 S 67 W 78 " 10

I hereby certify that the above is a true record of the plot and minutes of said survey as made by S. C. Wittes Dept Dist Surveyor for G.C.M.S. Aug 29th 1845

Geo W Stuntz
Dept Dist Surveyor
for G.C.M.S.

Survey made for William C Stephens and Stephen Carrhart of the N.W. 1/4 of the S.E. 1/4 of Section thirteen Town No 3 North of Range No 1 West of the 4th Principal Meridian G.C.M.S. Commencing at the quarter post in the center of said Section. Thence East var 8° E 20.20 Chns Thence South ^{through} the center of said S.E. 1/4 of said Section 40.430/100 Chns var 8.30° E Distance on South Side of S.W. 1/4 20 Chns var 8° E. Corners all posted in mounds pits 4 links East

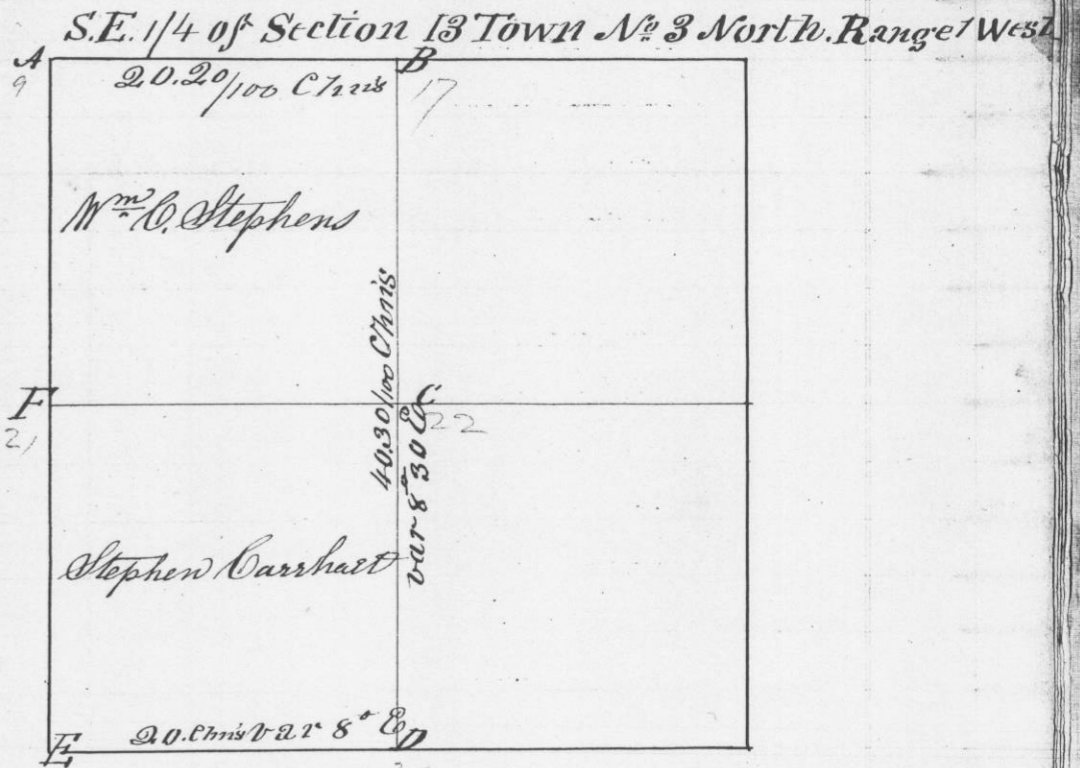

I hereby certify that the above is a true plot and correct minutes of said Survey made by me Oct 9th 1845
Geo W Stuntz
District Surveyor