

Survey made for Elisha Brock of a

parcel of land on the S.E. 1/4 of Section 20, Town 4 North Range 4 West of the 4th Principal Meridian Grant County W.V. Commencing at the quarter post on the ^E side of said section

Thence running South (var 1130' @ 40.40' to the corner of sections 20, 21, 28, & 29

Corrected back 20.20 Chns and set 16th p

Bearings { M. Oak 6S 34 1/2 W 179 19
B. Oak 6S 5 W 198

Thence West (var 755' @) 30 Chns to South West Corner. Bearings { M. Oak 18 N 80 W 352 26
" " 5 N 62 1/2 W 275

Thence North (variation 1130') 20.20/100 Chns to start Bearings { M. Oak 6S 19 3/4 E 294 27
B. Oak 6S 27 1/2 W 282

Thence East (var 755') to place of beginning S.E. 1/4 of Section 20 Town 4 N. R. 4 West of the 4th P.M.

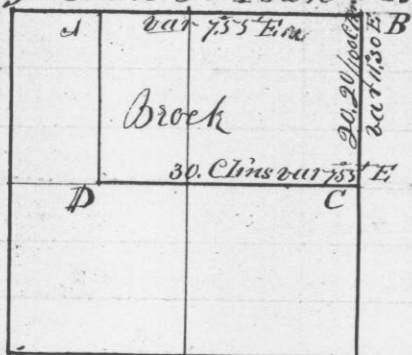

I hereby certify that the above is a true record of the plot and minutes of said survey made by me July 19th A.D. 1845

Geo. B. Stuntz
Dep't. Surveyor
of Grant Co., W.V.

Survey made for N.W. Kendall & D. 283

R. C. Cowles of the North East 1/4 of the South West 1/4 of section 22 Town 4 North Range 3 West of the 4th Principal Meridian Grant County W.V. July 22nd 1845 Also established the 16th post at the S.E. corner of the N.E. 1/4 of N.W. 1/4 of same section as shown by the diagram

Section 22 Town 4 N. Range 3 West of 4th P.M.

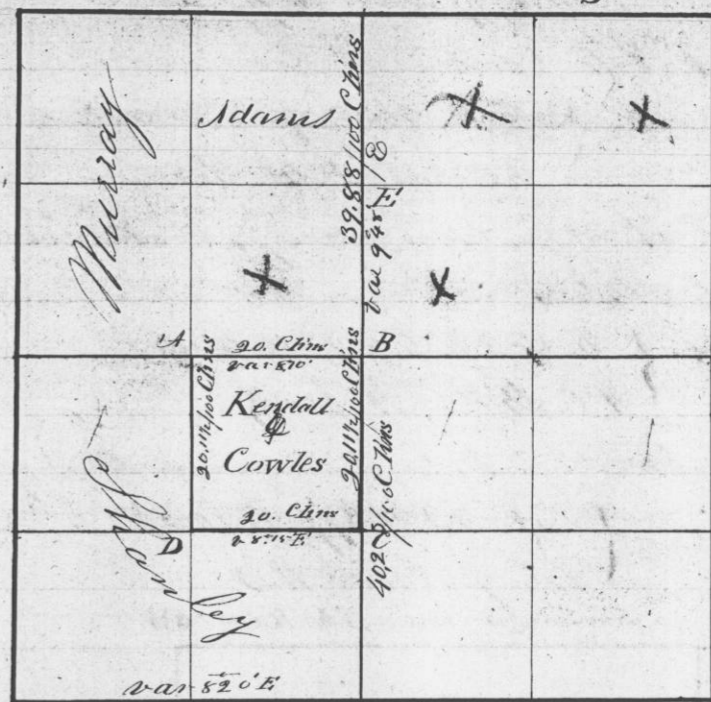

Bearings at the corners at A M. Oak 12 N 25 W 12 12
" B B. Oak 7 N 28 1/2 W 90 9
" C B. Oak 5 N 47 W 138
" D B. Oak 6S 12 E 32 25
" E B. Oak 6 N 14 W 30
" F B. Oak 18 S 89 W 77 11

I hereby certify that the above is a true record of the plot and minutes of said survey made by me July 22nd A.D. 1845

Geo. B. Stuntz
1845