

Survey made for Darius Bainbridge of a line
Dividing the East & West 1/2 of N.W. 1/4 of Sec 7
Town 3 of Range 3 west of the 4th Principal
Meridian in Grant County W. T.

Commencing at 1/4 Post on North side section
West 20 chains to 1/8 Post from which,

Bearings { Red Oak 22 S 28 1/3 E 37
 { W. O. 24 S 66 10' W 77 10

Thence South 40 chains to 1/8 Post Established
by J. E. Freeman (see survey N^o 130)

Bearings { R. O. 24 S 41 W 65
 { Sugar 8 S 41 E 41 1/2

Var
9° 10' E.

I hereby certify that the above is a true and
correct Record of said survey made Dec-
the 27th 1844

Stephen Mahood
Dep. Dist Surveyor G. C. W. T.

Survey made for William N. Reed of the N.E. 1/4 of
Sec 25 in Town 4 of Range 5 west of the 4th Principal
Meridian in Grant County W. T.

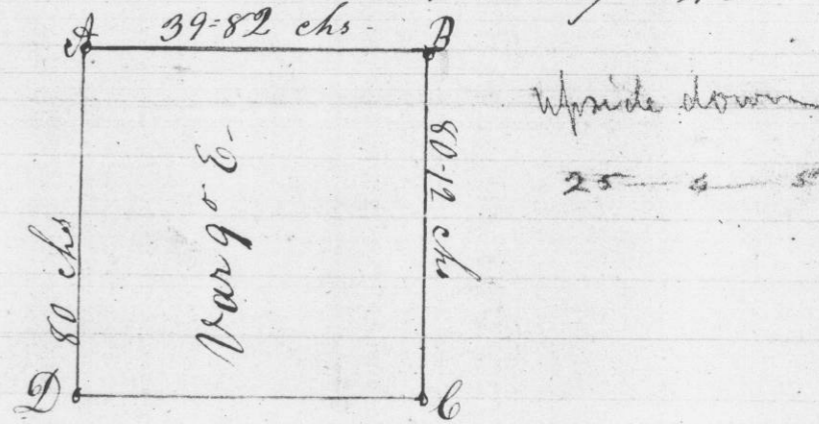

Original { W. O. 11 S 39 W 28 } Bearings at A
 { " " 34 N 40 W 137 }

Centre Post { R. O. 6 S 54 E 25 } " at B
 { W. O. 18 S 83 W 89 }

Original { " " 14 N 1 W 69 } " at C
 { " " 16 N 70 W 57 }

Original { " " 32 S 56 1/2 W 37 } " at D
 { B. O. 6 N 2 1/2 W 350 }

Commencing at 1/4 Post on Town line
West 39.82 chains to centre of section at B
North 80.12 chs 1/4 Post at C.

East 80 chs Sect corner between 24 & 25 at D
South 80 chs to beginning.

I hereby certify that the above is a true and
correct Record of survey made Dec 31st 1844

Stephen Mahood Dep
Dist Surveyor G. C. W. T.