

of Lot No 2 in Survey made for Geo. Hoake of the E. 1/2 of
R. 3 W. of 4th P.M. S.E. 1/4 and S.E. 1/4 of N.E. 1/4 of Section 36
T. 2 S. of Range 2 West of the 4th P.M. in
Grant Co. W.T.

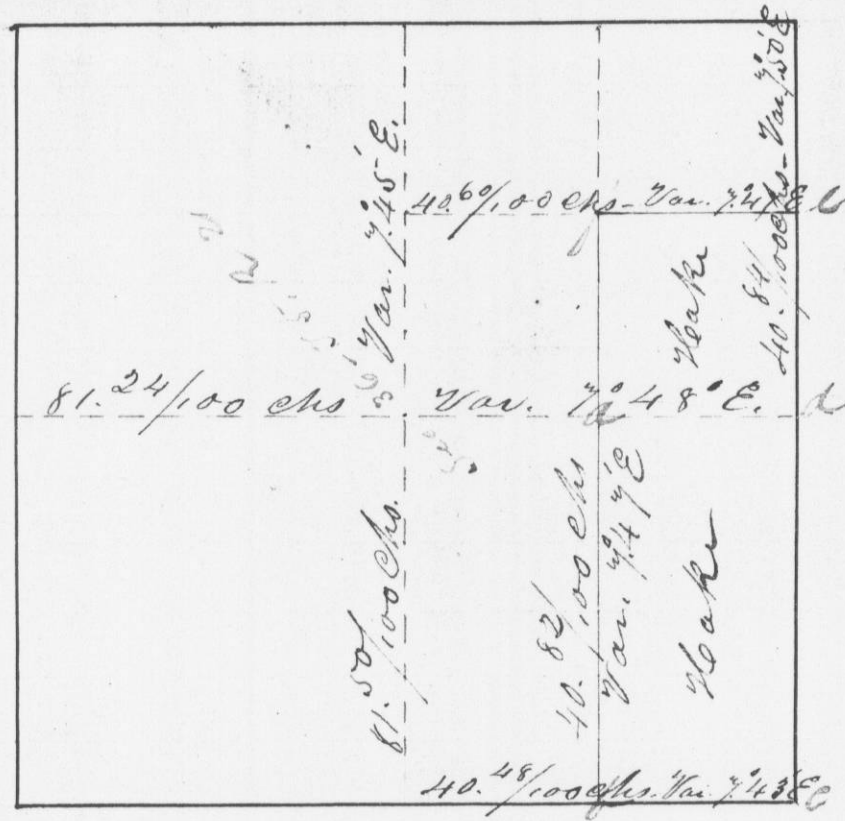

Bottom used 11 S. 85 1/2 W. 15
N. Rich 14 N 98 E. 48

The above is a
made by me
H. A. Willis
Dist. Sur. of G.C., W.T.

- near B.O. 11 S. 46° 40' E 78 } near W.O. 14 S. 9° 20' E. 258
- to B.O. 6 N. 25° E 79 } at e } estab. by me
- near W.O. 16 S. 32 1/4 E 47 } do. } at e } Pr.O. 15 N. 47 W 72
- to Estab. by me }
- to Pr.O. 14 N 16 W 55
- to do 14 " 67 1/2 E 61

I hereby certify that the above
is a true record of said Survey, made
by me on the 2^d day of July, 1844
H. A. Willis
Dist. Sur. of G.C. - W.T.