

1/2 of S.E. 1/4

4th P.M. S.E., N.J.

Survey made for H.S. Dausman of the

W/2 of S.E. 1/4 of Sec. 18, in Town 4, Range 3 West of 4th P.M., S.E., N.J.

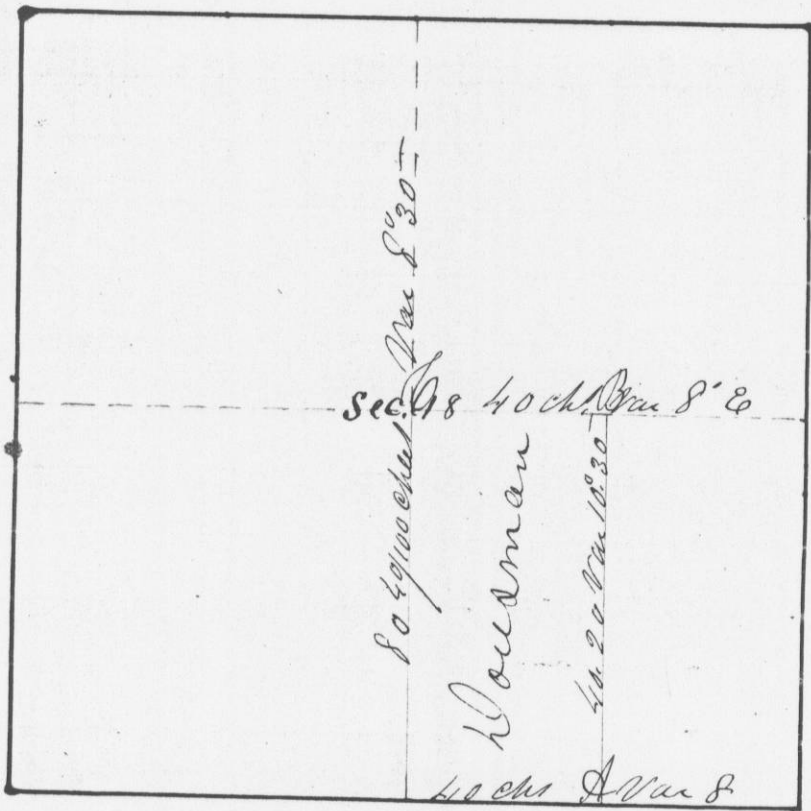
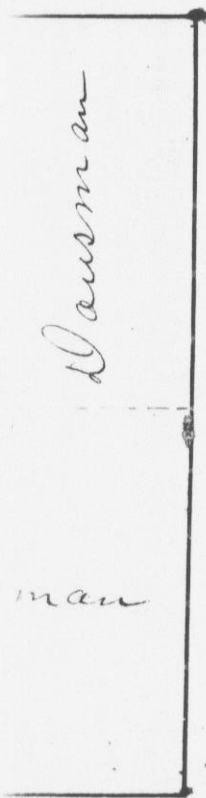

125

80 17

31

21 15

24

21 7

Done in a  
2 made by

S. C. Miller  
Dist Surveyor  
West Co. N.J.

at A Post Cor. { N Oak 14 N 27 @ 32 21  
 Bearings " 18 North 56 " 20  
 at B Post Cor. { B Ash 12 S 18 W 16 "  
 Iron 6 S 44 W 22 17  
 at C Post Cor. { N Oak 12 S 49 W 17 "  
 " 14 S 72 E 82 9

I hereby certify that the above is a true record of said survey made by me the 18 day of June 1844.

Saml. C. Miller  
Dist Dist Surveyor  
Grant Co N.J.