

Survey made for Silas Brooks of the
Wife of the SW 1/4 of Section 27 T2N R2W
of the 4th Prim. Meri-

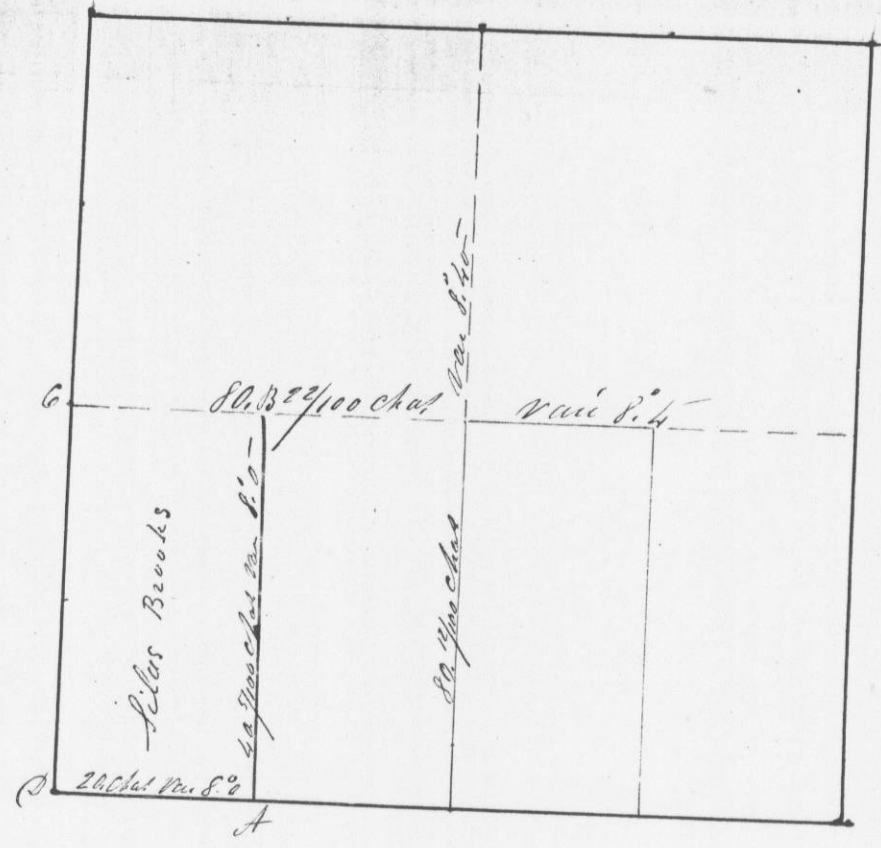

At A Post Cen } Bl Oak 4 5 1/2 19. 2 1/2
Bearings " " 12. 4 1/2 1/4 48 "

At B Post Cen } Bl Oak 20 182 W 36 "

I hereby certify that the above is a true Plot
and copy of the minutes of said survey made
by me May 6th 1844

Saml. C. Miller
Capt. Dist. Surveyor
Quar. & Co. U.S.

Survey made
of the E 1/2



Conus M
Earth 3
I hereby
and copy
to me M