

No. 316

Survey of the
N. 2 W. of the
1st P. M.

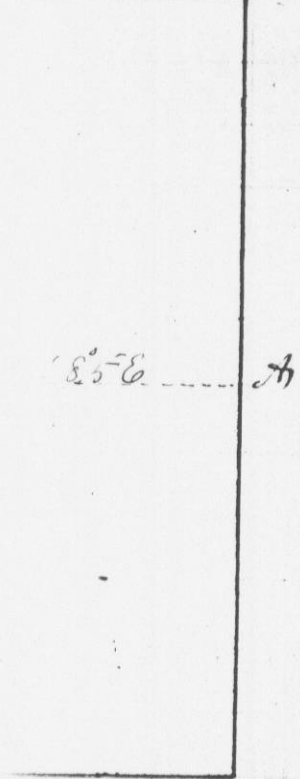

Survey made for Abraham Powers of the E. 1/2
of the N. W. 1/4 of Sec. 27. T. 3 N. R. 2 W. 4th P. M.

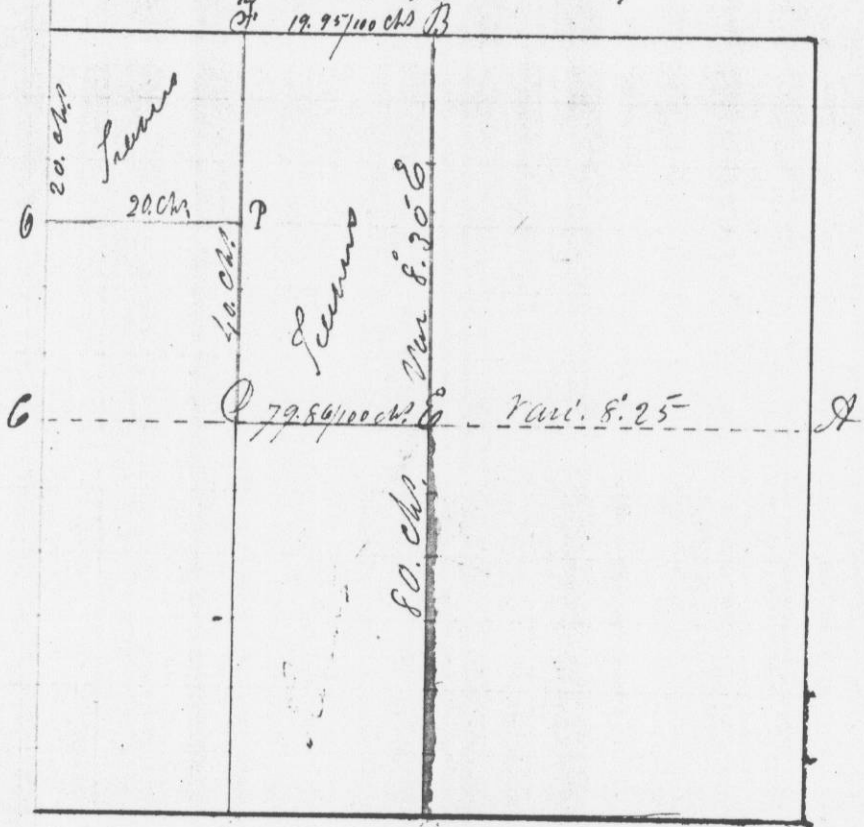

620 N 30 W 171 Sk.
 870 1/2 W 16 Sk.
 1798 27 "
 10 S 45 E 27 "
 4 N 36 W 47
 from Platt
 1st of land
 16th of February
 Saml. C. Milton
 1st Dist. Surveyor
 Grand Co. N.S.

Come at F Bearing { N. Oak 30 S 45 E 27 Sk.
 " " 24 N 36 W 47 " d
 Come at J Bearing { N. Oak 30 S 63 W 23 } " 30
 " " E " 9 { N. Oak 10 N 33 W 140 } " 6
 " " P " 14 { " 15 S 76 1/2 E 117 } " 3
 " " O " 13 { N. Oak 20 S 84 E 95 } " 1
 " " " " 13 { N. Oak 12 S 66 1/2 E 52 } " 4
 " " " " 13 { Oak " 8 N 19 W 56 } " 1

I hereby certify that the above is a true
 copy of the minutes of said survey made
 by me the 16th of February 1844 Saml. C. Milton
 1st Dist. Surveyor
 of Grand Co. N.S.