

Survey made for Chas. A. Murray of the West halves Survey made

of the N.W. and S.W. quarters of Section 27 in Towns 8, 17 and 26
H. T. Range 5 West of 4th P.M. in Grant Co. Mo.

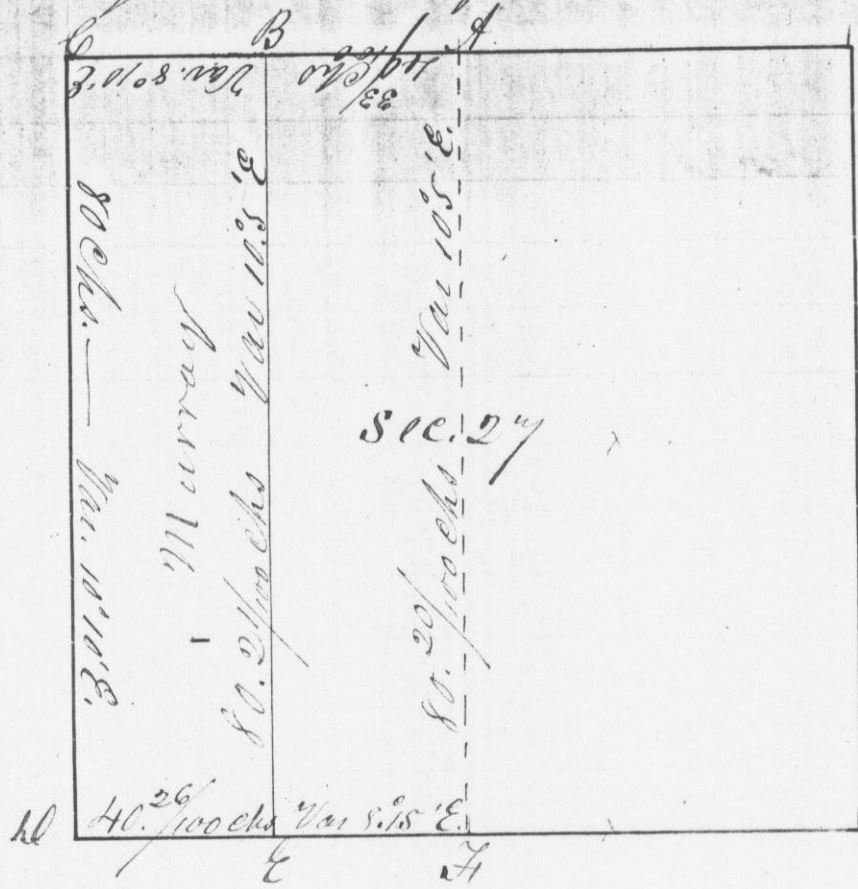

Bearings B. & D. 6 S. 68 1/2° W. 305 } Bearings B. & D. 6 S. 78 1/2° W. 84
 at B. do 5 S. 49 1/2° E. 128 } at E. do. 10 S. 71 1/2° W. 22

I hereby certify that the above
 is a true and correct Transcript and Plot
 of the minutes of said Survey, made by me
 the 2^d day of March 1844 Saml. G. Miller

Dept. Dist. Sur.
 of Grant Co. Mo.