

No. 290.

177

the West half

Range 3 W.

Survey made for Chas. A. Murray, of the North
half of Section 13 in Town 3 N. Range 4 West of the
4th P.M. in Grant Co. W.T.

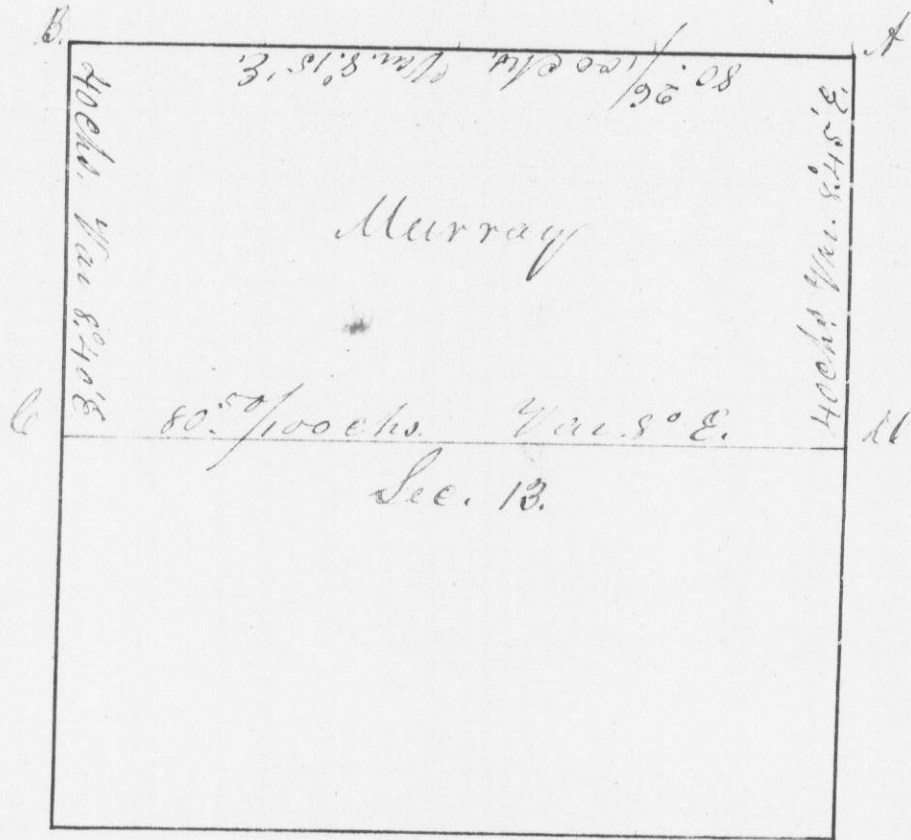

is a true
and correct
survey, made
in 1844.
S. C. Meltzer
Dist. Sur.
Grant Co. W.T.

I hereby certify that the above is a true
and correct representation and statement of the
Minutes of said survey, made by me on the 10th
day of Feb'y. A.D. 1844
Saml. C. Meltzer
Capt. Dist. Surveyor
of Grant Co. W.T.