

No. 202 Surveyed for Samuel Morris

the S.E. of the S.W. qn. of Section No 14 of  
 Township No 2 north of No 3 West of the  
 4<sup>th</sup> principal Meridian on Osceola  
 Island Commencing at the corner of  
 Sections 14. 15 22 & 23 Thence North 20 chs  
 to 1/6<sup>th</sup> sec post Thence East 12.00 chs  
 to Bayou on Grant River Thence E of  
 Van. S.E. down Grant River to a gr. sec.  
 9<sup>th</sup> & Corner between Secs. 14 & 23 thence east  
 40 chs. to the place of beginning  
 the following is a diagram of said  
 Survey

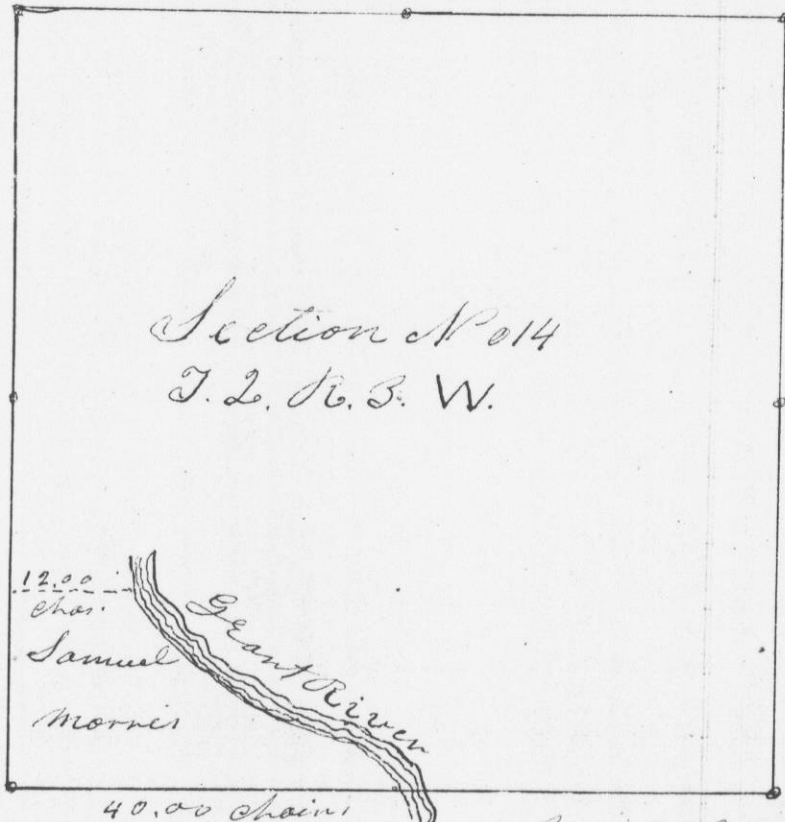

July 27<sup>th</sup> 1842

Jan. E. Freeman  
Dist. Surv. G. L.

Survey  
 Co  
 the S.W.  
 { W.  
 { d  
 Thence  
 from wh  
 Thence  
 which a  
 a d  
 Thence  
 being a  
 a  
 Van  
 Thence  
 to the  
 No

See Survey No. 101 - on Page 53

Survey  
 Co  
 from wh  
 also  
 which  
 a/w. b. s.  
 (B. O. s.)

See Survey for E.C. Sanders on Page 42