

as Martin  
 Section  
 between  
 20.10 chains  
 Secs. 20, 21, 23 &  
 post  
 20.30 chains  
 20 in in Dia  
 Post on  
 Sea.  
 ea. N. 22 E  
 to the  
 E. Freeman  
 Surveyor

Diagram of  
 Surveys made  
 for Henry C. Bush  
 nell & Hugh R. Col  
 ter on the North  
 West quarter &  
 West 1/2 of N. E.  
 quarter of Section  
 No. three of Town  
 No. four of Range  
 four three West  
 of the fourth

(45)

45

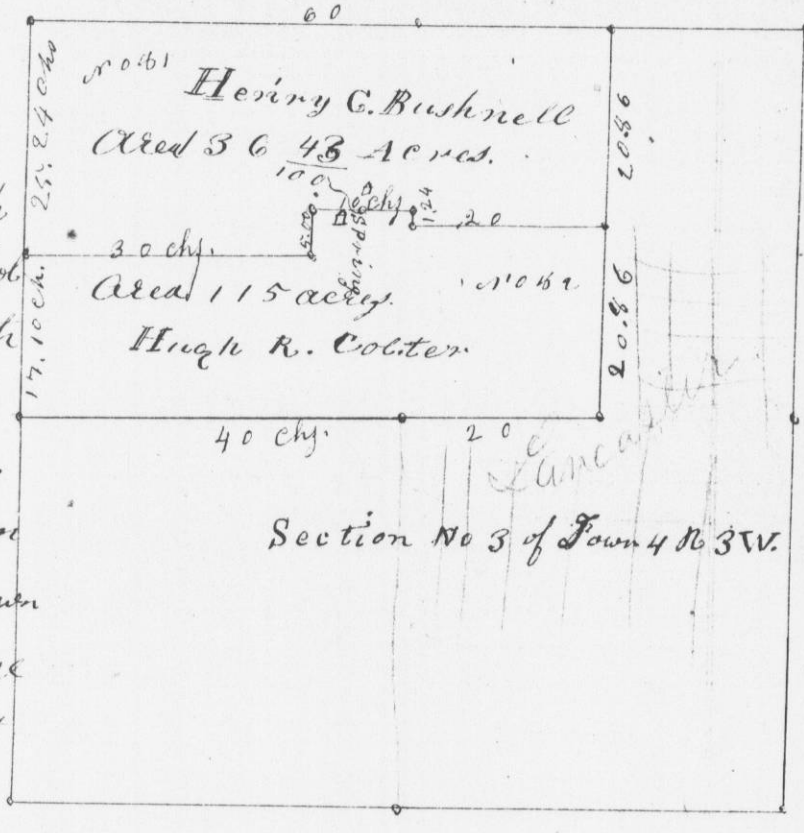

Principal Meridian  
 Commencing at a quarter Section post  
 between Secs 3 & 4 thence 17.20 ch to post  
 from which a W. C. 14 inches in Dia. Bea. N. 60  
 W. 72 Links W. C. 20 in Dia. N. 72 E. 130  
 Thence East 30 ch. W. C. 20 in Dia. Bea.  
 S. 42 W. 103 Links W. C. 14 in Dia S. 45 E. 107 L.  
 Thence 5 chains W. White ash 10 in Dia.  
 Bea. N. 12 E. 17 Links  
 East 10 chains passing through Spring 2.50 ch  
 to post from which Black Walnut 16 in. N. 40 E.  
 156 Links Thence South 124 Chains to post  
 from which a Black Walnut 16 in Dia Bea.  
 S. 77 E. 47 L.  
 Thence east 20 chs. to at corner of the Town  
 Thence South 20.466 to 1/4 Sec. post  
 Thence West 60 chs. to the place of Beginning

I hereby certify that the above is a true  
 Copy of Survey No. 41882 Jas. E. Freeman  
 Oct. 23<sup>d</sup> 1840 Dep. Dist. Surveyor