

all between
at an 14 mil
road running
and distances

- 54 N 54 E 30.00
- 55 N 88 E 12.00
- 56 N 62 " 14.00
- 57 N 42 " 17.00 11 M
- 58 N 42 " 18.00
- 59 N 50 " 36.50
- 60 N 19 1/2 " 22.00
- Dec-26th 61 N 37 E 50.00 12 M
- 62 N 45 1/2 " 36.50
- 63 N 82 " 14.00
- 64 S 88 " 29.50 13 M
- 65 S 88 " 30.00
- 66 S 62 " 25.00

- 67 N 67 E 25.00 14 M
- 68 N 67 " 34.00
- 69 East 42.00
- 70 East 15.00 to Road laid out
- 71 from Lancaster to Burts Mill
- 72 N 51 E 65.00 16 M
- 73 N 51 " 3.00
- 74 N 40 1/2 " 16.00
- 75 N 22 " 4.50 to the end
- 76 of Cherry Street

Jas. E. Freeman
Dept. Dist. Surveyor

16 Arthur's to left
lands to right

16
Lansons to the right

8-16

N. 15 Diagram and
Field Notes of a Survey
made for John Fletcher
on the S. E. q. of Section 3
Town No 4 North Range
No. 3 West of 4th Meridian
Commencing at the Corner
Section post of two. 3. 10. 11 at A

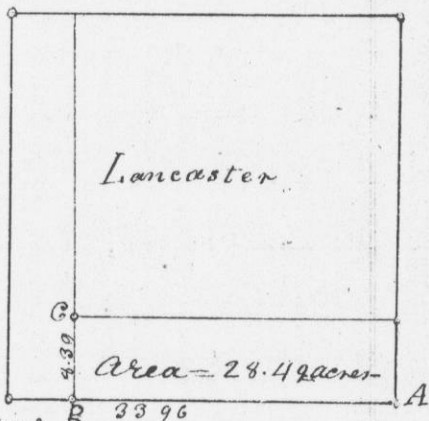

Var =
9° 40'

Thence West 33.96 chains Set post ^{at B} from which a W. C. mark ²⁹
14 in. in Dea. Bea - N 9 1/2 E 372 Links Thence North
4.39 chains to C at the S. W. corner of lot No. 5 of Block No. 40

Calculation . ABX BC ^{links in an acre}
 $33.96 \times 4.39 = 2849.244 \div 100000 = 28.49 \text{ acres}$

Grant River
70 Links course
to right

Dec. 27th 1839

J. E. Freeman
Dept. Dist. Surveyor

12 M