

PLAT OF SURVEY

TRACT 1 DESCRIPTION:

Located in the Northeast Quarter (NE 1/4) of the Northwest Quarter (NW 1/4) of Section Twenty-five (25), Township Five (5) North, Range Five (5) West of the 4th P.M., Town of Bloomington, Grant County, Wisconsin, and being described as follows:

Commencing at a concrete monument marking the North Quarter (N 1/4) corner of said Section 25, said corner being the point of beginning;
 thence South 00° 12' 14" East 709.02 feet along the North-South Quarter (N-S 1/4) line of said Section to a mag nail in the centerline of County Highway "A";
 thence 190.62 feet on the arc of a curve to the left having a radius of 514.83 feet and a long chord bearing North 70° 46' 09" West 189.53 feet along said centerline to a 1/2" steel cotton gin spike;
 thence North 81° 22' 34" West 345.20 feet along said centerline to a 1/2" steel cotton gin spike marking the Northeast corner of that property as described in Document Number 776437, Grant County Registry;
 thence North 81° 28' 20" West 34.32 feet along a line of said property described in Document Number 776437 to a 1/2" steel cotton gin spike in the centerline of County Highway "A";
 thence 174.69 feet on the arc of a curve to the left having a radius of 1000.00 feet and a long chord bearing North 86° 28' 36" West 174.47 feet along a line of said property to a 1/2" steel cotton gin spike in the centerline of County Highway "A";
 thence 262.39 feet on the arc of a curve to the left having a radius of 1000.00 feet and a long chord bearing South 81° 00' 07" West 261.64 feet along the centerline of County Highway "A" to a 1/2" steel cotton gin spike marking the Northeast corner of that property as described in Document Number 816572, Grant County Registry;
 thence 319.87 feet on the arc of a curve to the left having a radius of 840.69 feet and a long chord bearing South 65° 34' 45" West 317.94 feet along a line of said property described in Document Number 816572 to a 1/2" steel cotton gin spike;
 thence South 36° 23' 56" West 82.11 feet along a line of that property as described in Document Number 682266, Grant County Registry to a 1/2" steel cotton gin spike on the West line of the Northeast Quarter (NE 1/4) of the Northwest Quarter (NW 1/4) of said Section 25;
 thence North 00° 06' 25" West 806.47 feet along the West line of the Northeast Quarter (NE 1/4) of said Northwest Quarter (NW 1/4) to a 3/4" rebar marking the Northwest corner thereof;
 thence North 89° 31' 25" East 323.38 feet along the North line of said Section to a 3/4" rebar marking the Northwest corner of Lot 1 of Certified Survey Map Number 1207, recorded as Document Number 684758, Grant County Registry;
 thence South 01° 26' 58" West 344.00 feet along the West line of Lot 1 and Lot 2 of said Certified Survey Map Number 1207 to a 3/4" rebar marking the Southwest corner of said Lot 2;
 thence North 89° 31' 25" East 475.00 feet along the South line of said Lot 2 to a 3/4" rebar marking the Southeast corner thereof;
 thence North 01° 26' 58" East 344.00 feet along the East line of Lot 2 and Lot 1 of said Certified Survey Map Number 1207 to a 3/4" rebar marking the Northeast corner of said Lot 1;
 thence North 89° 31' 25" East 525.62 feet along the North line of said Section 25 to the point of beginning.

Tract being subject to any and all easements of record and/or usage.

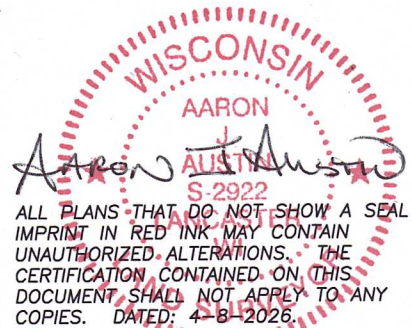

Austin Surveying, LLC

Land Surveying & Septic System Designs
 austinsurveyingllc.com Phone: 608-723-6363
 4211 HWY 81 E, LANCASTER, WI 53813

Prepared for: **SCHILDGEN-HOFFMAN**

JOB NO: 25S292
 H:\CRD\25S292
 H:\PLAT\5NR5W\25\25s292-HOFFMAN

DRAWN BY: AJ AUSTIN
 CREW CHIEF: SHANE AUSTIN
 CREW: O. AUSTIN, T. AUSTIN

SHEET 2 OF 3

PLAT OF SURVEY

TRACT 2 DESCRIPTION:

Located in the Northeast Quarter (NE 1/4) of the Northwest Quarter (NW 1/4) of Section Twenty-five (25), Township Five (5) North, Range Five (5) West of the 4th P.M., Town of Bloomington, Grant County, Wisconsin, and being described as follows:

Commencing at a concrete monument marking the North Quarter (N 1/4) corner of said Section 25; thence South 00° 12' 14" East 709.02 feet along the North-South Quarter (N-S 1/4) line of said Section to a mag nail in the centerline of County Highway "A" and the point of beginning; thence 190.62 feet on the arc of a curve to the left having a radius of 514.83 feet and a long chord bearing North 70° 46' 09" West 189.53 feet along said centerline to a 1/2" steel cotton gin spike; thence North 81° 22' 34" West 345.20 feet along said centerline to a 1/2" steel cotton gin spike marking the Northeast corner of that property as described in Document Number 776437, Grant County Registry; thence South 08° 09' 29" West 205.51 feet along the East line of said property described in Document Number 776437 to a 3/4" rebar marking the Southeast corner thereof; thence North 85° 49' 51" West 208.71 feet along the South line of said property to a 3/4" rebar marking the Southwest corner thereof; thence North 08° 09' 16" East 206.15 feet along the West line of said property to a 1/2" steel cotton gin spike marking the Northwest corner thereof; thence 262.39 feet on the arc of a curve to the left having a radius of 1000.00 feet and a long chord bearing South 81° 00' 07" West 261.64 feet along the centerline of County Highway "A" to a 1/2" steel cotton gin spike marking the Northeast corner of that property as described in Document Number 816572, Grant County Registry; thence South 11° 18' 16" West 213.35 feet along the East line of said property to a 3/4" rebar marking the Southeast corner thereof; thence South 11° 18' 16" West 122.35 feet along the East line of that property as described in Document Number 682266, Grant County Registry to a 3/4" rebar; thence South 22° 45' 51" West 372.50 feet along the East line of said property to a 3/4" rebar; thence South 74° 54' 14" East 140.49 feet along a line of that property as described in Document Number 855385, Grant County Registry to a 3/4" rebar; thence South 17° 35' 33" West 6.65 feet along a line of said property to a 3/4" rebar on the South line of the Northeast Quarter (NE 1/4) of the Northwest Quarter (NW 1/4) of said Section 25; thence North 89° 45' 19" East 1065.28 feet along the South line of the Northeast Quarter (NE 1/4) of the Northwest Quarter (NW 1/4) of said Section to a 5/8" rebar marking the Southeast corner thereof; thence North 00° 12' 14" West 621.98 feet along the North-South Quarter (N-S 1/4) line of said Section to the point of beginning.
Tract being subject to any and all easements of record and/or usage.

SURVEYOR'S CERTIFICATE:

I, Aaron J. Austin, Professional Wisconsin Land Surveyor, hereby certify:

That the descriptions hereon were surveyed, mapped and monumented as shown on this plat by me or under my direct supervision and field work was completed on 4-6-2026.

That this survey was prepared under the instructions of Attorney Doug Heenan.

That this survey complies with Chapter A-E 7 of the Wisconsin Administrative Code and to the best of my knowledge and belief, this plat is an accurate representation thereof.

That all plans that do not show a seal imprint in red ink may contain unauthorized alterations.

The certification contained on this document shall not apply to any copies.

Dated this 8th day of April, 2026.

Aaron J Austin

Aaron J. Austin, PLS-2922

Agent, Austin Surveying, LLC

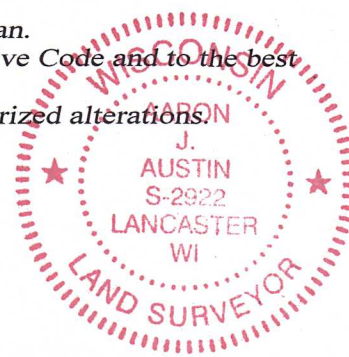

Prepared for: **SCHILDGEN-HOFFMAN**
Austin Surveying, LLC

Land Surveying & Septic System Designs
austinsurveyingllc.com Phone: 608-723-6363
4211 HWY 81 E, LANCASTER, WI 53813

JOB NO: 25S292
H:\CRD\25S292
H:\PLAT\T5NR5W\25\25s292-HOFFMAN

DRAWN BY: AJ AUSTIN
CREW CHIEF: SHANE AUSTIN
CREW: O. AUSTIN, T. AUSTIN

SHEET 3 OF 3