

Plat of Survey (Retracement) of the perimeter of:
 PARCELS #026-00687-0010, #026-00688-0020 & #026-00695-0020 IN TRACT 3
 (PER BOOK 35 PAGE 7) IN SECTION 16; PARCELS #026-00852-0000,
 #026-00854-0000 & #026-00857-0000 IN SECTION 21; PARCELS #026-00799-0000,
 #026-00796-0000 & #026-00792-0010 PER WARRANTY DEED DOC. #564152
 IN SECTION 20, ALL IN T1N, R2W OF THE 4TH P.M.,
 in Town of Jamestown, Grant County, WI

SURVEYOR'S CERTIFICATE
 I, Kenneth L. Buesing, Wisconsin Registered Land Surveyor, hereby certify that the below description was surveyed, mapped, and monumented as shown on this plat by me or under my direct supervision. That the Plat of Survey (Retracement) of the perimeter of PARCELS #026-00687-0010, #026-00688-0020 & #026-00695-0020 IN TRACT 3 (PER BOOK 35 PAGE 7) IN SECTION 16; PARCELS #026-00852-0000, #026-00854-0000 & #026-00857-0000 IN SECTION 21; PARCELS #026-00799-0000, #026-00796-0000 & #026-00792-0010 PER WARRANTY DEED DOC. #564152 IN SECTION 20, ALL IN T1N, R2W OF THE 4TH P.M., IN TOWN OF JAMESTOWN, GRANT COUNTY, WI IN FULL COMPLIANCE WITH CHAPTER A-2.7 OF THE WISCONSIN ADMINISTRATIVE CODE & IS CORRECT TO THE BEST OF MY KNOWLEDGE AND BELIEF. That the Plat of Survey (Retracement) of said PARCELS is subject to any and all easements of record and/or usage. Under the direction of Brian Kane, I have surveyed and mapped the following described land:

Commencing at the SW corner of Section 16, T1N, R2W, said point being the Point of Beginning;
 Thence N 88°47'20" E (bearing is based from Grant County Coordinate System) along the South line of said Section 16, a distance of 1323.45 feet to the most Southerly SE corner of Parcel #026-00684-0020 (also being Tract 1 per Doc. #42007);
 Thence N 02°12'08" W along the most Southerly East line of said Tract 1 per Doc. #42007, a distance of 456.01 feet;
 Thence S 81°11'47" E a distance of 149.57 feet to the Easterly line of said Tract 1 per Doc. #42007;
 Thence N 08°24'00" E along the Easterly line of said Tract 1 per Doc. #42007, a distance of 119.74 feet to the SW corner of Parcel #026-00687-0010 (also being Tract 1 per Book 35, Page 7);
 Thence N 84°30'01" E along the South line of said Tract 1 per Book 35, Page 7, a distance of 344.80 feet on the South line of said Tract 1 per Book 35, Page 7;
 Thence S 65°21'29" E along the South line of said Tract 1 per Book 35, Page 7, a distance of 367.45 feet on the South line of said Tract 1 per Book 35, Page 7;
 Thence S 70°00'38" E along the South line of said Tract 1 per Book 35, Page 7 and Parcel #026-00688-0020, a distance of 345.48 feet;
 Thence N 83°01'16" E along the South line of Parcel #026-00688-0020 and Parcel #026-00695-0020, a distance of 191.52 feet;
 Thence N 56°01'44" E along the South line of Parcel #026-00695-0020, a distance of 247.88 feet to the Northwesterly Right-of-Way (ROW) line of Birchwood Lane;
 Thence S 32°24'15" W along the Northwesterly ROW line of said Lane, a distance of 250.09 feet;
 Thence Southwesterly along the Northwesterly ROW line of said Lane, a distance of 285.69 feet along the arc of a 5523.59 foot radius curve to the right, of which the Chord distance is 285.66 feet and Chord bearing is S 33°42'05" W to the North line of Section 21, T1N, R2W;
 Thence N 88°47'20" E along the North line of said Section 21 and also being the Northwesterly ROW line of said Lane, a distance of 22.01 feet to the N1/4 corner of said Section 21;
 Thence S 01°18'08" E along the North-South 1/4 Section line of said Section 21 and also being the Northwesterly ROW line of said Lane, a distance of 7.09 feet;
 Thence S 37°45'01" West along the Northwesterly ROW line of said Lane, a distance of 18.70 feet;
 Thence Southwesterly along the Northwesterly ROW line of said Lane, a distance of 174.13 feet along the arc of a 733.00 foot radius curve to the left, of which the Chord distance is 173.72 feet and Chord bearing is S 30°42'05" W;
 Thence Southwesterly along the Northwesterly ROW line of said Lane, a distance of 169.39 feet along the arc of a 667.00 foot radius curve to the right, of which the Chord distance is 169.34 feet and Chord bearing is S 31°16'36" W;
 Thence S 38°16'31" West along the Northwesterly ROW line of said Lane, a distance of 88.55 feet;
 Thence S 51°27'34" East along the Northwesterly ROW line of said Lane, a distance of 23.53 feet to the Northwesterly ROW line of Eagle Point Road;
 Thence Southwesterly along the Northwesterly ROW line of said Lane, a distance of 282.81 feet along the arc of a 3689.85 foot radius curve to the right, of which the Chord distance is 282.74 feet and Chord bearing is S 42°42'47" W to the East corner of Parcel #026-00870-0000 per Warranty Deed Doc. #564152;
 Thence N 52°11'59" West along the Northwesterly line of said Warranty Deed Doc. #564152, a distance of 180.24 feet;
 Thence S 89°19'52" West along the North line of said Warranty Deed Doc. #564152, a distance of 68.00 feet;
 Thence S 47°14'58" West along the Northwesterly line of said Warranty Deed Doc. #564152, a distance of 132.00 feet;
 Thence S 42°45'02" East along the Southwesterly line of said Warranty Deed Doc. #564152, a distance of 225.94 feet to the Northwesterly ROW line of Eagle Point Road;
 Thence Southwesterly along the Northwesterly ROW line of said Road, a distance of 667.59 feet along the arc of a 3689.85 foot radius curve to the right, of which the Chord distance is 666.68 feet and Chord bearing is S 53°23'06" W;
 Thence S 58°27'23" West along the Northwesterly ROW line of said Road, a distance of 1749.96 feet to the East line of Section 20, T1N, R2W;
 Thence S 00°05'46" West along the East line of said Section 20 and also being Northwesterly ROW line of said Road, a distance of 23.49 feet;
 Thence S 58°27'23" West along the Northwesterly ROW line of said Road, a distance of 160.17 feet;
 Thence Southwesterly along the Northwesterly ROW line of said Road, a distance of 126.89 feet along the arc of a 2182.01 foot radius curve to the right, of which the Chord distance is 126.87 feet and Chord bearing is S 60°07'21" W to the Northwesterly ROW intersection line of said Road and Bluff Road;
 Thence N 27°38'07" West along the Easterly ROW line of Bluff Road, a distance of 300.00 feet;
 Thence S 62°21'53" West a distance of 50.00 feet to the centerline of Bluff Road and also being the Easterly line of Parcel #026-00812-0000 per CSM #580222;
 Thence N 24°52'35" West along the Easterly line of said CSM #580222 and along Parcel #026-00794-0000, a distance of 156.81 feet;
 Thence N 19°29'34" West along the Easterly line of said Parcel, a distance of 484.73 feet;
 Thence N 29°27'06" West along the Easterly line of said Parcel, a distance of 597.15 feet;
 Thence N 21°45'58" West along the Easterly line of said Parcel, a distance of 273.82 feet to the SW corner of Parcel #026-00792-0000;
 Thence N 89°32'07" East along the South line of said Parcel, a distance of 419.15 feet to the SE corner of said Parcel;
 Thence N 43°23'01" East along the Easterly line of said Parcel, a distance of 190.01 feet;
 Thence N 60°50'00" East along the Easterly line of said Parcel, a distance of 699.48 feet;
 Thence N 00°09'03" West along the Easterly line of said Parcel, a distance of 40.36 feet to the South line of Section 17, T1N, R2W;
 Thence N 89°43'33" East along the South line of said Section 17, a distance of 274.19 feet to the Point of Beginning;
 Total area of boundary surveyed is 120.561 acres.

CURVE DATA

CURVE	DELTA	RADIUS	ARC LENGTH	TAN.	CHORD LENGTH	CHORD BEARING
C1	02°57'48"	5523.59'	285.69'	142.88'	285.66'	S33°53'10" W
C2	13°36'40"	733.00'	174.13'	87.48'	173.72'	S30°42'05" W
C3	14°33'04"	667.00'	169.39'	85.16'	168.94'	S31°16'36" W
C4	18°03'03"	3689.85'	1162.47'	586.09'	1157.67'	S49°32'34" W
C4-A	10°21'59"	3689.85'	667.59'	334.71'	666.68'	S53°23'06" W
C4-B	03°17'35"	3689.85'	212.07'	106.06'	212.04'	S46°33'19" W
C4-C	04°23'29"	3689.85'	282.81'	141.48'	282.74'	S42°42'47" W
C4-D	02°30'59"	3689.85'	162.06'	81.04'	162.05'	S43°39'02" W
C4-E	01°52'30"	3689.85'	120.75'	60.38'	120.75'	S41°27'17" W
C5	03°19'54"	2182.01'	126.89'	63.46'	126.87'	S60°07'21" W

LINE DATA

LINE	BEARING	DISTANCE
L-1	S 38°16'31" W	88.55'(88.55')
L-2	S 51°27'34" E	121.58'(121.58')
L-3	S 51°27'34" E	23.53'
L-4	S 51°27'34" E	98.05'

LEGEND

- FOUND 3/4" IRON ROD (UNLESS OTHERWISE NOTED)
- FOUND 1.5" IRON PIPE (UNLESS OTHERWISE NOTED)
- FOUND GRANT COUNTY ALUMINUM CAP
- ⊗ FOUND 3/4" ROD W/YELLOW CAP MARKED AUSTIN
- ⊕ PLACED MAG NAIL
- ⊖ PLACED 24" x 3/4" IRON ROD BAR MIN. WT. = 1.50 lbs./lin. ft.
- SURVEYED BOUNDARY LINE
- - - PROPERTY LINE
- - - RIGHT OF WAY (ROW) LINE
- - - CENTERLINE
- - - EXISTING FENCE LINE
- POINT OF BEGINNING
- () RECORD DIMENSION
- W/A WITH ANGLE IRON

NOTES

- ALL MEASUREMENTS ARE IN FEET AND DECIMALS THEREOF.
- PROPRIETOR OF PARCELS #026-00687-0010, #026-00852-0000, #026-00854-0000, #026-00857-0000, #026-00799-0000, #026-00796-0000 & #026-00792-0010: W.C. STEWART CONSTRUCTION CO. INC. - PO BOX 49, EAST DUBUQUE, IL 61025-0049
- PROPRIETOR OF PARCELS #026-00688-0020, #026-00695-0020 & #026-00870-0000: WAYNE C. STEWART - PO BOX 49, EAST DUBUQUE, IL 61025-0049
- DATE OF FIELD SURVEY: 1/12, 13 & 21/2026
- TOTAL AREA OF PERIMETER SURVEYED IS 120.561 ACRES.
- THIS PLAT IS SUBJECT TO ALL EASEMENTS OF RECORD AND NOT OF RECORD.

BEARINGS, FOR PURPOSES OF THIS SURVEY, ARE REFERENCED TO THE SOUTH LINE OF THE SW1/4 OF SECTION 16, T1N, R2W, GRANT COUNTY, WI. BEARING N 88°47'20" E IS BASED FROM GRANT COUNTY COORDINATE SYSTEM.

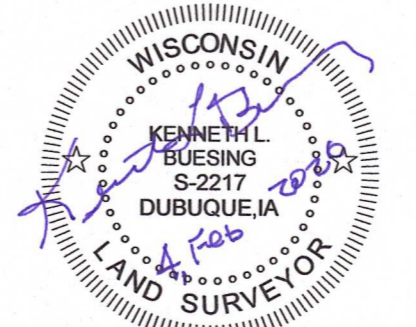

Dated this 4th day of Feb., 2026
 Kenneth L. Buesing, RLS No. S-2217
 Registered Land Surveyor
 My License Renewal Date is January 31, 2028

BUESING
 ENGINEERS AND SURVEYORS
 1212 LOCUST ST., DUBUQUE, IA
 (563) 556-4380

DRAWN BY: JCH CHECKED BY: KLB
 SURVEY DATE: 1/12, 13 & 21/26 PLOT DATE: 2/4/26
 DWG. NO. 25361-01 RP SCALE: 1" = 10'

SHEET 1 OF 1

55010