

PLAT OF SURVEY

Prepared for: BECKI VOIGTS

SURVEYOR'S CERTIFICATE:

I, Aaron J. Austin, Professional Wisconsin Land Surveyor, hereby certify:

That the East line of that property as described in Document Number 776892, Grant County Registry was surveyed, mapped and monumented as shown on this plat by me or under my direct supervision and field work was completed on 10-16-2025.

That this survey was prepared under the instructions of Becki Voigts.

That this survey complies with Chapter A-E 7 of the Wisconsin Administrative Code and to the best of my knowledge and belief, this plat is an accurate representation thereof.

That all plans that do not show a seal imprint in red ink may contain unauthorized alterations. The certification contained on this document shall not apply to any copies.

Dated this 17th day of October, 2025.

Aaron J. Austin
 Aaron J. Austin, PLS-2922
 Agent, Austin Surveying, LLC



TRACT 4
 PREVIOUS SURVEY
 BOOK: 44, PAGE: 34

LEGEND

- Section Corner
- 3/4" x 18" rebar set with cap
- 3/4" rebar found
- ⊙ Mag nail found
- () Recorded as
- [] Property described in Document Number, Grant County Registry
- Boundary of Survey
- - - Section line
- - - Right of Way
- - - Previously surveyed line
- - - Existing Improvement
- - - Existing mow line

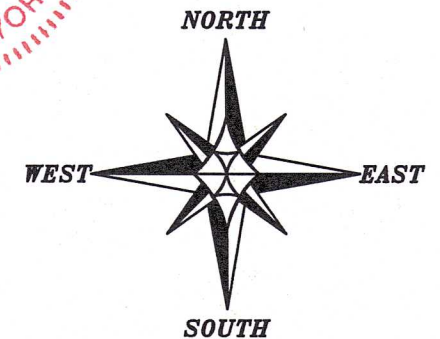

The East-West 1/4 line of Section 1 bears S 89°53'57" W according to the Grant County Coordinate System WISCORS NAD 83 (2011) which was determined by G.P.S. observation.

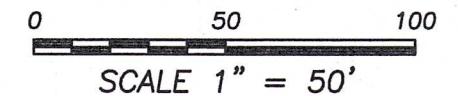

WEST 1/4 CORNER
 SECTION 1, T2N R1W
 Aluminum Capped
 rebar and ties found.

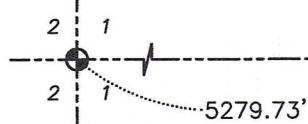

EAST 1/4 CORNER
 SECTION 1, T2N R1W
 Aluminum Capped
 rebar and ties found.

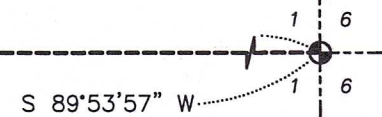

Austin Surveying, LLC
 Land Surveying & Septic System Designs
 austinsurveyingllc.com Phone: 608-723-6363
 4211 HWY 81 E, LANCASTER, WI 53813

