

PLAT OF SURVEY

LOCATED IN THE VILLAGE OF BLOOMINGTON

ALL PLANS THAT DO NOT SHOW A SEAL IMPRINT IN RED INK MAY CONTAIN UNAUTHORIZED ALTERATIONS. THE CERTIFICATION CONTAINED ON THIS DOCUMENT SHALL NOT APPLY TO ANY COPIES. DATED: 6-5-2025.

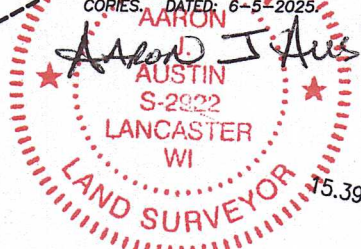

NORTH 1/4 CORNER SECTION 23, T5N R5W
Aluminum Capped rebar and ties found.

PARCEL 2
WARRANTY DEED [525791]
AFFIDAVIT [526274]

PARCEL 2
PREVIOUS SURVEY
BY DAVID DAVIS
DATED 12-18-1981
BOOK: H, PAGE: 103

PREVIOUS SURVEY
BY LARRY AUSTIN
DATED 10-11-2004
BOOK: 16, PAGE: 12

PARCEL 4
WARRANTY DEED [525791]
AFFIDAVIT [605386]

PREVIOUS SURVEY
BY DAVID DAVIS
DATED 11-30-1982
BOOK: H, PAGE: 130

PARCEL 3
WARRANTY DEED [525791]
AFFIDAVIT [526274]

PARCEL 3
PREVIOUS SURVEY
BY DAVID DAVIS
DATED 12-18-1981
BOOK: H, PAGE: 103

N 00°25'16" W 5295.24'

(N 65°30'40" W) (272.57')
N 65°51'14" W 273.43'

FENCE CORNER
CALLED FOR IN
[525791]

(S 22°50' W) (234')
S 22°31'05" W 235.32'

ASSESSORS
PLAT NO. 1

59
[798829]

(N 78°15' W) (139.3')
N 78°50'11" W 139.30'

(N 83° E)
66.00'

BOBTOWN STREET

STREET

FOURTH

N 72°40'49" E 210.50'
(S 73°16' W) (210.5')

ASSESSORS
PLAT NO. 1

1.55± ACRES
67,480± SQ.FT.

BLOCK "B"

SECOND PLAT

BLOCK "A"

SOUTH 1/4 CORNER SECTION 23, T5N R5W
Aluminum Monument and ties found.

S.T.H. #133

LEGEND

- ⊙ Section Corner
- 3/4" x 18" rebar set with cap
- ⊙ 1/2" x 4 3/4" Steel Cotton Gin Spike set
- 3/4" rebar found
- ▲ 1" diameter iron pipe found
- ▲ 1 1/2" diameter iron pipe found
- ▲ Angle iron post in concrete
- ⊙ 2" Pipe post
- No monument set
- () Recorded as
- [] Property described in Document Number, Grant County Registry
- Boundary of Survey
- - - Section line
- - - Centerline
- - - Platted line
- - - Previously surveyed line
- ▨ Existing structure

The North-South 1/4 line of Section 23 bears N 00°25'16" W according to the Grant County Coordinate System WISCONSIN NAD 83 (2011) which was determined by G.P.S. observation.

Right of Way per 5580-01-21

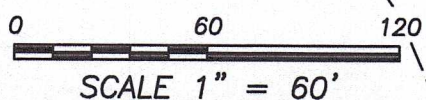

SCALE 1" = 60'

Prepared for: TOWN OF BLOOMINGTON



Austin Surveying, LLC
Land Surveying & Septic System Designs
austinsurveyingllc.com Phone: 608-723-6363
4211 HWY 81 E, LANCASTER, WI 53813

JOB NO: 255034
H:\CRD\255034
H:\PLAT\BLOOMGTN\255034-BLOOMINGTON

DRAWN BY: AJ AUSTIN
CREW CHIEF: SHANE AUSTIN
CREW: O. AUSTIN, T. AUSTIN

PLAT OF SURVEY

DESCRIPTION OF SURVEY:

Located in the Southwest Quarter (SW 1/4) of the Southeast Quarter (SE 1/4) of Section Twenty-three (23) and in the Northwest Quarter (NW 1/4) of the Northeast Quarter (NE 1/4) of Section Twenty-six (26), Township Five (5) North, Range Five (5) West of the 4th P.M., Village of Bloomington, Grant County, Wisconsin, and being described as follows:

Commencing at an aluminum monument marking the South Quarter (S 1/4) corner of said Section 23; thence North 00° 25' 16" West 73.08 feet along the North-South Quarter (N-S 1/4) line of said Section;
thence North 89° 34' 44" East 610.61 feet to a 1/2" steel cotton gin spike marking a corner of Lot 61 of the Assessors Plat No. 1 of the Village of Bloomington, according to the recorded map or plat thereof and the point of beginning;
thence North 72° 40' 49" East 210.50 feet along a line of said Lot 61 to a 1/2" steel cotton gin spike;
thence South 78° 50' 11" East 123.20 feet along a line of Lot 61 and Lot 60 of said Assessors Plat to a 3/4" rebar;
thence North 82° 24' 49" East 64.70 feet along a line of said Lot 60 to a 3/4" rebar;
thence South 12° 45' 28" West 141.59 feet along a line of said Lot 60 to a 3/4" rebar;
thence South 11° 29' 28" West 194.27 feet along a line of said Lot 61 to a 3/4" rebar;
thence North 48° 20' 35" West 422.93 feet along a line of said Lot 61 to the point of beginning.
Tract being subject to any and all easements of record and/or usage.

SURVEYOR'S CERTIFICATE:

I, Aaron J. Austin, Professional Wisconsin Land Surveyor, hereby certify:

That the above description was surveyed, mapped and monumented as shown on this plat by me or under my direct supervision and field work was completed on 5-7-2025.
That this survey was prepared under the instructions of Jane Patterson.
That this survey complies with Chapter A-E 7 of the Wisconsin Administrative Code and to the best of my knowledge and belief, this plat is an accurate representation thereof.
That all plans that do not show a seal imprint in red ink may contain unauthorized alterations.
The certification contained on this document shall not apply to any copies.

Dated this 5th day of June, 2025.

AARON J. AUSTIN
Aaron J. Austin, PLS-2922
Agent, Austin Surveying, LLC



Austin Surveying, LLC
Land Surveying & Septic System Designs
austinsurveyingllc.com Phone: 608-723-6363
4211 HWY 81 E, LANCASTER, WI 53813

Prepared for: TOWN OF BLOOMINGTON

JOB NO: 25s034
H:\CRD\25s034
H:\PLAT\BLOOMGTN\25S034-BLOOMINGTON

DRAWN BY: AJ AUSTIN
CREW CHIEF: SHANE AUSTIN
CREW: O. AUSTIN, T. AUSTIN