

LEGEND

- ⊙ Section Corner
- 3/4" rebar found
- 3/4" x 18" rebar set with cap
- () Recorded as
- [] Property described in Document Number, Grant County Registry
- Boundary of Survey
- - - Section line
- Centerline
- - - Right of Way
- - - Previously surveyed line
- ***** Existing fence
- ~~~~~ Edge of field

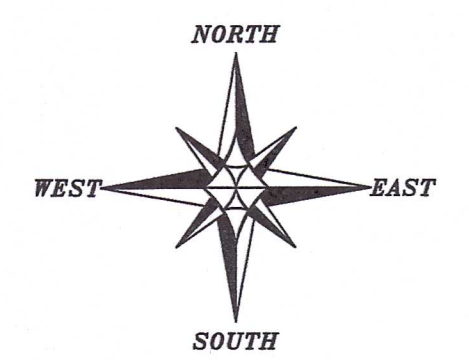

The East-West 1/4 line of Section 16 bears N 88°34'45" W according to the Grant County Coordinate System WISCORS NAD 83 (2011) which was determined by G.P.S. observation.

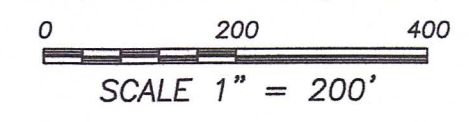

SURVEYOR'S CERTIFICATE:
I, Aaron J. Austin, Professional Wisconsin Land Surveyor, hereby certify:

That the above description was surveyed, mapped and monumented as shown on this plat by me or under my direct supervision and field work was completed on 4-29-2025.
That this survey was prepared under the instructions of Amos King.
That this survey complies with Chapter A-E 7 of the Wisconsin Administrative Code and to the best of my knowledge and belief, this plat is an accurate representation thereof.
That all plans that do not show a seal imprint in red ink may contain unauthorized alterations.
The certification contained on this document shall not apply to any copies.

Dated this 2nd day of May, 2025.

Aaron J. Austin
Aaron J. Austin, PLS-2922
Agent, Austin Surveying, LLC



PLAT OF SURVEY
PREPARED FOR: AMOS KING
LOCATED IN SECTIONS 15 & 16, T7N R2W,
TOWN OF HICKORY GROVE, GRANT CO., WI

Austin Surveying, LLC
Land Surveying & Septic System Designs
austinsurveyingllc.com Phone: 608-723-6363
4211 HWY 81 E, LANCASTER, WI 53813

JOB NO: 255028
H:\CRD\255028
H:\PLAT\T7NR2W\15\255028-KING
DRAWN BY: AJ AUSTIN
CREW CHIEF: SHANE AUSTIN
CREW: O. AUSTIN, T. AUSTIN
SHEET 1 OF 2

MAY 30 2025
53091

PLAT OF SURVEY

DESCRIPTION:

Located in the Northwest Quarter (NW 1/4) of the Northwest Quarter (NW 1/4) and the Southwest Quarter (SW 1/4) of the Northwest Quarter (NW 1/4) of Section Fifteen (15) and in the Northeast Quarter (NE 1/4) of the Northeast Quarter (NE 1/4) and the Southeast Quarter (SE 1/4) of the Northeast Quarter (NE 1/4) of Section Sixteen (16), Township Seven (7) North, Range Two (2) West of the 4th P.M., Town of Hickory Grove, Grant County, Wisconsin, and being described as follows:

Commencing at a 1" rebar marking the East Quarter (E 1/4) corner of said Section 16;
 thence North 88° 34' 45" West 268.74 feet along the East-Quarter (E-W 1/4) line of said Section 16 to a 3/4" rebar marking the point of beginning;
 thence continuing North 88° 34' 45" West 1062.48 feet along said East-West Quarter (E-W 1/4) line to the Southwest corner of the Southeast Quarter (SE 1/4) of the Northeast Quarter (NE 1/4) of said Section 16 to a 3/4" rebar marking the Southwest corner thereof;
 thence North 00° 31' 44" West 1845.66 feet along the West line of the East Half (E 1/2) of the Northeast Quarter (NE 1/4) of said Section 16 to a 3/4" rebar marking a corner of that property as described in Document Number 745391, Grant County Registry;
 thence South 67° 55' 33" East 397.10 feet along a line of said property to a 3/4" rebar;
 thence South 38° 01' 22" East 301.42 feet along a line of said property to a 3/4" rebar;
 thence South 44° 19' 54" East 124.94 feet along a line of said property to a 3/4" rebar;
 thence South 88° 32' 17" East 358.64 feet along a line of said property to a 3/4" rebar;
 thence North 06° 36' 39" East 137.18 feet along a line of said property to a 3/4" rebar;
 thence North 13° 48' 07" West 171.32 feet along a line of said property to a 3/4" rebar;
 thence North 06° 16' 49" West 81.95 feet along a line of said property to a 3/4" rebar;
 thence North 04° 50' 38" East 112.24 feet along a line of said property to a 3/4" rebar;
 thence North 05° 42' 30" East 80.99 feet along a line of said property to a 3/4" rebar;
 thence North 07° 29' 46" East 119.05 feet along a line of said property to a 3/4" rebar;
 thence North 13° 54' 15" East 90.13 feet along a line of said property to a 3/4" rebar;
 thence North 29° 29' 24" East 41.33 feet along a line of said property to a 3/4" rebar;
 thence North 50° 28' 39" East 91.95 feet along a line of said property to a 3/4" rebar;
 thence North 45° 21' 00" East 134.00 feet along a line of said property to a 3/4" rebar;
 thence North 35° 41' 27" East 120.05 feet along a line of said property to a 3/4" rebar;
 thence North 41° 24' 02" East 71.20 feet along a line of said property to a 3/4" rebar;
 thence North 75° 38' 56" East 112.90 feet along a line of said property to a 3/4" rebar;
 thence South 46° 05' 55" East 34.86 feet along a line of said property to a 3/4" rebar;
 thence South 00° 59' 42" East 24.42 feet along a line of said property to a 3/4" rebar;
 thence South 28° 14' 01" East 138.20 feet along a line of said property to a 3/4" rebar;
 thence South 75° 08' 01" East 183.78 feet along a line of said property to a 3/4" rebar;
 thence South 29° 20' 46" East 263.34 feet along a line of said property to a 3/4" rebar;
 thence South 23° 29' 17" East 313.98 feet along a line of said property to a 3/4" rebar;
 thence South 10° 35' 52" East 263.59 feet along a line of said property to a 3/4" rebar;
 thence South 10° 58' 58" West 233.99 feet along a line of said property to a 3/4" rebar on the North line of the Southwest Quarter (SW 1/4) of the Northwest Quarter (NW 1/4) of said Section 15;
 thence South 89° 22' 49" East 710.78 feet along said North line to a 3/4" rebar marking the Northeast corner thereof;
 thence South 00° 24' 26" East 1085.72 feet along the East line of the Southwest Quarter (SW 1/4) of said Northwest Quarter (NW 1/4) to a 3/4" rebar;
 thence North 83° 34' 27" West 730.98 feet to a 3/4" rebar;
 thence North 77° 38' 06" West 893.54 feet to a 3/4" rebar;
 thence South 492.29 feet to the point of beginning.

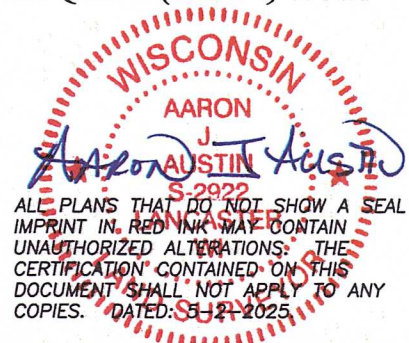

Austin Surveying, LLC

Land Surveying & Septic System Designs
 austinsurveyingllc.com Phone: 608-723-6363
 4211 HWY 81 E, LANCASTER, WI 53813

Prepared for: **AMOS KING**

JOB NO: 25S028
 H:\CRD\25S028
 H:\PLAT\T7NR2W\15\22S028-KING

DRAWN BY: AJ AUSTIN
 CREW CHIEF: SHANE AUSTIN
 CREW: O. AUSTIN, T. AUSTIN