

CENTER SECTION 3
Mag nail and ties found
N:524335.65
E:817985.71

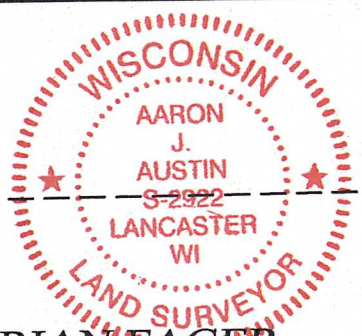

Prepared for: **BRIAN FAGER**

DESCRIPTION PROVIDED:
DOCUMENT NUMBER 847471, GRANT COUNTY REGISTRY AND BEING DESCRIBED AS FOLLOWS:
Commencing at a point 160 feet West and 120 feet North of the intersection of North and South centerline of Section 3, T4N, R3W of the 4th P.M., in Grant County, Wisconsin, with the North boundary of Cherry Street in the City of Lancaster, Grant County, Wisconsin;
thence West 130 feet;
thence North 60 feet;
thence East 130 feet;
thence South 60 feet to the place of beginning.
Said lands are also described as a part of Lot Three (3) of Block Thirty-one (31) of the Assessment Plat of the City of Lancaster, Grant County, Wisconsin.

SURVEYOR'S CERTIFICATE:
I, Aaron J. Austin, Professional Wisconsin Land Surveyor, hereby certify: That the above description was surveyed, mapped and monumented as shown on this plat by me or under my direct supervision and field work was completed on 4-17-2025. That this survey was prepared under the instructions of Brian Fager. That this survey complies with Chapter A-E 7 of the Wisconsin Administrative Code and to the best of my knowledge and belief, this plat is an accurate representation thereof.
Dated this 18th day of April, 2025.
All plans that do not show a seal imprint in red ink may contain unauthorized alterations. The certification contained on this document shall not apply to any copies.

Aaron J. Austin
Aaron J. Austin, PLS-2922
Agent, Austin Surveying, LLC

LEGEND			
⊕	Section Corner	()	Recorded as
●	3/4" x 18" rebar set	—	Boundary of Survey
○	3/4" rebar found	- - -	Section line
△	1" dia. iron pipe found	- · - · -	Centerline
⊙	PK Nail found	- - - - -	Assessment Plat line
⊗	Drill hole found	- · - · -	Previously surveyed line
⊘	Utility pole	- · - · -	Existing sidewalk
⊞	Telephone pedestal	▤▤▤▤▤	Existing Structure
⊗	Existing manhole		

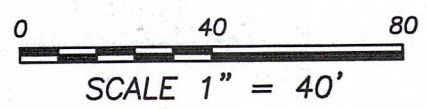

Austin Surveying, LLC
Land Surveying & Septic System Designs
austinsurveyingllc.com Phone: 608-723-6363
4211 HWY 81 E, LANCASTER, WI 53813

R/W PROJECT NO:
5215-00-21

SOUTH 1/4 CORNER
SECTION 3, T4N R3W
1.25" Rebar and ties found

The East line of the SW 1/4 of Section 3 bears N 01°14'56" W according to the Grant County Coordinate System WISCONSIN NAD 83 (2011) which was determined by G.P.S. observation.

53084 MAY 16 2025