

GRANT COUNTY PLAT OF SURVEY

BEING LOCATED IN PART OF THE NORTHWEST QUARTER OF THE SOUTHEAST QUARTER AND PART OF THE NORTHEAST QUARTER OF THE SOUTHEAST QUARTER OF SECTION 22, TOWNSHIP 8 NORTH, RANGE 1 WEST, TOWN OF MUSCODA, GRANT COUNTY WISCONSIN.

SURVEY PREPARED FOR:
LEVI & SALLY HEFFNER
 1149 SAND BRANCH ROAD
 MUSCODA, WI 53573

DESCRIPTION

ALL THAT PART OF THE NORTHWEST QUARTER OF THE SOUTHEAST QUARTER AND PART OF THE NORTHEAST QUARTER OF THE SOUTHEAST QUARTER OF SECTION 22, TOWNSHIP 8 NORTH, RANGE 1 WEST, TOWN OF MUSCODA, GRANT COUNTY WISCONSIN MORE PARTICULARLY DESCRIBED AS FOLLOWS:

COMMENCING AT THE SOUTH QUARTER CORNER OF SAID SECTION 22;
 THENCE NORTH 89°13'22" EAST, ALONG THE SOUTH LINE OF SAID SOUTHEAST QUARTER, 771.33 FEET;
 THENCE NORTH 00°46'38" WEST, 1997.52 FEET TO THE POINT OF BEGINNING OF THE LANDS HEREINAFTER DESCRIBED;
 THENCE NORTH 00°12'20" EAST, 447.61 FEET TO A POINT ON THE CENTERLINE OF SAND BRANCH ROAD, SAID POINT ALSO BEING ON THE ARC OF A 2644.00 FOOT RADIUS CURVE, CONCAVE TO THE SOUTH;
 THENCE EASTERLY, 112.02 FEET ALONG SAID CENTERLINE AND THE ARC OF SAID CURVE WITH A CENTRAL ANGLE OF 02°59'39" AND A CHORD BEARING NORTH 84°52'30" EAST, 112.01;
 THENCE NORTH 86°05'20" EAST, ALONG SAID CENTERLINE, 419.70 FEET TO THE POINT OF CURVATURE OF A 998.18 FOOT RADIUS CURVE, CONCAVE TO THE NORTH;
 THENCE EASTERLY, 77.32 FEET ALONG SAID CENTERLINE AND THE ARC OF SAID CURVE WITH A CENTRAL ANGLE OF 04°26'18" AND A CHORD BEARING NORTH 82°48'38" EAST, 77.30 FEET;
 THENCE SOUTH 00°03'21" EAST, 33.43 FEET TO A POINT ON THE SOUTHERLY RIGHT-OF-WAY OF HICKORY FLATS ROAD;
 THENCE NORTH 79°05'50" EAST, ALONG SAID RIGHT-OF-WAY, 29.52 FEET TO THE POINT OF CURVATURE OF A 137.00 FOOT RADIUS CURVE, CONCAVE TO THE SOUTHWEST;
 THENCE SOUTHEASTERLY, 242.88 FEET ALONG SAID CENTERLINE AND THE ARC OF SAID CURVE WITH A CENTRAL ANGLE OF 101°34'37" AND A CHORD BEARING SOUTH 50°26'33" EAST, 212.30 FEET TO THE END OF SAID CURVE;
 THENCE SOUTH 00°18'41" WEST, ALONG SAID RIGHT-OF-WAY, 50.74 FEET;
 THENCE SOUTH 08°47'57" WEST, ALONG SAID RIGHT-OF-WAY, 77.93 FEET;
 THENCE SOUTH 75°08'26" WEST, 694.80 FEET;
 THENCE SOUTH 77°05'29" WEST, 120.57 FEET TO THE POINT OF BEGINNING.

SURVEY PREPARED BY:
 SEAN M WALSH, PLS 2016

WALSH SURVEYING - MAPPING
GEOMATICS, LLC PO BOX 486, RICHLAND CENTER, WI 53581
 608-383-1501 (O) 608-347-9307 (M)

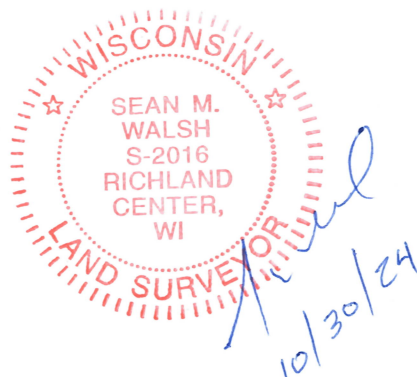

I SEAN M. WALSH, WISCONSIN PROFESSIONAL LAND SURVEYOR DO HEREBY CERTIFY THAT:

I HAVE MADE THIS SURVEY UNDER THE DIRECTION OF LEVI HEFFNER, OWNER;

THIS SURVEY IS IN FULL COMPLIANCE WITH THE PROVISIONS OF CHAPTER A-E 7 OF THE WISCONSIN ADMINISTRATIVE CODE;
 THE INFORMATION SHOWN HEREON IS CORRECT TO THE BEST OF MY INFORMATION, KNOWLEDGE AND BELIEF.
 FIELD WORK COMPLETED ON 10/30/2024

