

**DESCRIPTION:**  
 Located in the Northwest Quarter (NW 1/4) of the Southwest Quarter (SW 1/4), the Northeast Quarter (NE 1/4) of the Southwest Quarter (SW 1/4), the Southeast Quarter (SE 1/4) of the Southwest Quarter (SW 1/4) and the Southwest Quarter (SW 1/4) of the Southwest Quarter (SW 1/4) of Section Four (4), Township Five (5) North, Range Two (2) West of the 4th P.M., Town of Liberty, Grant County, Wisconsin, and being described as follows:

Commencing at the South Quarter (S 1/4) corner of said Section 4, said corner being the point of beginning;  
 thence North 89° 46' 19" West 1671.50 feet along the South line of said Section to a point in the centerline of the former railroad;  
 thence North 21° 17' 30" West 448.90 feet along the centerline of the former railroad;  
 thence 637.86 feet on the arc of a curve to the left having a radius of 955.37 feet and a long chord bearing North 40° 25' 07" West 626.08 feet along the centerline of the former railroad;  
 thence North 59° 32' 46" West 16.22 feet along the centerline of the former railroad to a point in the centerline of County Highway "F";  
 thence North 84° 19' 58" East 41.65 feet;  
 thence 227.61 feet on the arc of a curve to the right having a radius of 740.00 feet and a long chord bearing South 86° 51' 20" East 226.72 feet;  
 thence South 78° 02' 38" East 62.07 feet;  
 thence 81.56 feet on the arc of a curve to the right having a radius of 365.00 feet and a long chord bearing South 71° 38' 32" East 81.39 feet;  
 thence 83.30 feet on the arc of a curve to the left having a radius of 125.00 feet and a long chord bearing South 84° 19' 50" East 81.76 feet;  
 thence North 76° 34' 47" East 42.58 feet;  
 thence 114.93 feet on the arc of a curve to the left having a radius of 170.00 feet and a long chord bearing North 57° 12' 43" East 112.75 feet;  
 thence North 37° 50' 39" East 332.28 feet;  
 thence North 09° 10' 31" East 16.93 feet;  
 thence 266.62 feet on the arc of a curve to the left having a radius of 1140.00 feet and a long chord bearing North 02° 28' 31" East 266.01 feet;  
 thence North 04° 13' 29" West 214.65 feet;  
 thence 547.49 feet on the arc of a curve to the right having a radius of 1090.00 feet and a long chord bearing North 10° 09' 53" East 541.76 feet;  
 thence North 24° 33' 15" East 492.04 feet to a point on the North line of the Southwest Quarter (SW 1/4);  
 thence South 89° 32' 05" East 1126.18 feet along said North line to the Northeast corner thereof;  
 thence South 00° 03' 21" East 2656.42 feet along the East line of the Southwest Quarter (SW 1/4) to the point of beginning.  
 Tract being subject to any and all easements of record and/or usage.

**DESCRIPTION OF EASEMENT:**  
 A Sixty-six (66) foot wide access easement for ingress-egress which is located in the Southwest Quarter (SW 1/4) of the Southwest Quarter (SW 1/4) of Section Four (4), Township Five (5) North, Range Two (2) West of the 4th P.M., Town of Liberty, Grant County, Wisconsin, said easement being located 36 feet Northerly of and 30 feet Southerly of the following described reference line:

Commencing at the South Quarter (S 1/4) corner of said Section 4;  
 thence North 89° 46' 19" West 1671.50 feet along the South line of said Section to a point in the centerline of the former railroad;  
 thence North 21° 17' 30" West 448.90 feet along the centerline of the former railroad;  
 thence 637.86 feet on the arc of a curve to the left having a radius of 955.37 feet and a long chord bearing North 40° 25' 07" West 626.08 feet along the centerline of the former railroad;  
 thence North 59° 32' 46" West 16.22 feet along the centerline of the former railroad to a point in the centerline of County Highway "F" and the point of beginning;  
 thence North 84° 19' 58" East 41.65 feet;  
 thence 227.61 feet on the arc of a curve to the right having a radius of 740.00 feet and a long chord bearing South 86° 51' 20" East 226.72 feet;  
 thence South 78° 02' 38" East 62.07 feet;  
 thence 81.56 feet on the arc of a curve to the right having a radius of 365.00 feet and a long chord bearing South 71° 38' 32" East 81.39 feet;  
 thence 83.30 feet on the arc of a curve to the left having a radius of 125.00 feet and a long chord bearing South 84° 19' 50" East 81.76 feet;  
 thence North 76° 34' 47" East 42.58 feet to the terminus point.

**EASEMENT NOTES:**  
 Other documentation will need to be recorded to clarify the intent, use, maintenance, assignments or other pertinent information of this easement.

**SURVEYOR'S CERTIFICATE:**  
 I, Aaron J. Austin, Professional Wisconsin Land Surveyor, hereby certify:

That the above description was surveyed, mapped and monumented as shown on this plat by me or under my direct supervision and field work was completed on 7-3-2024.  
 That this survey was prepared under the instructions of Abner Fisher.  
 That this survey complies with Chapter A-E 7 of the Wisconsin Administrative Code and to the best of my knowledge and belief, this plat is an accurate representation thereof.  
 That all plans that do not show a seal imprint in red ink may contain unauthorized alterations.  
 The certification contained on this document shall not apply to any copies.

Dated this 19th day of July, 2024.  
 Aaron J. Austin  
 Aaron J. Austin, S-2922  
 Agent, Austin Surveying, LLC

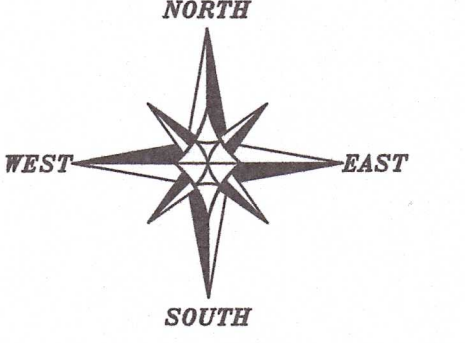
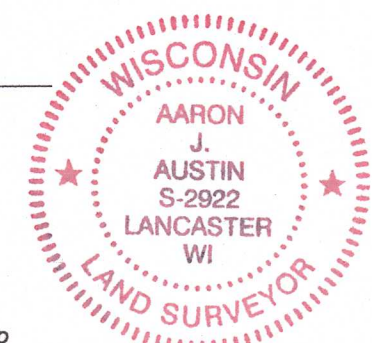

- LEGEND**
- Section Corner
  - ⊙ 3/4" x 18" rebar set with cap
  - ⊙ 1/2" x 4 3/4" Steel Cotton Gin Spike set
  - ( ) Recorded as
  - [ ] Property described in Document Number, Grant County Registry
  - Boundary of Survey
  - - - Section line
  - - - Centerline
  - - - Right of Way
  - - - Proposed Easement
  - - - Previously surveyed line
  - - - Former railroad right of way
  - - - Existing fence

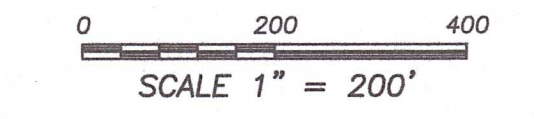

The South line of the SW 1/4 of Section 4 bears N 89°46'19" W according to the Grant County Coordinate System WISCORS NAD 83 (2011) which was determined by G.P.S. observation.

**PLAT OF SURVEY**  
 PREPARED FOR: ABNER FISHER  
 LOCATED IN SECTION 4, T5N R2W, TOWN OF LIBERTY, GRANT COUNTY, WISCONSIN

**Austin Surveying, LLC**  
 Land Surveying & Septic System Designs  
 austinurveyingllc.com Phone: 608-723-6363  
 4211 HWY 81 E, LANCASTER, WI 53813

JOB NO: 24S049  
 H:\CRD\24S049  
 H:\PLAT\T5NR2W\04\24S049-FISHER

DRAWN BY: AJ AUSTIN  
 CREW CHIEF: SHANE AUSTIN  
 CREW: O. AUSTIN, T. AUSTIN

SHEET 1 OF 1

AUG 01 2024 67025