

PLAT OF SURVEY

TRACT 1 DESCRIPTION:

Located in the Northeast Quarter (NE 1/4) of the Northwest Quarter (NW 1/4) and the Northwest Quarter (NW 1/4) of the Northeast Quarter (NE 1/4) of Section Twenty-seven (27), Township Seven (7) North, Range Three (3) West of the 4th P.M., Town of Marion, Grant County, Wisconsin, and being described as follows:

Commencing at the North Quarter (N 1/4) corner of said Section, said corner being the point of beginning;
thence North 89° 59' 39" East 1328.05 feet along the North line of the Northwest Quarter (NW 1/4) of the Northeast Quarter (NE 1/4) to the Northeast corner thereof;
thence South 00° 11' 23" East 752.55 feet along the East line of the Northwest Quarter (NW 1/4) of said Northeast Quarter (NE 1/4);
thence North 89° 59' 58" West 942.78 feet;
thence North 31° 19' 43" West 381.75 feet;
thence continuing North 31° 19' 43" West 68.99 feet;
thence 46.75 feet on the arc of a curve to the right having a radius of 182.00 feet and a long chord bearing North 23° 58' 10" West 46.62 feet;
thence North 16° 36' 37" West 18.53 feet;
thence 86.28 feet on the arc of a curve to the left having a radius of 325.00 feet and a long chord bearing North 24° 12' 55" West 86.02 feet;
thence North 31° 49' 12" West 44.03 feet;
thence 122.87 feet on the arc of a curve to the right having a radius of 685.00 feet and a long chord bearing North 26° 40' 53" West 122.71 feet;
thence North 21° 32' 33" West 87.62 feet to the North line of said Section 27;
thence North 89° 57' 42" East 16.60 feet along the North line of said Section to the point of beginning.

TRACT 2 DESCRIPTION:

Located in the Northeast Quarter (NE 1/4) of the Northeast Quarter (NE 1/4) of Section Twenty-seven (27), Township Seven (7) North, Range Three (3) West of the 4th P.M., Town of Marion, Grant County, Wisconsin, and being described as follows:

Commencing at the North Quarter (N 1/4) corner of said Section;
thence North 89° 59' 39" East 1328.05 feet along the North line of the Northwest Quarter (NW 1/4) of the Northeast Quarter (NE 1/4) to the Northeast corner thereof and the point of beginning;
thence South 00° 11' 23" East 752.55 feet along the East line of the Northwest Quarter (NW 1/4) of said Northeast Quarter (NE 1/4);
thence North 03° 16' 06" East 753.78 feet to the North line of said Section;
thence South 89° 59' 39" West 45.47 feet along the North line of said Section to the point of beginning.



Aaron J. Austin

ALL PLANS THAT DO NOT SHOW A SEAL IMPRINT IN RED INK MAY CONTAIN UNAUTHORIZED ALTERATIONS. THE CERTIFICATION CONTAINED ON THIS DOCUMENT SHALL NOT APPLY TO ANY COPIES. DATED: 6-19-2024.

Prepared for: **JACOB STOLTZFUS**



Austin Surveying, LLC

Land Surveying & Septic System Designs
austinsurveyingllc.com Phone: 608-723-6363
4211 HWY 81 E, LANCASTER, WI 53813

JOB NO: 24S085
H:\CRD\24S085
H:\PLAT\T7NR3W\27\24S085-STOLTZFUS

DRAWN BY: AJ AUSTIN
CREW CHIEF: SHANE AUSTIN
CREW: O. AUSTIN, T. AUSTIN

PLAT OF SURVEY

TRACT 3 DESCRIPTION:

Located in the Northeast Quarter (NE 1/4) of the Northwest Quarter (NW 1/4), the Southeast Quarter (SE 1/4) of the Northwest Quarter (NW 1/4) and the Northwest Quarter (NW 1/4) of the Northeast Quarter (NE 1/4) of Section Twenty-seven (27), Township Seven (7) North, Range Three (3) West of the 4th P.M., Town of Marion, Grant County, Wisconsin, and being described as follows:

Commencing at the North Quarter (N 1/4) corner of said Section;
thence North 89° 59' 39" East 1328.05 feet along the North line of the Northwest Quarter (NW 1/4) of the Northeast Quarter (NE 1/4) to the Northeast corner thereof;
thence South 00° 11' 23" East 752.55 feet along the East line of the Northwest Quarter (NW 1/4) of said Northeast Quarter (NE 1/4);
thence North 89° 59' 58" West 942.78 feet;
thence North 31° 19' 43" West 381.75 feet;
thence South 80° 07' 16" West 341.08 feet;
thence South 70° 09' 15" West 308.37 feet;
thence South 81° 52' 22" West 451.74 feet;
thence South 03° 53' 43" West 797.09 feet;
thence North 51° 55' 25" West 88.96 feet;
thence North 25° 44' 22" West 136.99 feet;
thence North 48° 28' 51" West 213.85 feet;
thence North 78° 06' 16" West 96.57 feet to the West line of the East Half (E 1/2) of the Northwest Quarter (NW 1/4) of said Section;
thence South 00° 13' 35" East 1539.21 feet along said West line to the Southwest corner thereof;
thence South 89° 59' 20" East 1323.31 feet along the South line of the Northwest Quarter (NW 1/4) of said Section to the Southeast corner thereof;
thence North 00° 09' 13" West 1324.09 feet along the East line of the Southeast Quarter (SE 1/4) of the Northwest Quarter (NW 1/4) to the Northeast corner thereof;
thence South 89° 59' 50" East 1328.89 feet along the South line of the Northwest Quarter (NW 1/4) of said Northeast Quarter (NE 1/4) to the Southeast corner thereof;
thence North 00° 11' 23" West 571.74 feet along the East line of the Northwest Quarter (NW 1/4) of said Northeast Quarter (NE 1/4) to the point of beginning.



Aaron J Austin

ALL PLANS THAT DO NOT SHOW A SEAL IMPRINT IN RED INK MAY CONTAIN UNAUTHORIZED ALTERATIONS. THE CERTIFICATION CONTAINED ON THIS DOCUMENT SHALL NOT APPLY TO ANY COPIES. DATED: 6-19-2024.



Prepared for: **JACOB STOLTZFUS**

Austin Surveying, LLC
Land Surveying & Septic System Designs
austinsurveyingllc.com Phone: 608-723-6363
4211 HWY 81 E, LANCASTER, WI 53813

JOB NO: 24S085
H:\CRD\24S085
H:\PLAT\T7NR3W\27\24S085-STOLTZFUS

DRAWN BY: AJ AUSTIN
CREW CHIEF: SHANE AUSTIN
CREW: O. AUSTIN, T. AUSTIN

PLAT OF SURVEY

EASEMENT DESCRIPTION:

A Thirty (30) foot wide access easement for ingress-egress which is located in the Southeast Quarter (SE 1/4) of the Southeast Quarter (SE 1/4) of Section Twenty-two (22) and in the Northeast Quarter (NE 1/4) of the Northwest Quarter (NW 1/4), the Northwest Quarter (NW 1/4) of the Northeast Quarter (NE 1/4), the Northeast Quarter (NE 1/4) of the Northeast Quarter (NE 1/4) of Section Twenty-seven (27), Township Seven (7) North, Range Three (3) West of the 4th P.M., Town of Marion, Grant County, Wisconsin, said easement being located 15 feet on each side of the following described centerline:

Commencing at the Southeast corner of said Section 22;
thence North 00° 19' 27" East 799.51 feet along the East line of said Section 22 to the point of beginning;
thence South 70° 37' 37" West 167.21 feet on a line parallel with and 15 feet Southerly of and perpendicular to that property as described in Document Number 808026, Grant County Registry;
thence South 55° 36' 07" West 140.27 feet along a line parallel with and 15 feet Southerly of and perpendicular to said property;
thence South 37° 42' 42" West 186.97 feet along a line parallel with and 15 feet Southerly of and perpendicular to said property;
thence South 45° 44' 52" West 287.45 feet;
thence 376.01 feet on the arc of a curve to the right having a radius of 3240.00 feet and a long chord bearing South 49° 08' 19" West 375.80 feet;
thence 46.53 feet on the arc of a curve to the right having a radius of 70.00 feet and a long chord bearing South 71° 30' 27" West 45.68 feet;
thence North 89° 26' 54" West 49.46 feet;
thence 94.97 feet on the arc of a curve to the left having a radius of 75.00 feet and a long chord bearing South 54° 16' 30" West 88.75 feet;
thence South 17° 59' 54" West 91.24 feet;
thence 52.68 feet on the arc of a curve to the left having a radius of 155.00 feet and a long chord bearing South 08° 15' 41" West 52.43 feet to REFERENCE POINT "A";
thence 38.80 feet on the arc of a curve to the left having a radius of 155.00 feet and a long chord bearing South 08° 38' 47" East 38.70 feet;
thence South 15° 49' 04" East 129.03 feet;
thence 84.07 feet on the arc of a curve to the right having a radius of 52.00 feet and a long chord bearing South 30° 29' 59" West 75.21 feet;
thence South 76° 49' 01" West 88.40 feet;
thence 170.64 feet on the arc of a curve to the right having a radius of 474.06 feet and a long chord bearing South 87° 07' 46" West 169.72 feet;
thence North 82° 33' 30" West 65.31 feet;
thence 115.41 feet on the arc of a curve to the left having a radius of 225.00 feet and a long chord bearing South 82° 44' 50" West 114.15 feet;
thence South 68° 03' 10" West 84.63 feet;
thence 378.54 feet on the arc of a curve to the right having a radius of 1160.00 feet and a long chord bearing South 77° 24' 06" West 376.87 feet;
thence South 86° 45' 01" West 117.61 feet;
thence 183.76 feet on the arc of a curve to the right having a radius of 512.00 feet and a long chord bearing North 82° 58' 05" West 182.77 feet;
thence North 72° 41' 11" West 158.73 feet;
thence 74.04 feet on the arc of a curve to the right having a radius of 182.00 feet and a long chord bearing North 61° 01' 58" West 73.53 feet to REFERENCE POINT "B";
thence 57.34 feet on the arc of a curve to the right having a radius of 182.00 feet and a long chord bearing North 40° 21' 14" West 57.10 feet;

(CONTINUED ON SHEET 5)

ALL PLANS THAT DO NOT SHOW A SEAL IMPRINT IN RED INK MAY CONTAIN UNAUTHORIZED ALTERATIONS. THE CERTIFICATION CONTAINED ON THIS DOCUMENT SHALL NOT APPLY TO ANY COPIES. DATED: 6-19-2024.

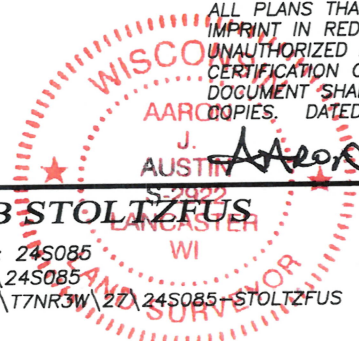

J. Austin
AUSTIN

Prepared for: JACOB STOLTZFUS



Austin Surveying, LLC

Land Surveying & Septic System Designs
austinsurveyingllc.com Phone: 608-723-6363
4211 HWY 81 E, LANCASTER, WI 53813

JOB NO: 24S085
H:\CRD\24S085
H:\PLAT\T7NR3W\27\24S085-STOLTZFUS

DRAWN BY: AJ AUSTIN
CREW CHIEF: SHANE AUSTIN
CREW: O. AUSTIN, T. AUSTIN

PLAT OF SURVEY

(CONTINUED FROM SHEET 4)

thence 46.75 feet on the arc of a curve to the right having a radius of 182.00 feet and a long chord bearing North 23° 58' 10" West 46.62 feet;
 thence North 16° 36' 37" West 18.53 feet;
 thence 86.28 feet on the arc of a curve to the left having a radius of 325.00 feet and a long chord bearing North 24° 12' 55" West 86.02 feet;
 thence North 31° 49' 12" West 44.03 feet;
 thence 122.87 feet on the arc of a curve to the right having a radius of 685.00 feet and a long chord bearing North 26° 40' 53" West 122.71 feet;
 thence North 21° 32' 33" West 87.62 feet to the North line of said Section 27 and the terminus point,

ALSO commencing at Reference Point "A", thence North 78° 32' 22" west 218.11 feet to the terminus point.

ALSO commencing at the above Reference Point "B", thence South 80°07'16" West 100.00 feet to the terminus point;

EASEMENT NOTES:

Other documentation will need to be recorded to clarify the intent, use, maintenance, assignments or other pertinent information of this easement.

SURVEYOR'S CERTIFICATE:

I, Aaron J. Austin, Professional Wisconsin Land Surveyor, hereby certify:

That the descriptions hereon were surveyed, mapped and monumented as shown on this plat by me or under my direct supervision and field work was completed on 6-13-2024.
 That this survey was prepared under the instructions of Jacob Stoltzfus.
 That this survey complies with Chapter A-E 7 of the Wisconsin Administrative Code and to the best of my knowledge and belief, this plat is an accurate representation thereof.
 That all plans that do not show a seal imprint in red ink may contain unauthorized alterations.
 The certification contained on this document shall not apply to any copies.

Dated this 19th day of June, 2024.

Aaron J Austin
 Aaron J. Austin, S-2922
 Agent, Austin Surveying, LLC



Prepared for: JACOB STOLTZFUS



Austin Surveying, LLC
 Land Surveying & Septic System Designs
 austinsurveyingllc.com Phone: 608-723-6363
 4211 HWY 81 E, LANCASTER, WI 53813

JOB NO: 24S085
 H:\CRD\24S085
 H:\PLAT\T7NR3W\27\24S085-STOLTZFUS

DRAWN BY: AJ AUSTIN
 CREW CHIEF: SHANE AUSTIN
 CREW: O. AUSTIN, T. AUSTIN