



# PLAT OF SURVEY

## DESCRIPTION:

Located in the Northwest Quarter (NW 1/4) of the Southeast Quarter (SE 1/4) of Section Thirty-three (33), Township Seven (7) North, Range Two (2) West of the 4th P.M., Town of Hickory Grove, Grant County, Wisconsin, and being described as follows:

Commencing at a 1" rebar marking the South Quarter (S 1/4) corner of said Section 33;  
 thence North 00° 21' 00" West 1615.61 feet along the North-South Quarter (N-S 1/4) line of said Section 33;  
 thence North 89° 39' 00" East 1202.68 feet to a point in the centerline of Level Valley Road and the centerline of an existing driveway, said point being the point of beginning;  
 thence North 06° 49' 22" West 101.00 feet along the centerline of an existing driveway;  
 thence 122.79 feet on the arc of a curve to the left having a radius of 900.00 feet and a long chord bearing North 10° 43' 53" West 122.70 feet along said centerline;  
 thence North 14° 38' 24" West 165.12 feet along an existing centerline;  
 thence 55.17 feet on the arc of a curve to the right having a radius of 850.00 feet and a long chord bearing North 12° 46' 50" West 55.16 feet along said centerline to Reference Point "A";  
 thence 144.03 feet on the arc of a curve to the right having a radius of 850.00 feet and a long chord bearing North 06° 04' 01" West 143.85 feet along said centerline;  
 thence North 74° 52' 16" West 151.11 feet to the East line of a previous survey by Aaron Austin dated 12-7-2023, filed in Book 51, Page 44 of Grant County Surveys and the terminus point;  
 ALSO commencing at the above the Reference Point "A"  
 thence North 67° 24' 54" West 170.87 feet to the East line of a previous survey by Aaron Austin dated 12-7-2023, filed in Book 51, Page 44 of Grant County Surveys and the terminus point.

## EASEMENT NOTES:

Other documentation will need to be recorded to clarify the intent, use, maintenance, assignments or other pertinent information of this easement.

## SURVEYOR'S CERTIFICATE:

I, Aaron J. Austin, Professional Wisconsin Land Surveyor, hereby certify:

That the above description was surveyed and mapped as shown on this map by me or under my direct supervision and field work was completed on 1-7-2024.

That this survey was prepared under the instructions of Brian Northouse.

That this survey complies with Chapter A-E 7 of the Wisconsin Administrative Code and to the best of my knowledge and belief, this plat is an accurate representation thereof.

That all plans that do not show a seal imprint in red ink may contain unauthorized alterations.

The certification contained on this document shall not apply to any copies.

Dated this 9th day of January, 2024.



Aaron J. Austin, S-2922  
 Agent, Austin Surveying, LLC

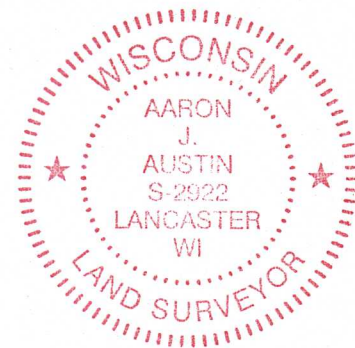

Prepared for: **BRIAN NORTHOUSE**



**Austin Surveying, LLC**

Land Surveying & Septic System Designs  
 austinsurveyingllc.com Phone: 608-723-6363  
 4211 HWY 81 E, LANCASTER, WI 53813

JOB NO: 24S001  
 H:\CRD\23S214  
 H:\PLAT\T7NR2W\33\24S001-NORTHOUSE

DRAWN BY: AJ AUSTIN  
 CREW CHIEF: SHANE AUSTIN  
 CREW: O. AUSTIN, T. AUSTIN

SHEET 2 OF 2