



# PLAT OF SURVEY

**DESCRIPTION PROVIDED:**

Property described in Document Number 838119, Grant County Registry, and being described as follows:

Commencing at the Southwest corner of the N.W.1/4 of the S.W.1/4 of Section 36, T4N, R6W, Grant County, Wisconsin;

thence North 801.02 feet;

thence South 48° 08' East 168.12 feet to a 3/4 inch diameter reinforcing bar and the point of beginning;

thence South 48° 08' East 207.73 feet to a point in the centerline of Grant County Trunk Highway "VV";

thence North 31° 10' East 215.35 feet to a point in said centerline;

thence North 21° 22' East 138.85 feet to a point in said centerline;

thence North 32° 03' East 130.25 feet to a point in said centerline

thence North 67° 04' West 418.95 feet;

thence South 449.03 feet to the point of beginning.

The above described parcel of land being located in the Northwest Quarter (N.W.1/4) of the Southwest Quarter (S.W.1/4) of Section Thirty-six (36), Township Four (4) North, Range Six (6) West, Grant County, Wisconsin.

Commencing at the Southwest corner of the N.W.1/4 of the S.W. 1/4 of Section 36, T4N, R6W, Grant County, Wisconsin;

thence North 801.02 feet to an existing 1 inch diameter iron pipe and the point of beginning;

thence North 518.98 feet to a point in the centerline of Bessie Lane;

thence South 89° 32' East 112.90 feet to a point in said centerline;

thence South 03° 53' East 181.65 feet;

thence South 449.03 feet to a 3/4 inch diameter reinforcing bar;

thence North 48° 08' West 168.12 feet to the point of beginning;

The above described parcel of land being located in the Northwest Quarter (N.W.1/4) of the Southwest Quarter (S.W.1/4) of Section Thirty-six (36), Township Four (4) North, Range Six (6) West of the P.M., Grant County, Wisconsin.

**TRACT BEING SURVEYED AS FOLLOWS:**

Located in the Northwest Quarter (NW 1/4) of the Southwest Quarter (SW 1/4) of Section Thirty-six (36), Township Four (4) North, Range Six (6) West of the 4th P.M., Town of Glen Haven, Grant County, Wisconsin, and being described as follows:

Commencing at a 3/4" rebar marking the West Quarter (W 1/4) corner of said Section, said corner being the point of beginning;

thence South 01° 34' 25" East 518.87 feet along the West line of said Section to a 3/4" rebar marking a corner of that property as described in Document Number 838119;

thence South 48° 11' 07" East 373.68 feet along a line of said property to a 1/2" Steel Cotton Gin Spike;

thence North 29° 56' 58" East 214.18 feet along a line of said property to a 1/2" Steel Cotton Gin Spike;

thence North 20° 08' 58" East 138.10 feet along a line of said property to a 1/2" Steel Cotton Gin Spike;

thence North 30° 49' 58" East 129.54 feet along a line of said property to a 1/2" Steel Cotton Gin Spike;

thence North 67° 32' 00" West 418.95 feet along a line of said property to a 3/4" rebar;

thence North 04° 17' 33" West 181.65 feet along a line of said property to a 1/2" Steel Cotton Gin Spike set

on the East-West Quarter (E-W 1/4) line of said Section 36;

thence North 89° 56' 33" West 112.90 feet along said East-West Quarter (E-W 1/4) line to the point of beginning.

Tract being subject to any and all easements of record and/or usage.

**SURVEYOR'S CERTIFICATE:**

I, Aaron J. Austin, Professional Wisconsin Land Surveyor, hereby certify:

That the above description was surveyed, mapped and monumented as shown on this plat by me or under my direct supervision and field work was completed on 11-30-2023.

That this survey was prepared under the instructions of Kristin Meyers.

That this survey complies with Chapter A-E 7 of the Wisconsin Administrative Code and to the best of my knowledge and belief, this plat is an accurate representation thereof.

That all plans that do not show a seal imprint in red ink may contain unauthorized alterations.

The certification contained on this document shall not apply to any copies.

Dated this 14th day of December, 2023.

Aaron J. Austin  
 Aaron J. Austin, S-2922  
 Agent, Austin Surveying, LLC

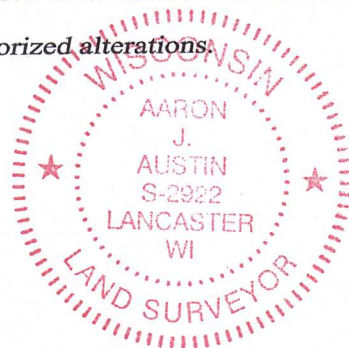

Prepared for: KRISTIN MEYERS



**Austin Surveying, LLC**  
 Land Surveying & Septic System Designs  
 austinsurveyingllc.com Phone: 608-723-6363  
 4211 HWY 81 E, LANCASTER, WI 53813

JOB NO: 23S212  
 H:\CRD\23S212  
 H:\PLAT\T4NR6W\36\23S212-MEYERS

DRAWN BY: AJ AUSTIN  
 CREW CHIEF: SHANE AUSTIN  
 CREW: O. AUSTIN, T. AUSTIN